

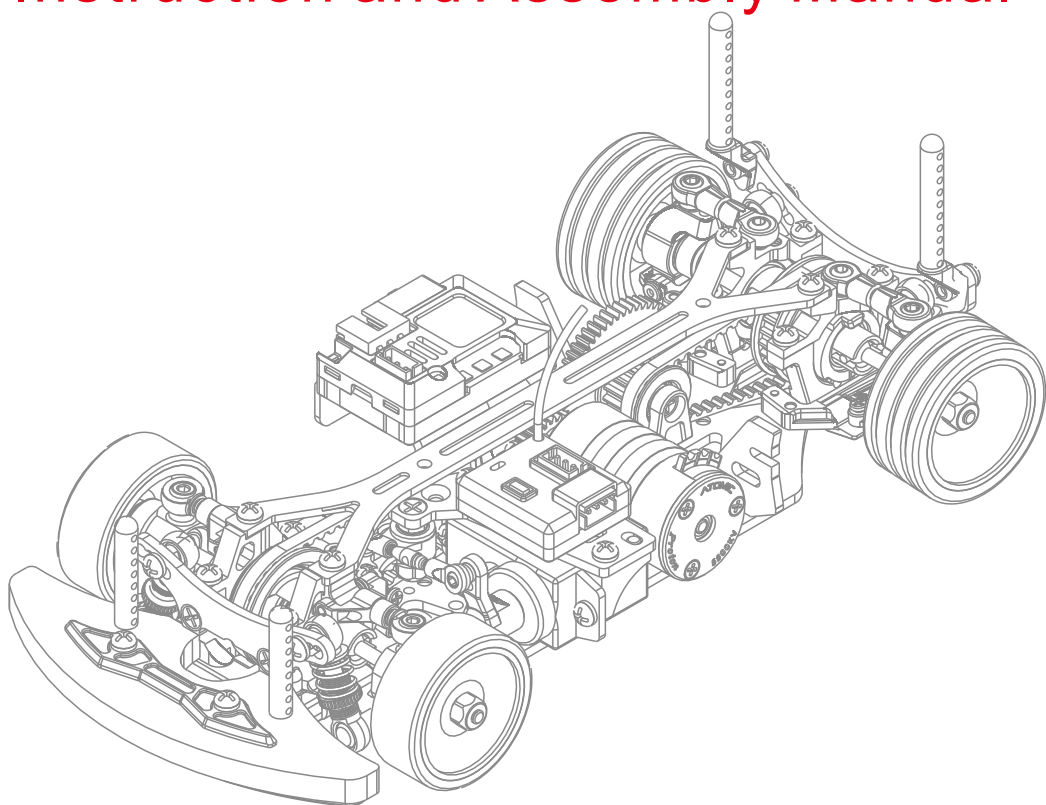

Instruction and Assembly Manual



ATOMIC
RADIO CONTROL RACING EXPERT

Version 1.2 (31 Mar 2017)

Thank you for purchasing this Atomic product. BZ 2017 is a high performance competition machine for 1:28 scale. Please read this manual in detail in order to have proper assembly of this product and wish you have fun with it.

Tools Included :

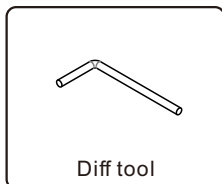
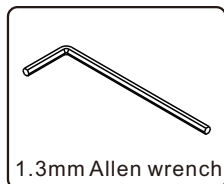

1.3mm Allen wrench

Diff tool

Tools Needed (Not Included) :

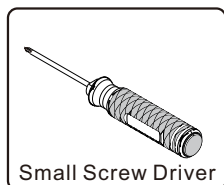

Small Screw Driver

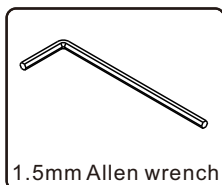

1.5mm Allen wrench

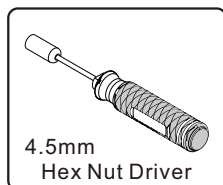

4.5mm
Hex Nut Driver



Hobby Knife

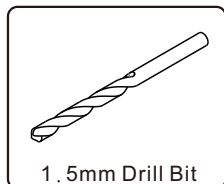

1.5mm Drill Bit

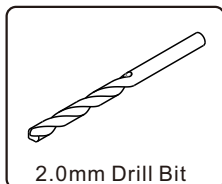

2.0mm Drill Bit

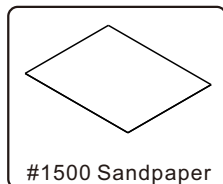

#1500 Sandpaper

Equipment required :

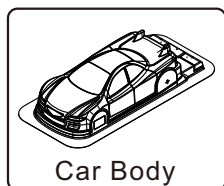

Car Body



Radio System



Ball Diff Oil



Grease

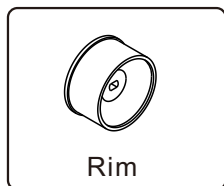

Rim

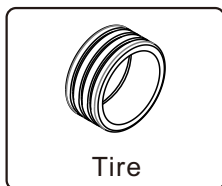

Tire

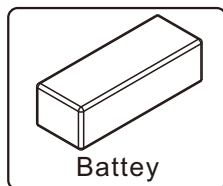

Battey

1

Attaching bulkheads

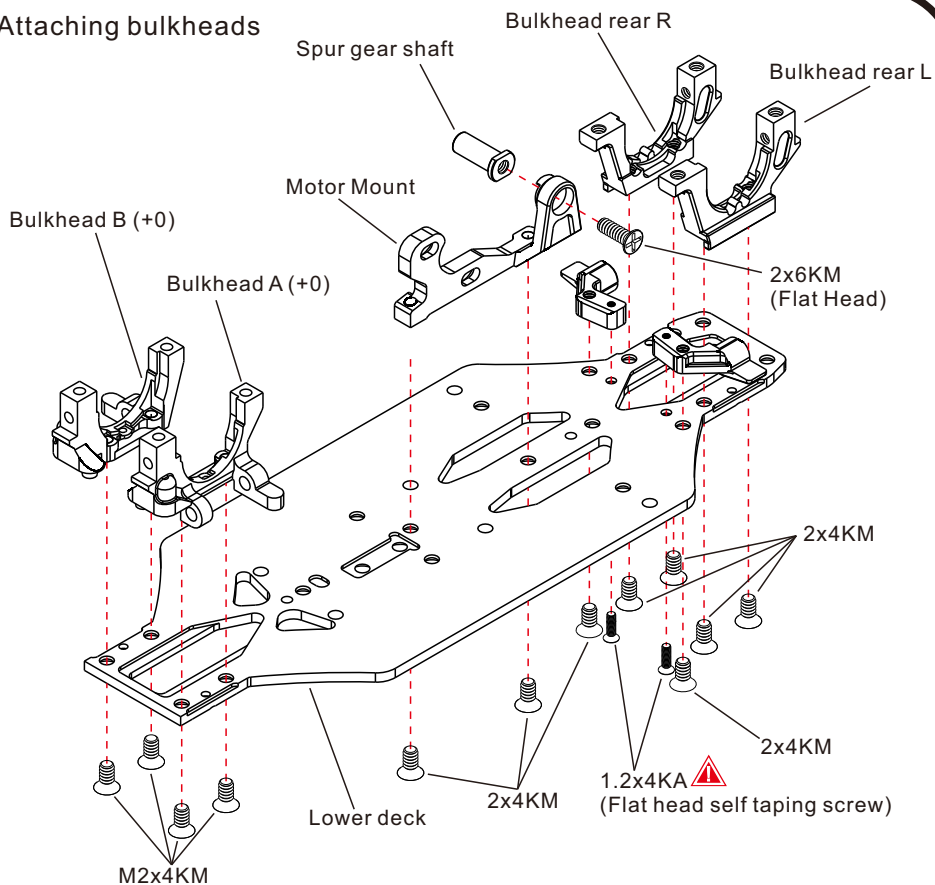

2

Ball differential

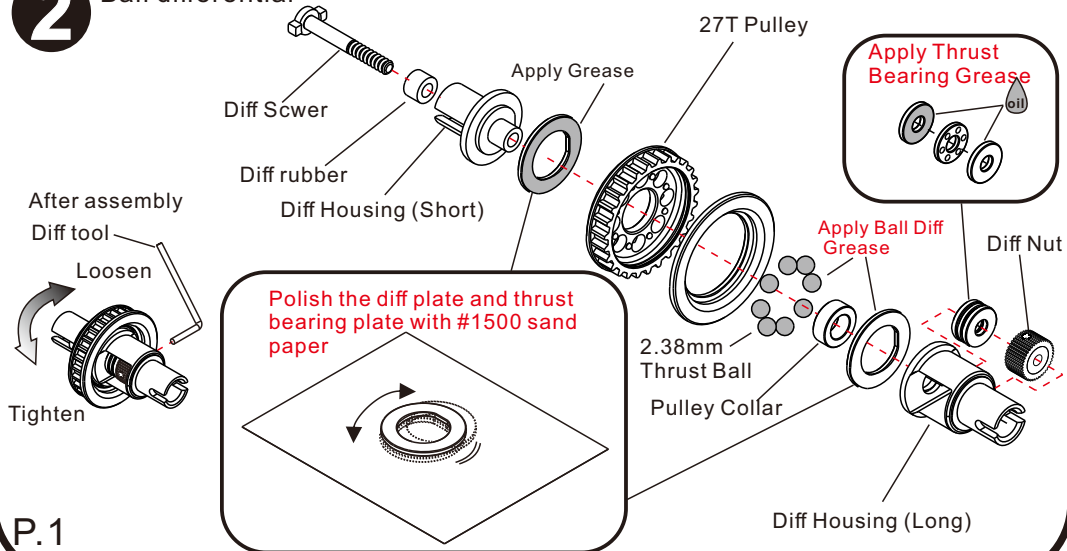

3

Attaching Rear Ball differential & Center Pulley

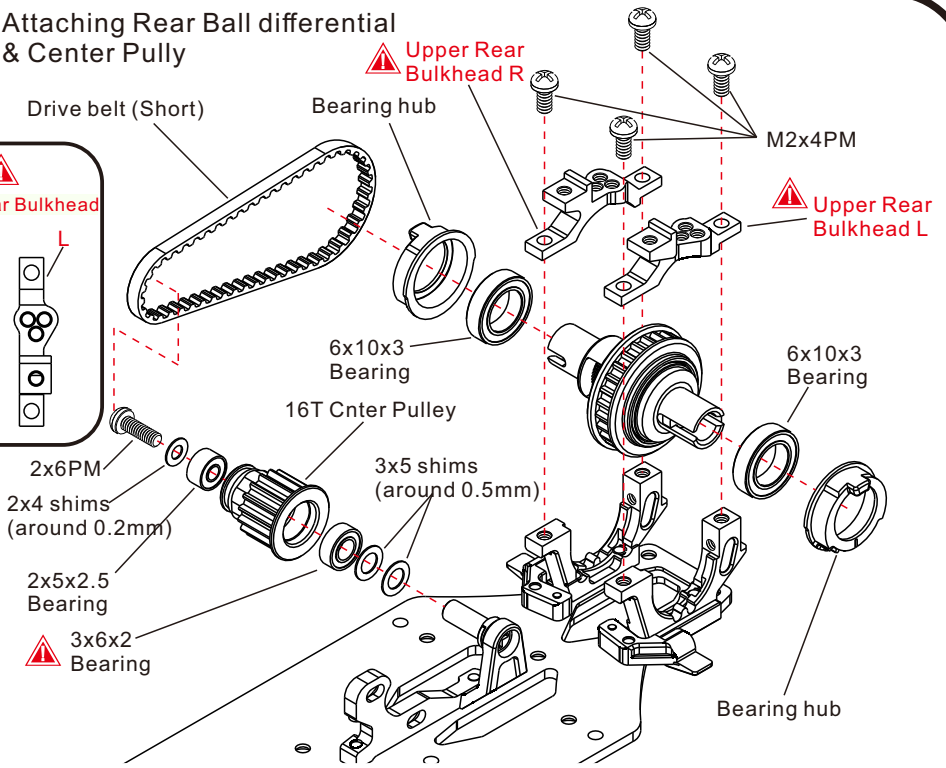
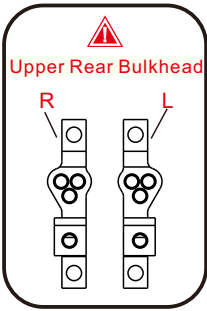

4

Attaching Front Ball differential

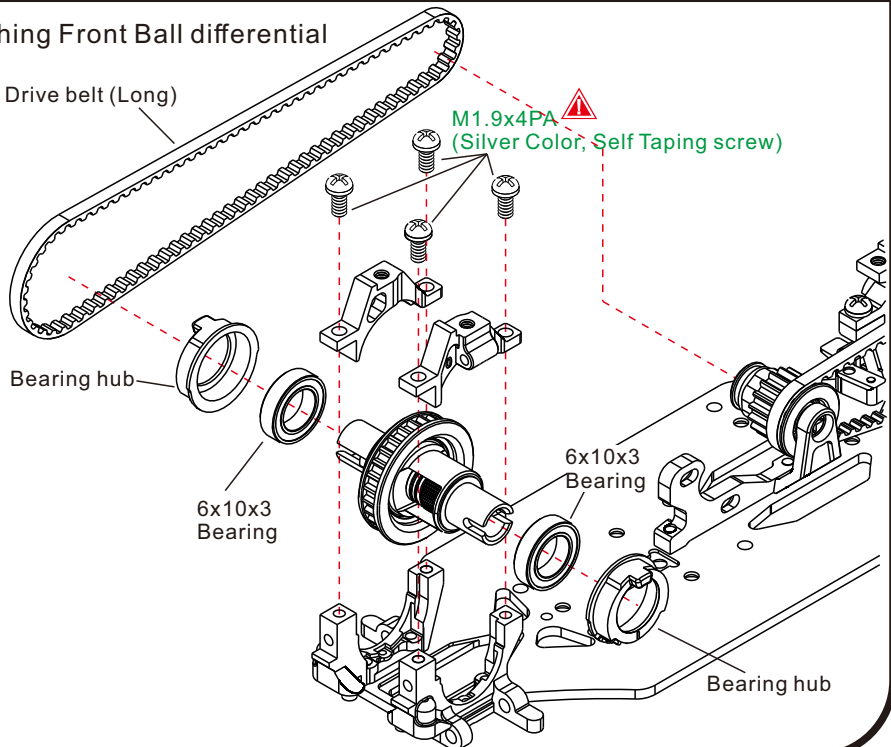

5

Attaching Upper deck

Make sure the carbon top deck can be easily put on the bulk head. otherwise, use sand paper to trim the end of top deck.

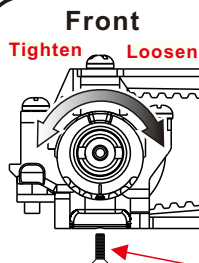
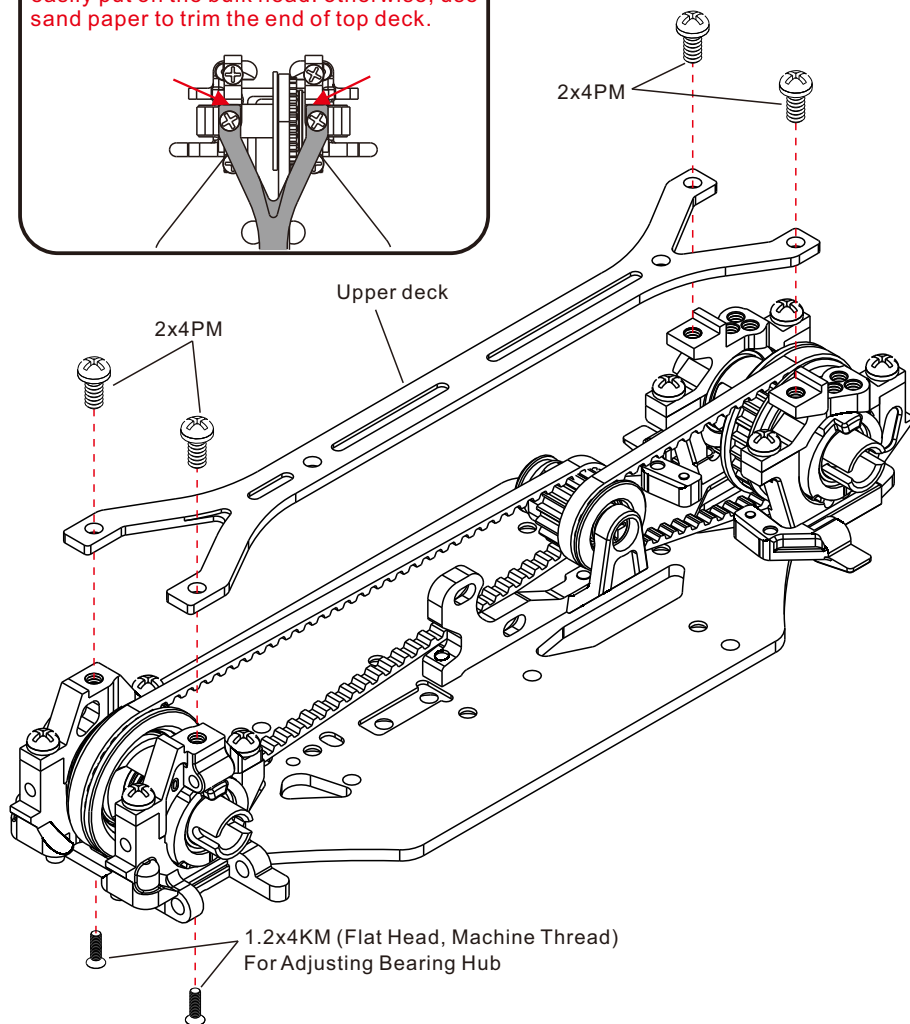
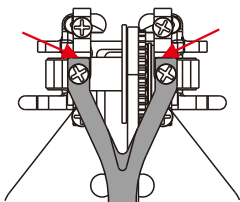

Adjust the bearing hub position to adjust belt tension.
Middle position is recommended.

L / R

Loosen the screw For Adjusting Bearing Hub

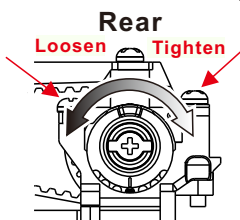

6

Attaching Servo Mount

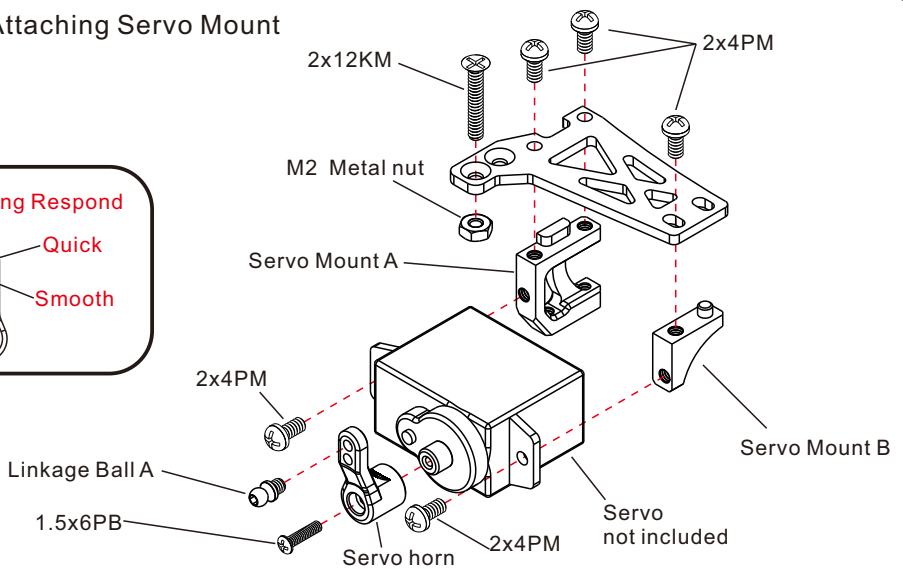
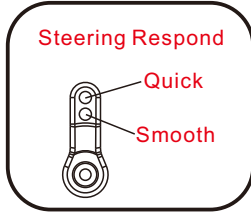

7

Attaching Steering System

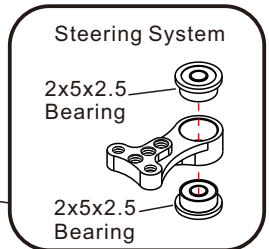
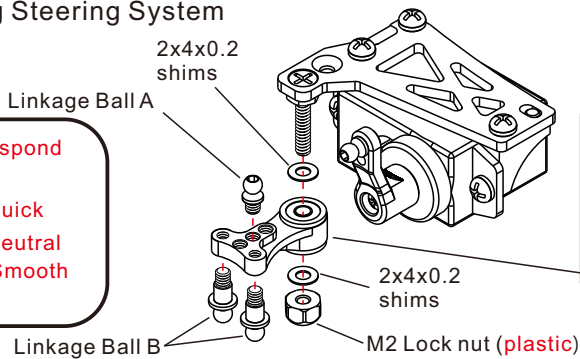
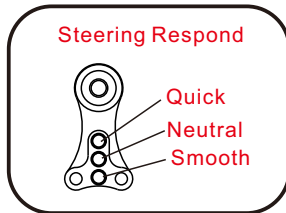

8

Attaching Steering linkage

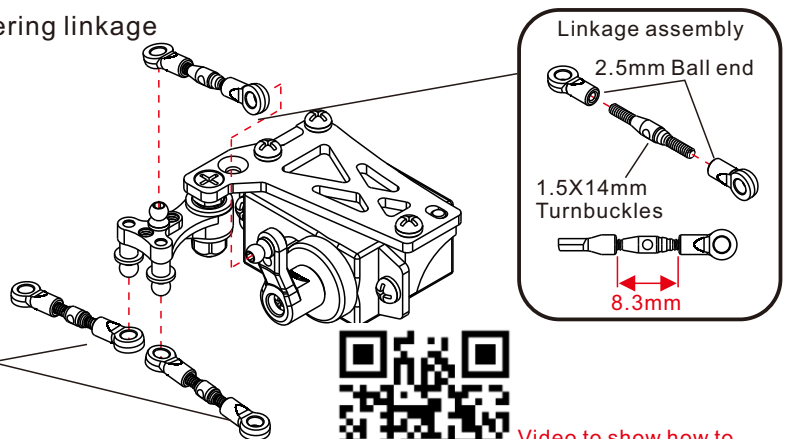
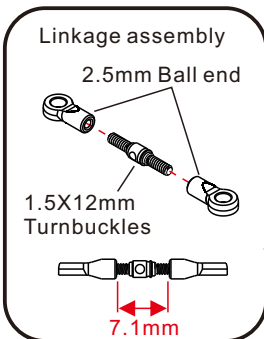

https://youtu.be/RMhkoIUS_og

Servo assembly

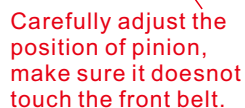

Motor Pinion

(5.56 is recommended for 5500KV motor)

Build 2 Sets

 Long CVD

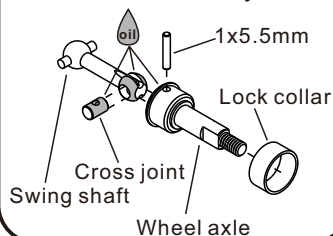

11

Attaching Front arms

L / R

1.5x3x0.7 
shims (plastic)

1.5x11mm

2x12mm

2x12mm

1.5x11mm

Camber Adjustable arm

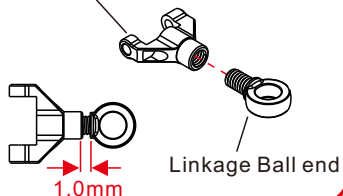

1.4x4KM

Linkage Ball C

1.2x4 PB Droop screw

0.7mm



Video to show how to
smooth ball links please
scan the QR code

https://youtu.be/RMhkoIUS_og

Apply shims (plastic) to setup caster angle:

**** using sand paper to make the shims thinner if the arm is not moving freely.**

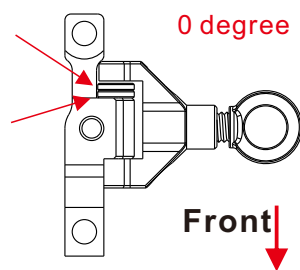
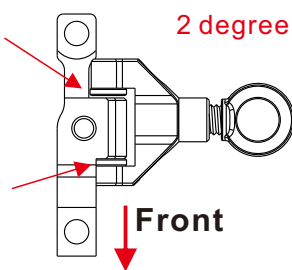
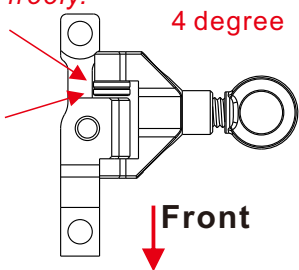

Attention to camber arm direction

12

Attaching Front shocks tower

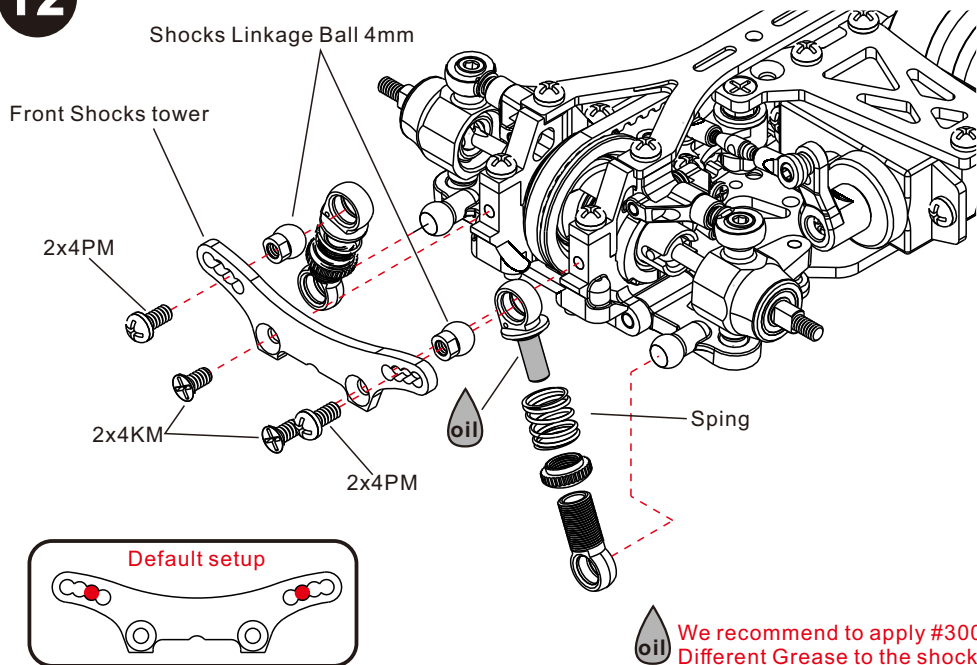

13

Attaching Front Body Mount

⚠ Caution:

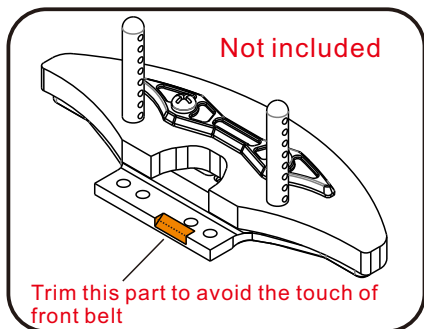

⚠
Front body mount
(Not included)

Body mount cover

2x6KM

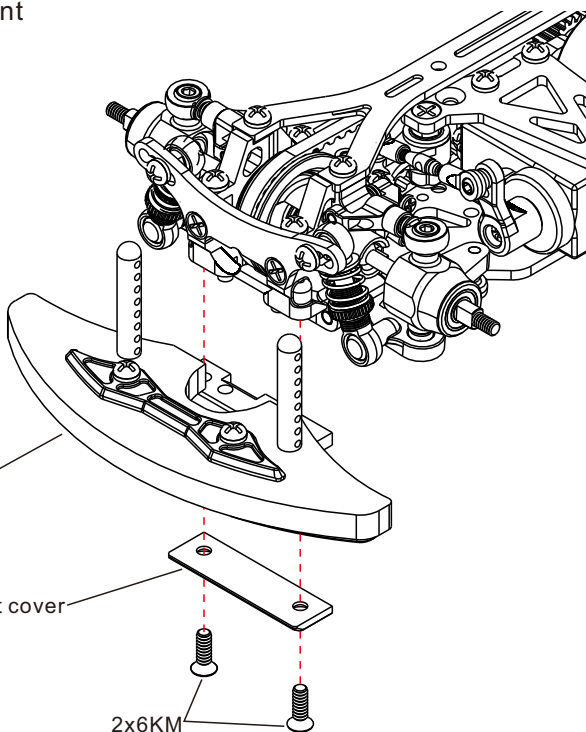

14

Attaching Rear arm

L / R

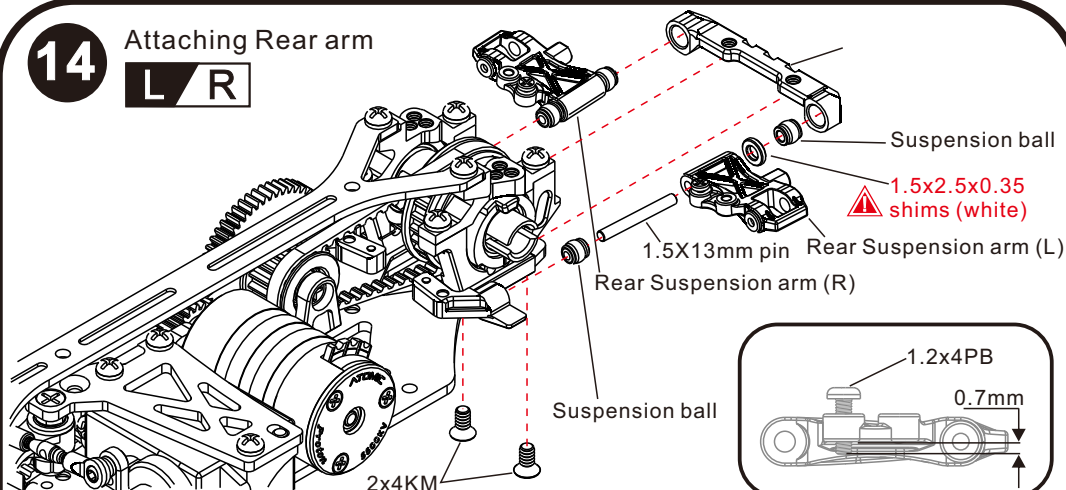

⚠ Rear Toe in mount installation direction

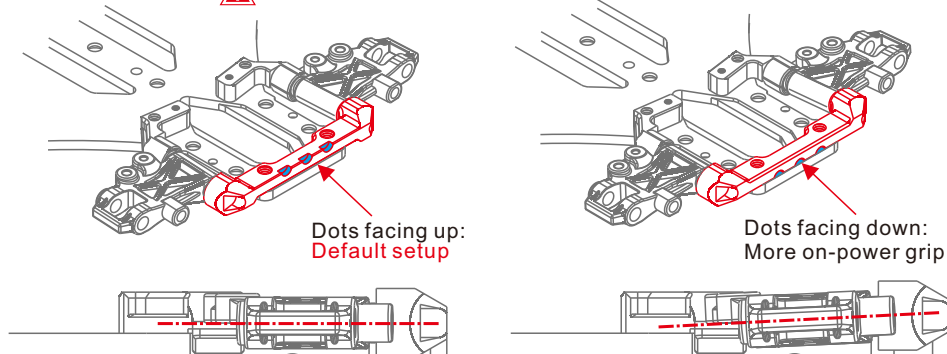

15

Attaching Rear Upright

L / R

Upper Rear Bulkhead

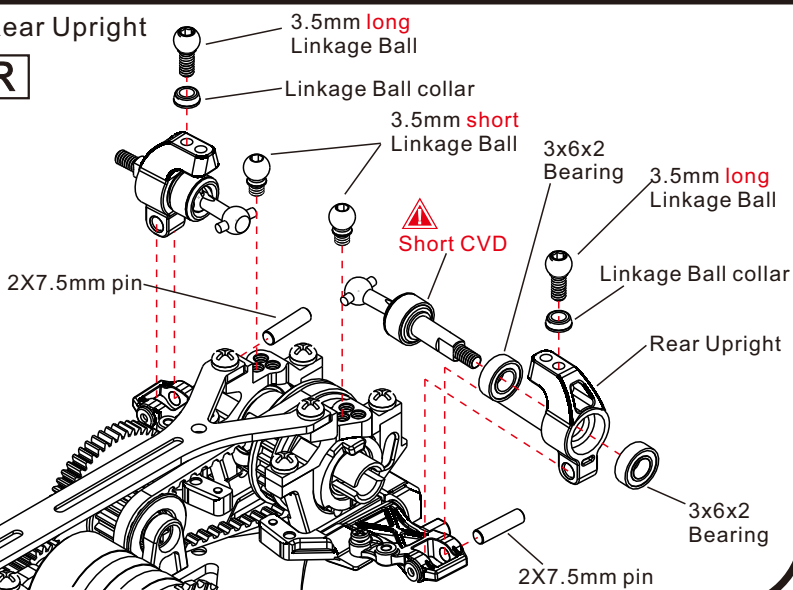
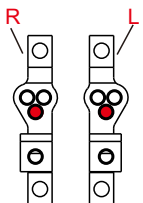

16

Attaching Rear camber linkage

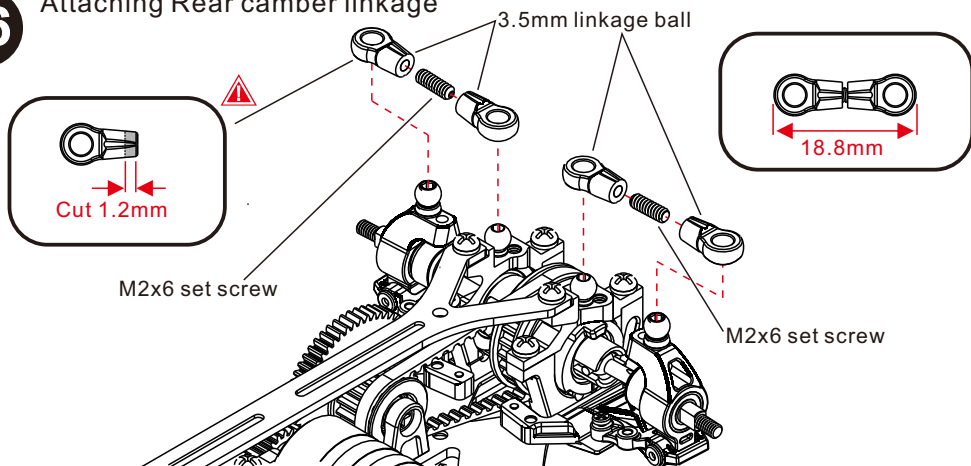

17

Attaching Rear shocks tower

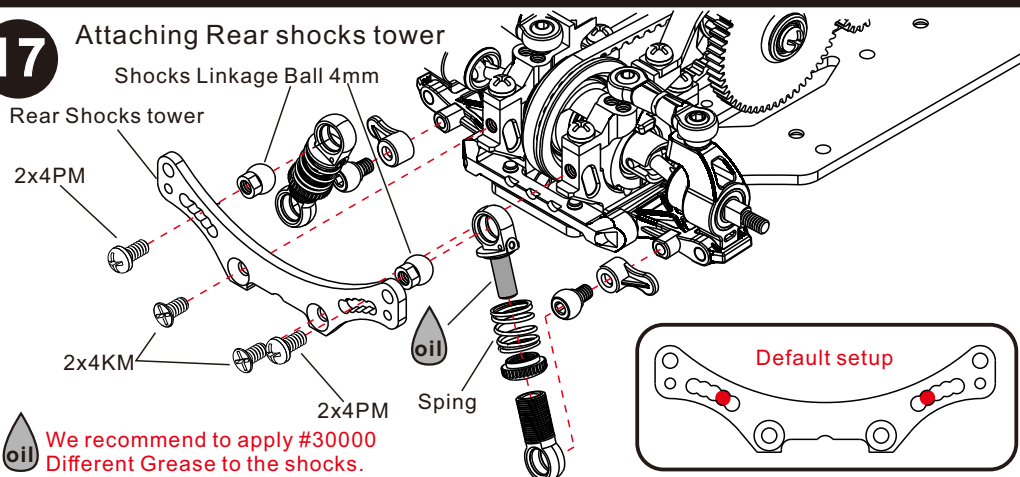

We recommend to apply #30000
Different Grease to the shocks.

18

Attaching Rear body mount

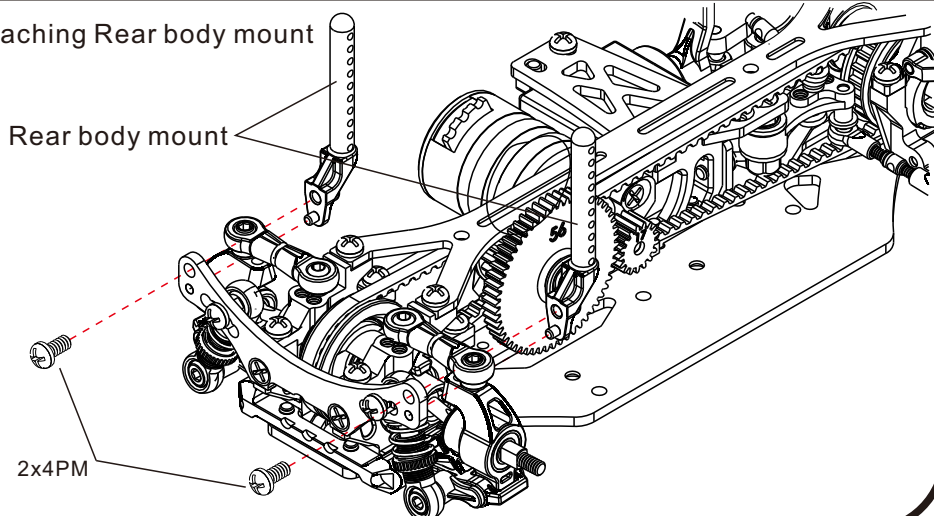

19

Attaching other parts

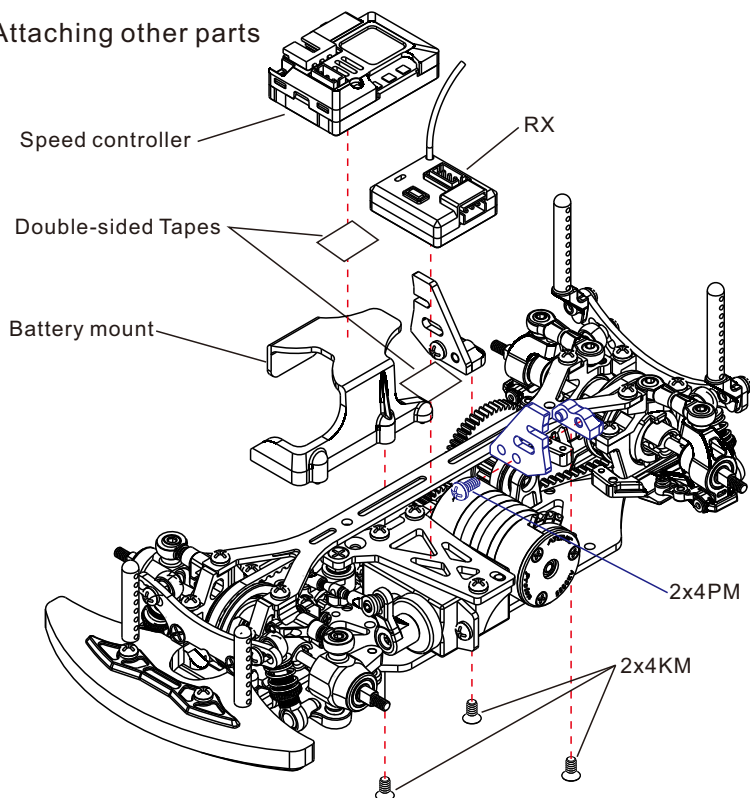

20

Attaching tire & wheel

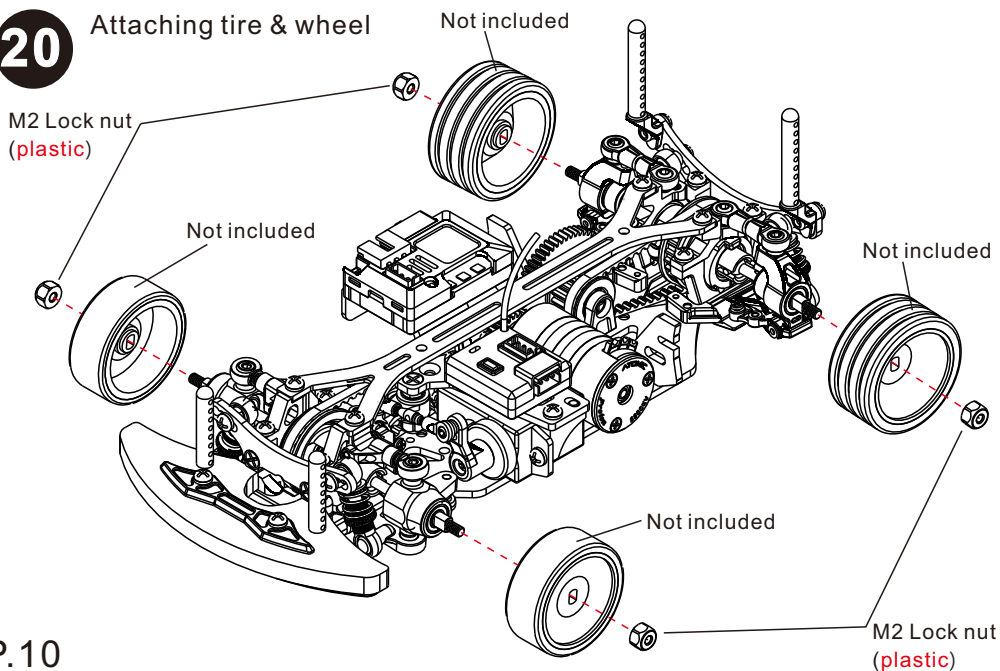

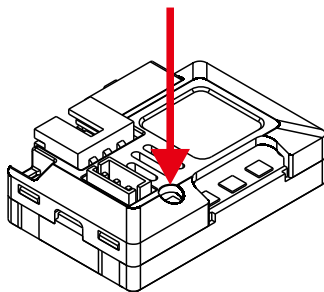
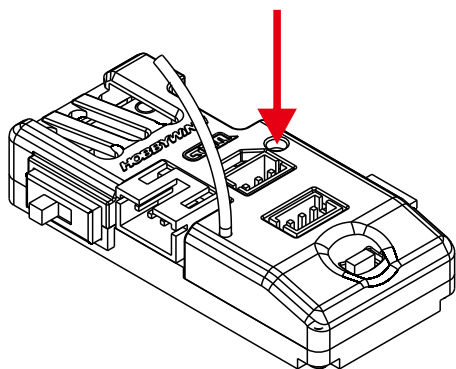

ESC/Radio Calibration:

1. Turn on the transmitter, set parameters on the throttle channel like “D/R”, “EPA” and “ATL” to 100% (for transmitter without LCD, please turn the knob to the maximum) and the throttle “TRIM” to 0 (for transmitter without LCD, please turn the corresponding knob to the neutral position). For Futaba radio transmitter, the direction of throttle channel shall be set to “REV”, while other radio systems shall be set to “NOR”. Please ensure the “ABS braking function” of your transmitter must be DISABLED.

2. Start with transmitter on

3. ESC turned off but connected to a battery.

4. Holding the SET button and turn on the ESC, the RED LED on the ESC starts to flash and then release the SET button immediately.(it is now in setup mode)

3. Steps to Set the neutral point, the full throttle endpoint and the full brake endpoint:

3.1 Leave the throttle trigger at the neutral position, press the SET button, the RED LED dies out and the GREEN LED flashes 1 time.

3.2 Pull the throttle trigger to the full throttle position, press the SET button, the GREEN LED blinks 2 times.

3.3 Push the throttle trigger to the full brake position, press the SET button, the GREEN LED blinks 3 times.

3.4 The motor can be started 3 seconds after the ESC/Radio calibration is complete.



Default Setup sheet

Date: _____ Place: _____ Track: _____
Driver: _____ Best lap: _____ Final position: _____

Body: AMZ-OP011-LTC-2

Wheel Base:

90 / 94 / 98

Motor: Atomic 5500KV

Spur gear: 56T

Pinion gear: 17T

Gear ratio: 5.56

Battery: Atomic 360mAh

Servo: BZ-UP017

Weight: _____

Speed controller

Program card setup

1. Running Mode(1~3) 2
2. Low Voltage Cut-Off(1~6) 5
3. Over-heat protection(1~2) 1
4. Neutral Range(1~3) 2
5. Start Mode (punch)(1~9) 4
6. Max. Forward Force(1~5) 5
7. Max. Reverse Force(1~4) 2
8. Max. Brake Force(1~5) 3
9. Drag Brake Force (1~8) 1
10. Initial Brake Force(1~4) 1
11. Timing(1~8) 6

Note: _____

Front

Shim: 0 mm

Spring: Red

Grease: #30000

Shim: 0 mm

Arm: (N) (W)

2.5 2.0 1.5 1.0 0.5 0 0.5 1.0
DROP GAUGE

Down stop: -1.2 Height: 2.2

Shock Tower:

Upper Bulkhead

(0) / +2.5

Bulkhead

(0) / +2.5

Rear

Shim: 0 mm

Spring: White

Grease: #30000

Spacer: 0

2.5 2.0 1.5 1.0 0.5 0 0.5 1.0 1.5 2.0 2.5
DROP GAUGE

Spacer: 0 Down stop: -0.5 Height: 2.3

Shim: 0 mm

Shock Tower:

toe in mount: 3 Dot Camber: F 1.5 / R 1.5 Caster: 4 degree

installation hole:

toe :
in / out 0.5

Ball Diff

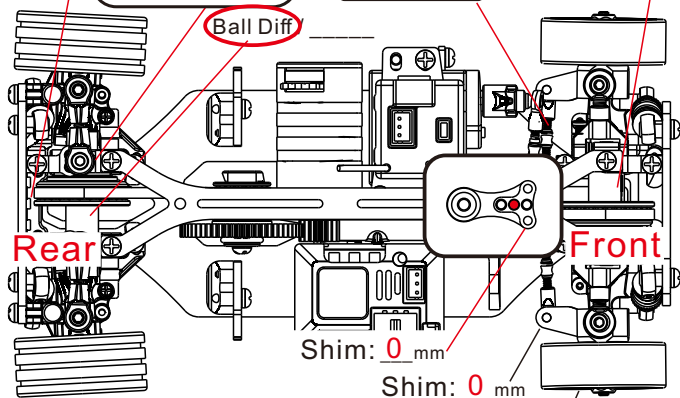

Rear

Front

Shim: 0 mm

Shim: 0 mm

Wheel offset: W2.5

Tire: _____

Wheel offset: N1.0

Tire: _____

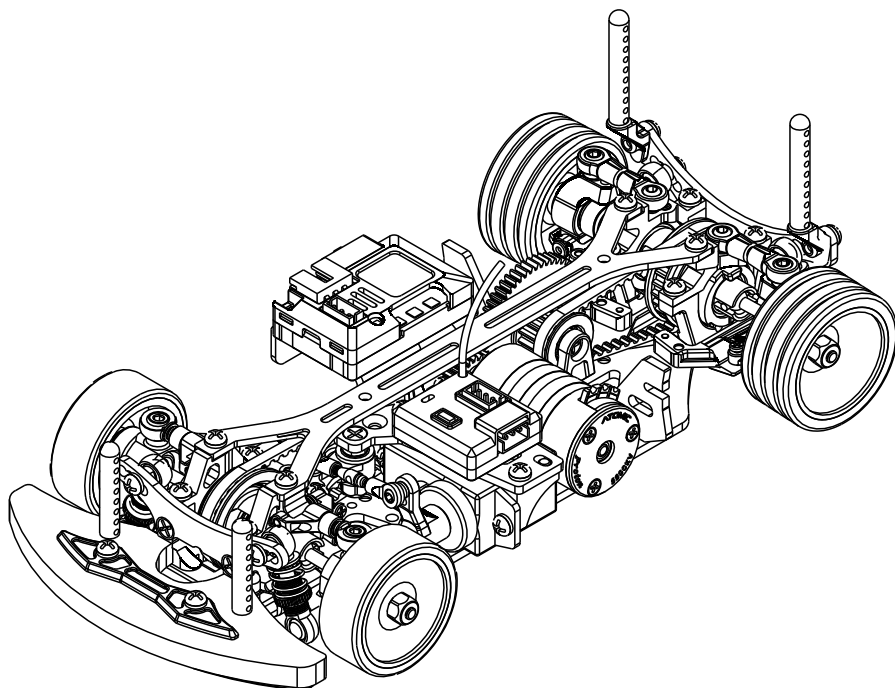

End of Assembly

ATOMIC
RADIO CONTROL RACING EXPERT

www.rcatomic.com