

MRZ-EX

MRZ-EX Assembly Manual

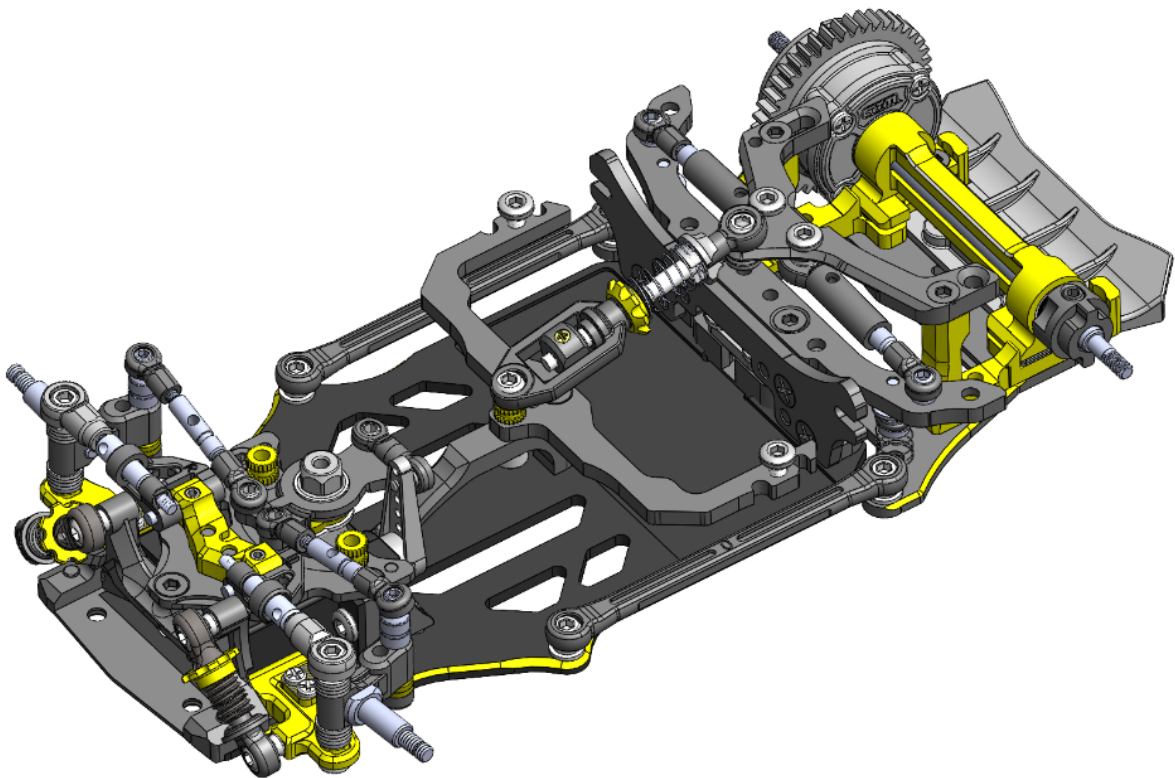

01 Chassis Center Pivot (open Bag 1 to 5)

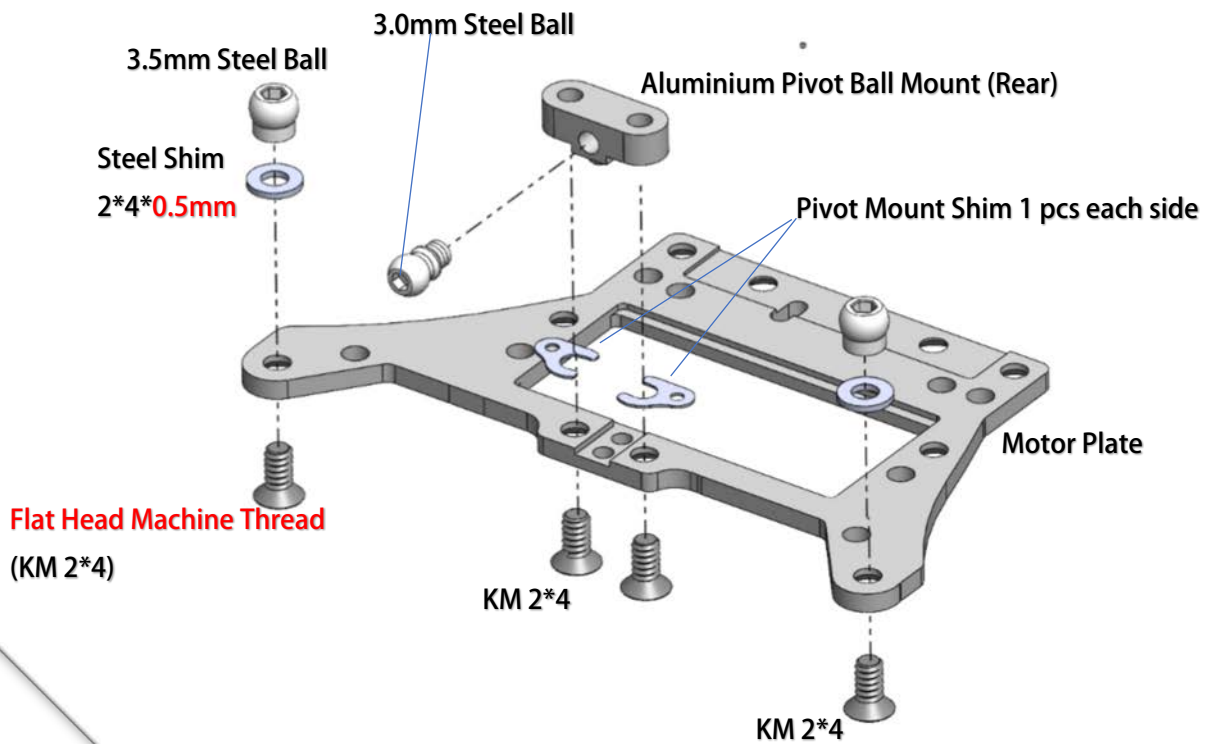

02 Chassis Center Pivot

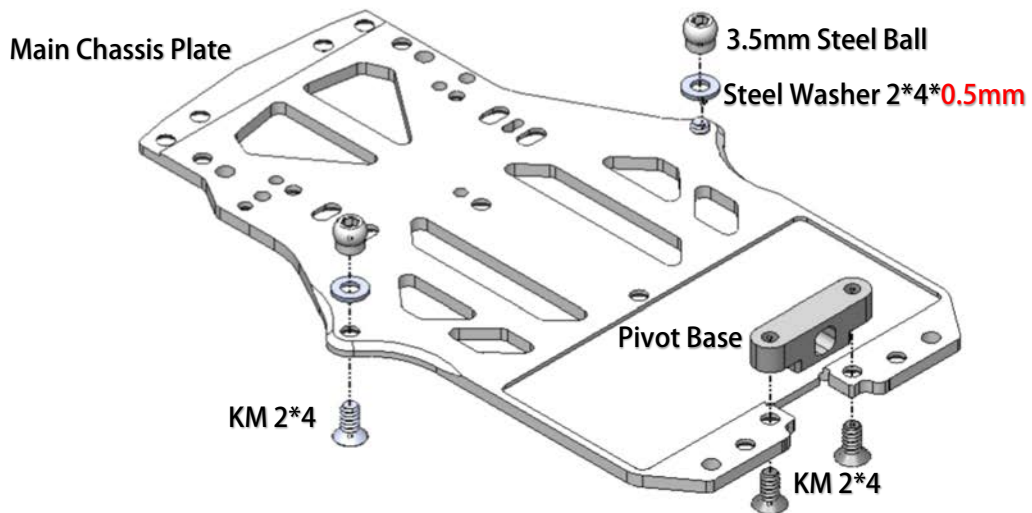

03 Side Links System

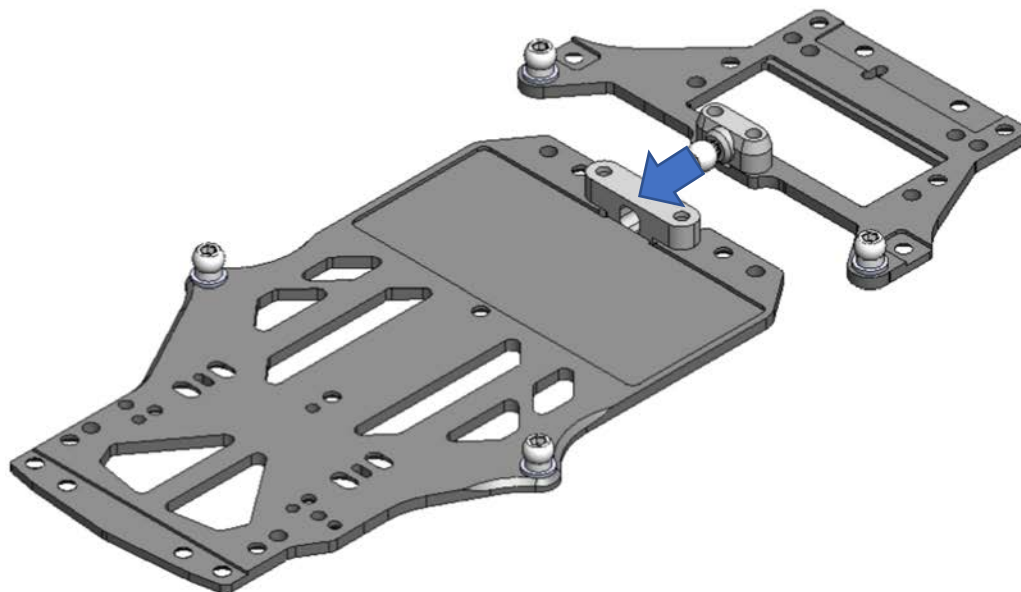

04 Fixing Side Links

YouTube video to show how to smooth and free up ball cap; please scan the QR code.

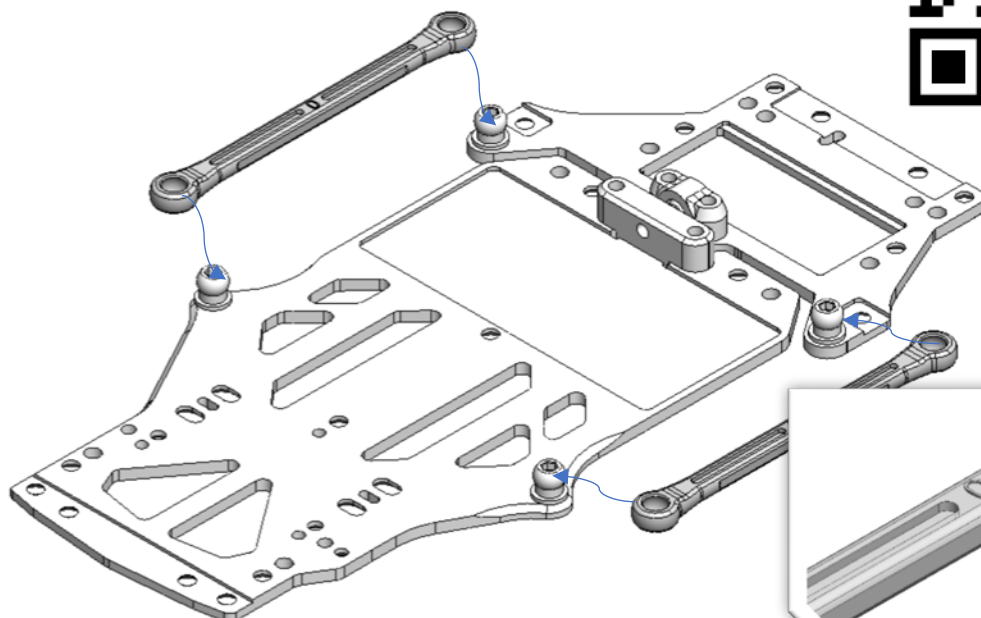

Number facing upward.

05 Side Body Mount (open Bag 06)

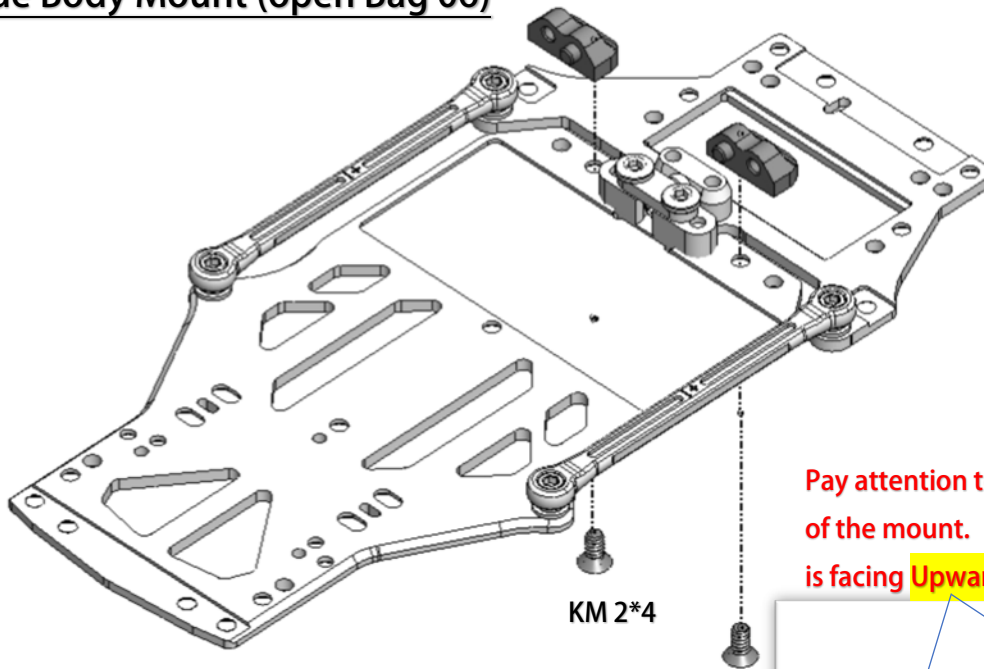

Pay attention to the orientation of the mount. "Wave shape" is facing **Upward**.



06 Car Body Mount Plate

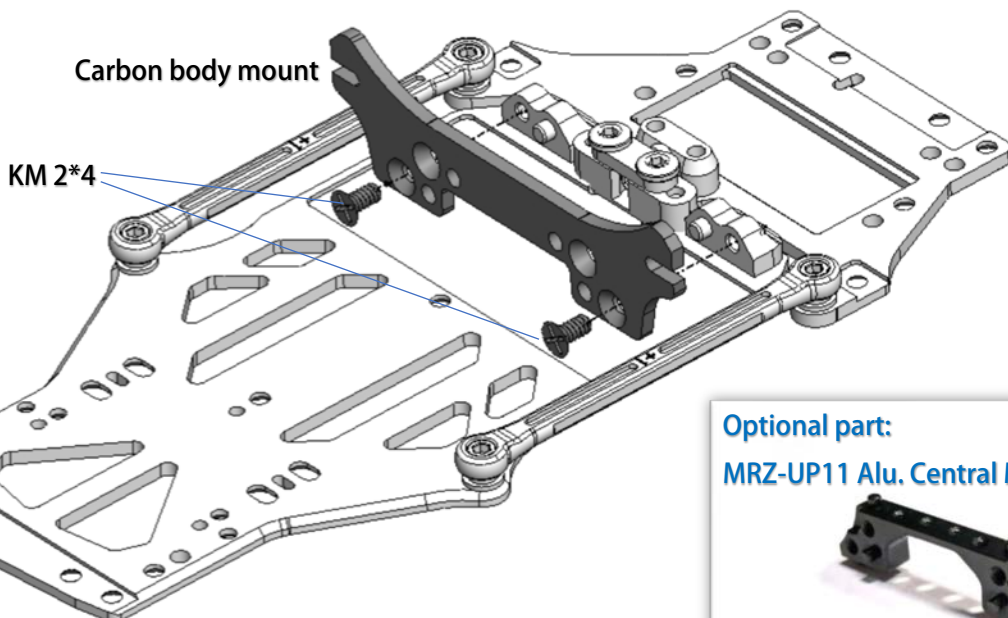

Optional part:
MRZ-UP11 Alu. Central Mount



MRZ
TOMIC

07 Car Body Mount Plate

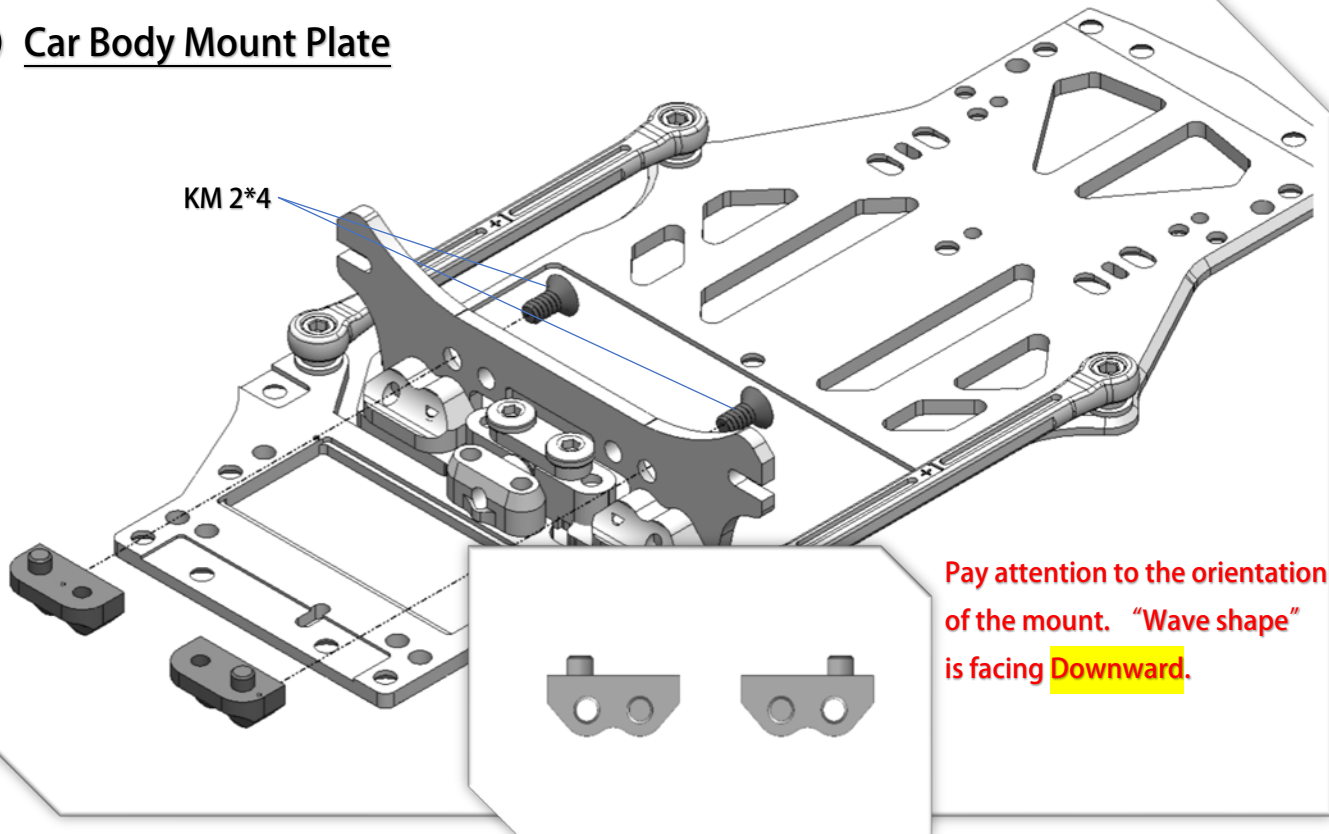

08 Motor Pod

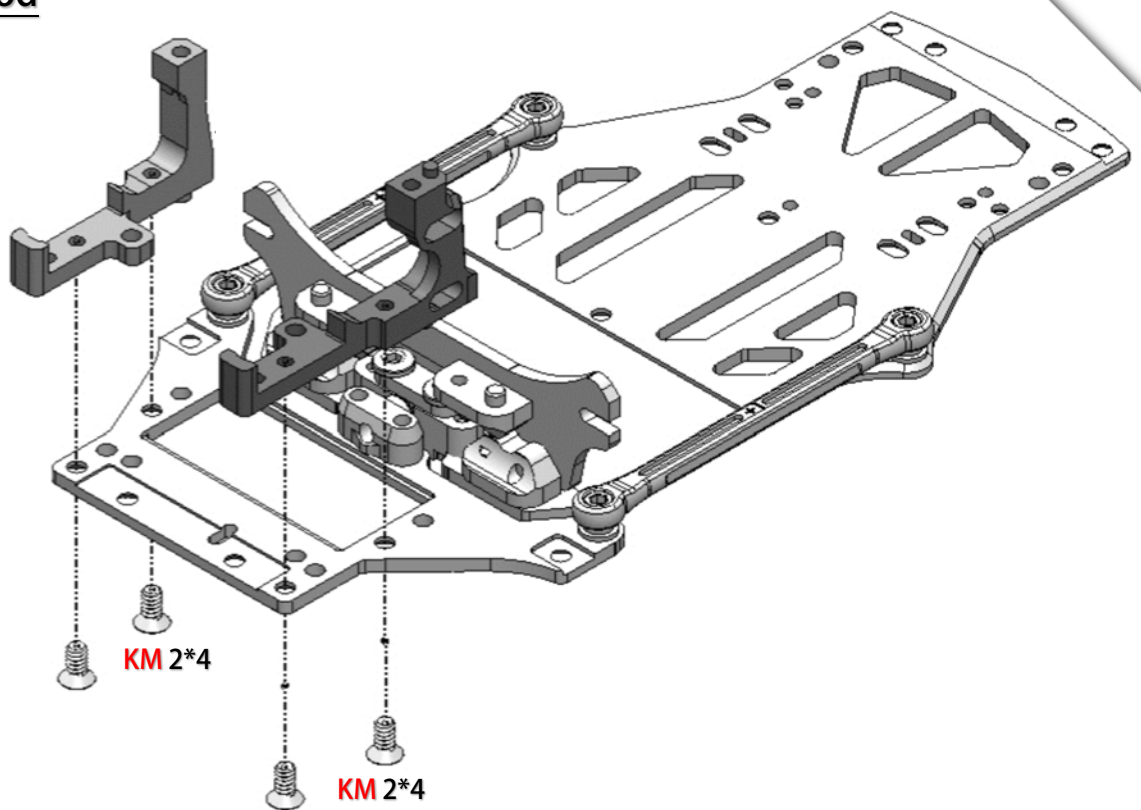

09 Ride Height Spacers

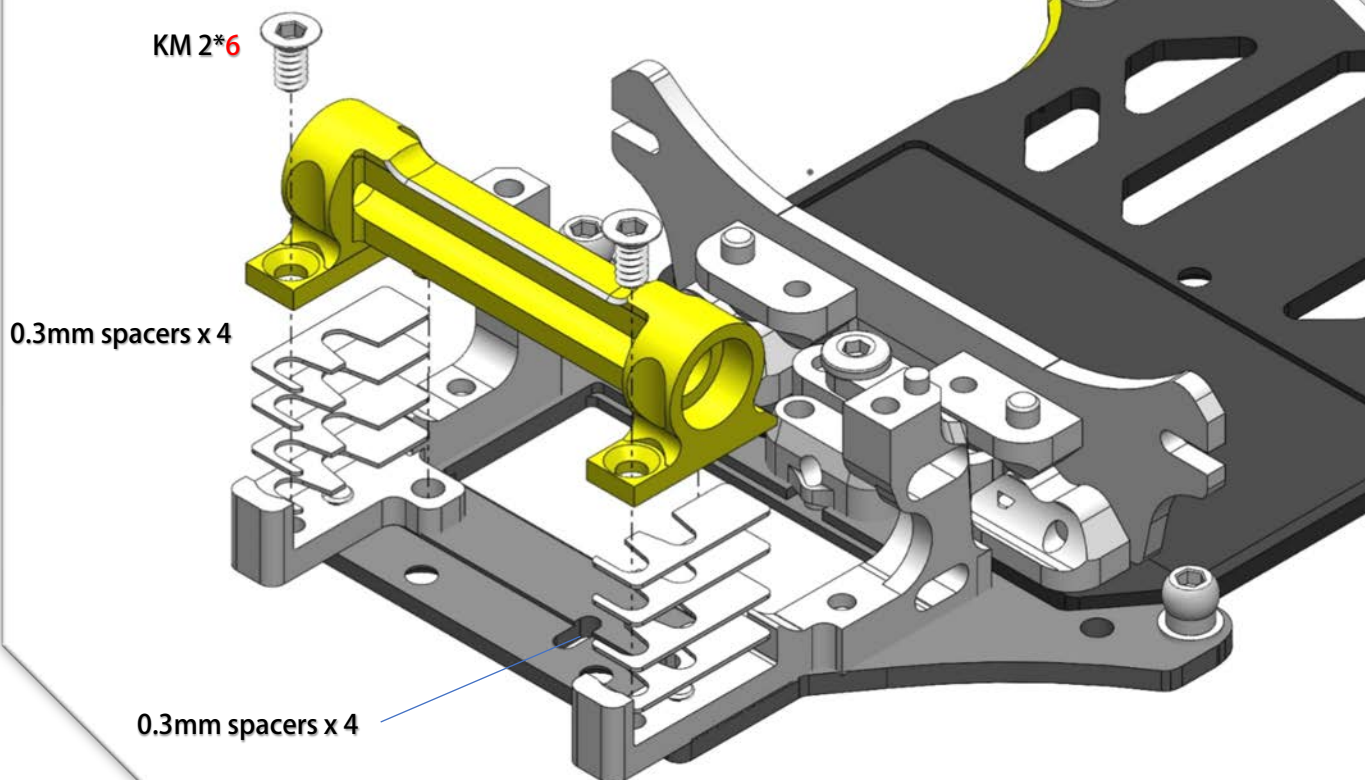

10 Side Spring Hub (open Bag 08)

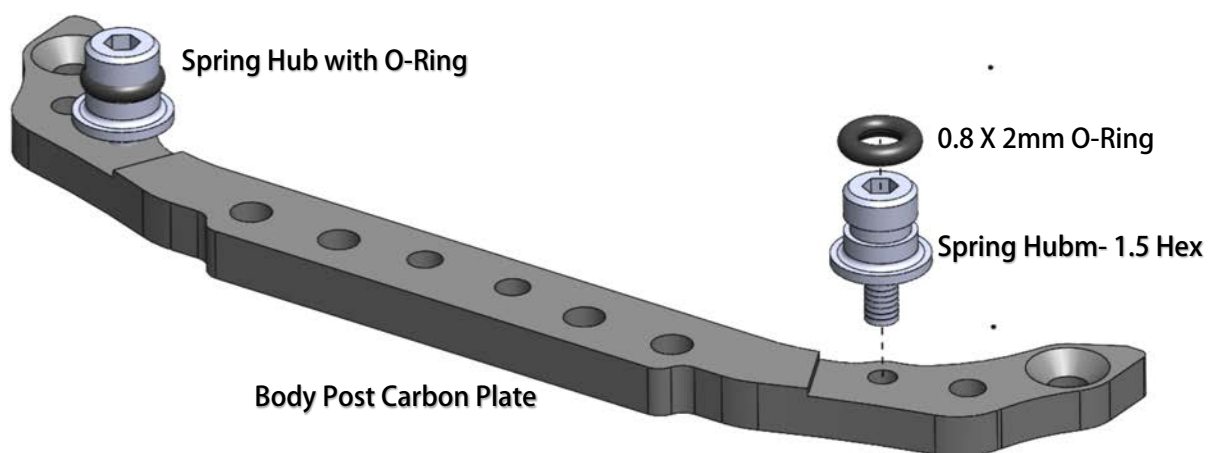

⑪ Side Spring

Put on the Spring and the O-Ring will keep it in place.

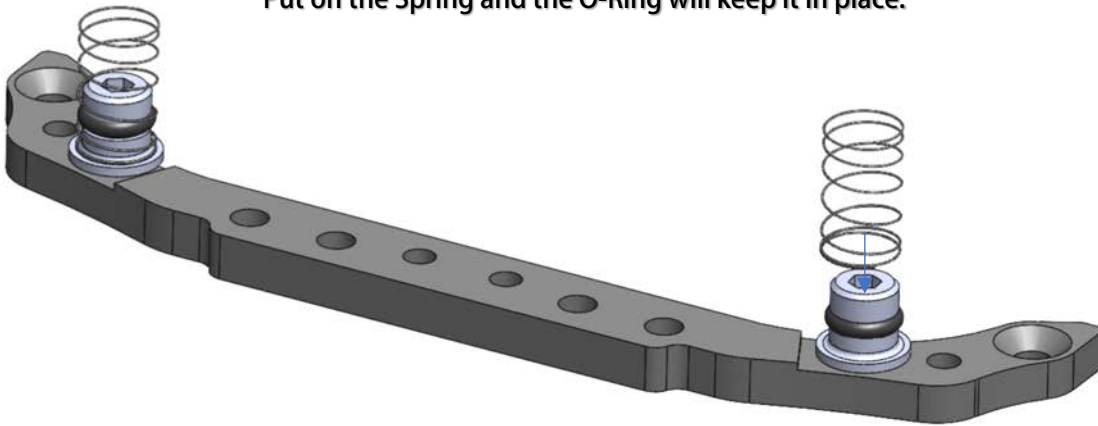

⑫ Body Post Plate

2.5 mm Ball Head- M2 Thread

KM 2*6

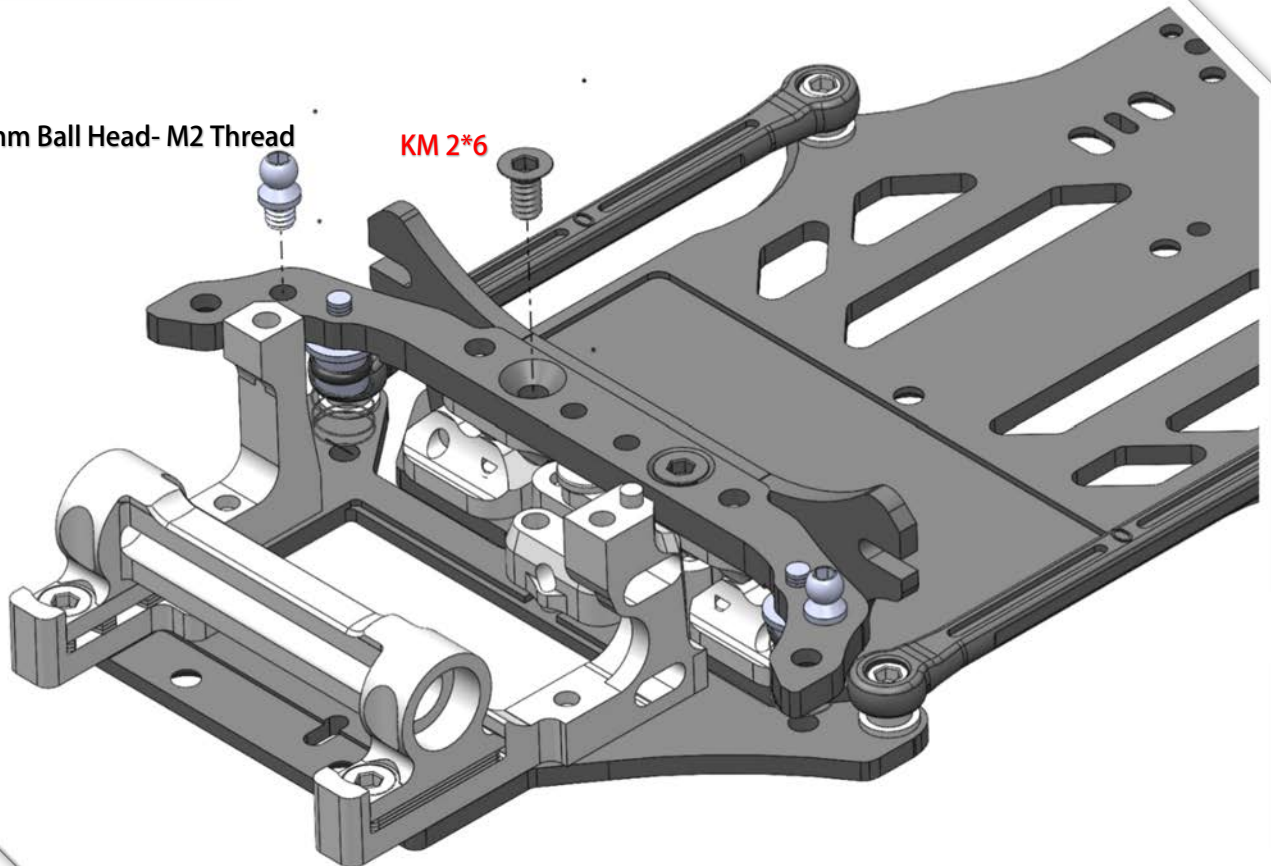

13 Middle Chassis Support and Battery Mount

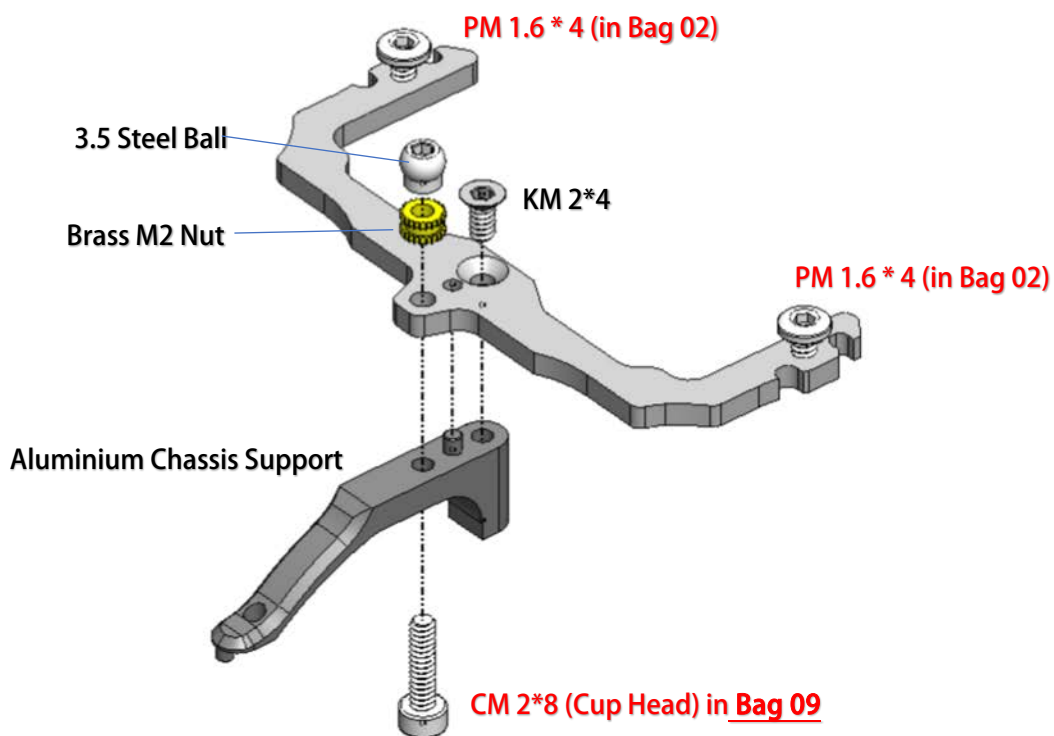

14 Fix Battery Mount

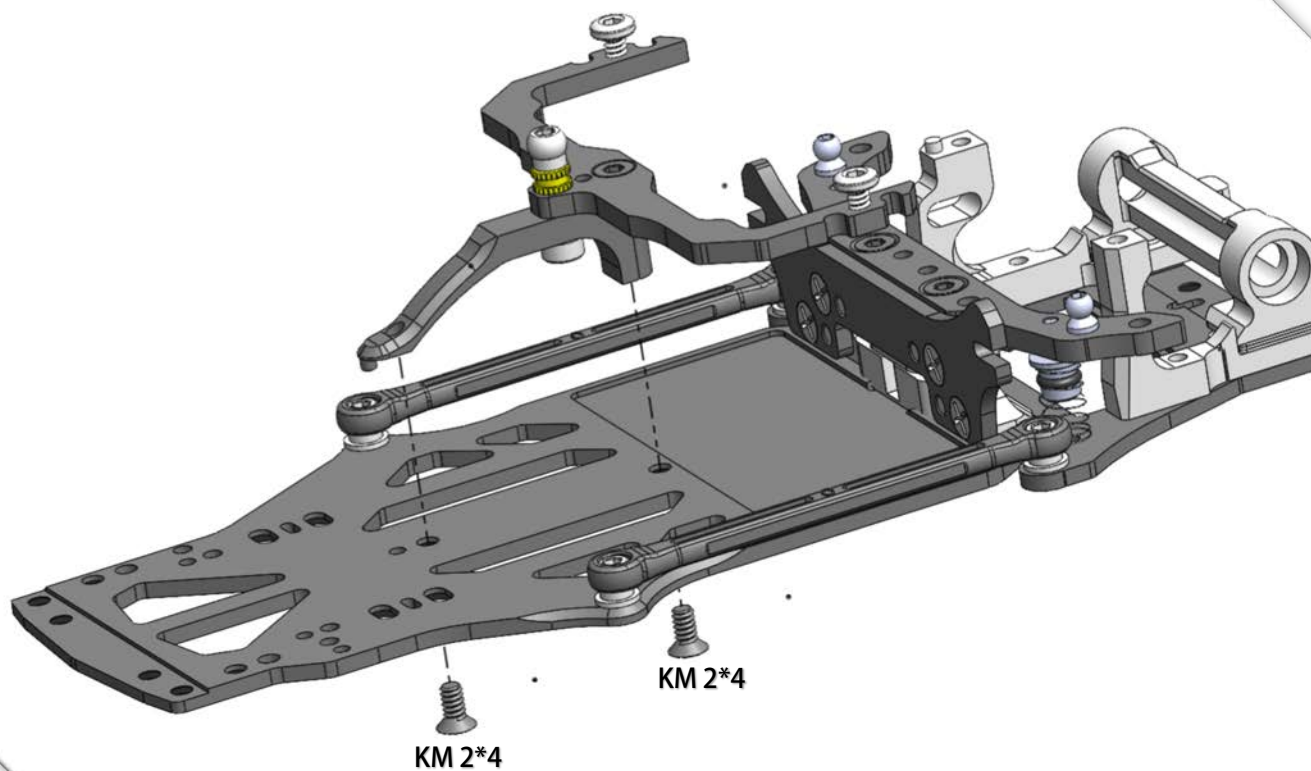

17 Lateral Shock Dampers (Bag 07)

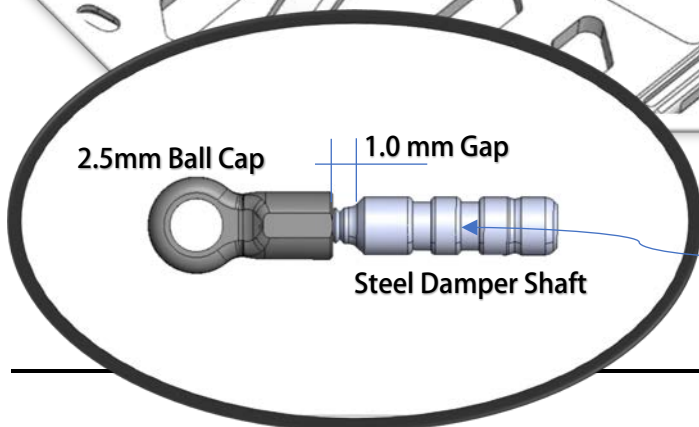
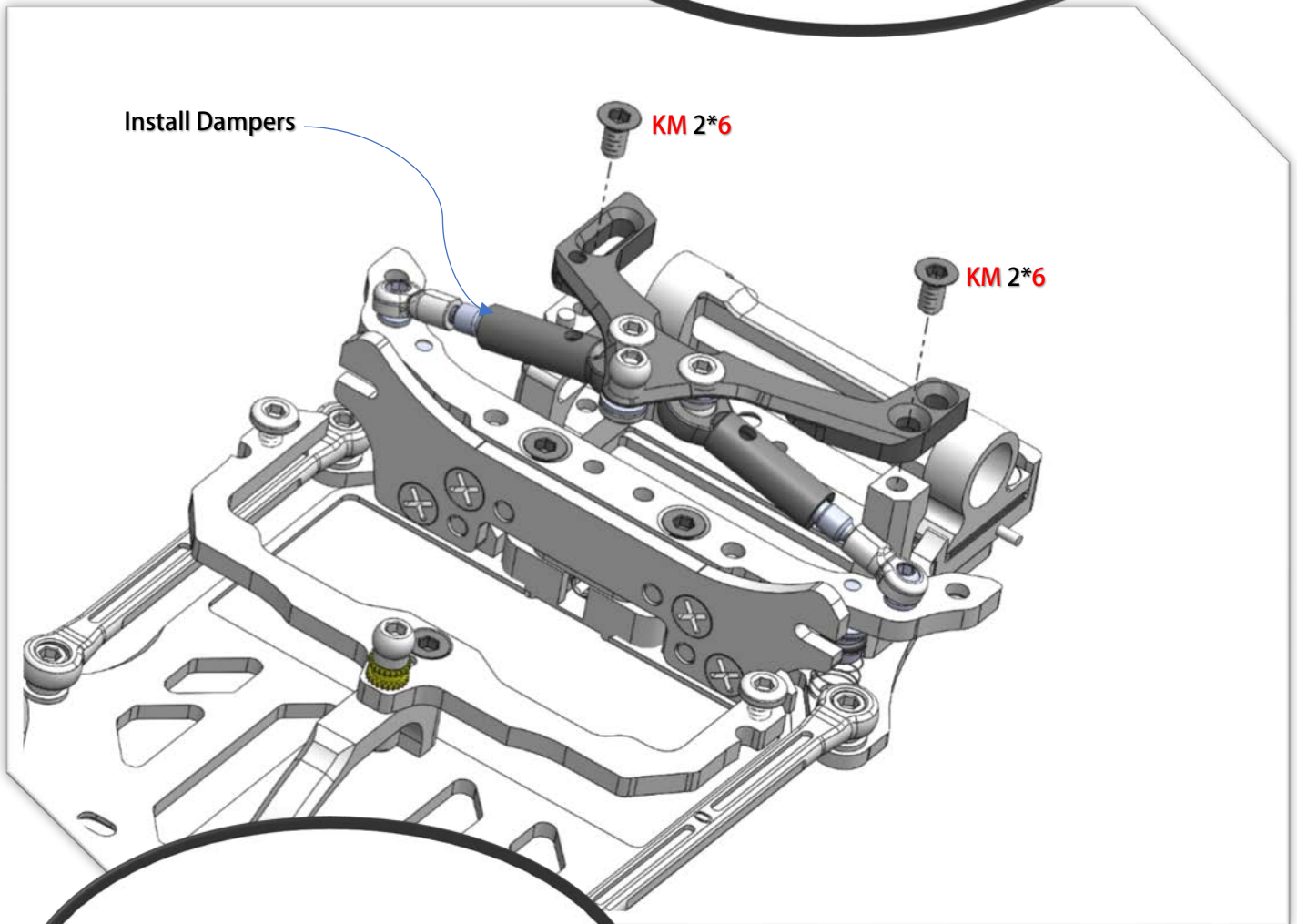
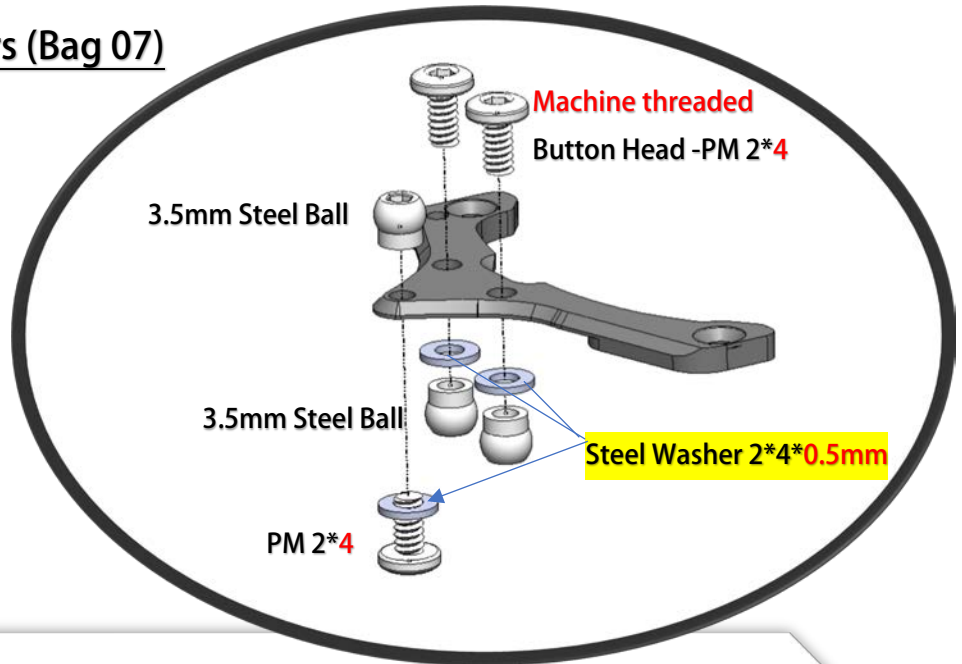

18 Center Shock Damper

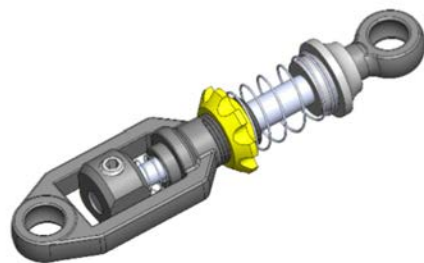
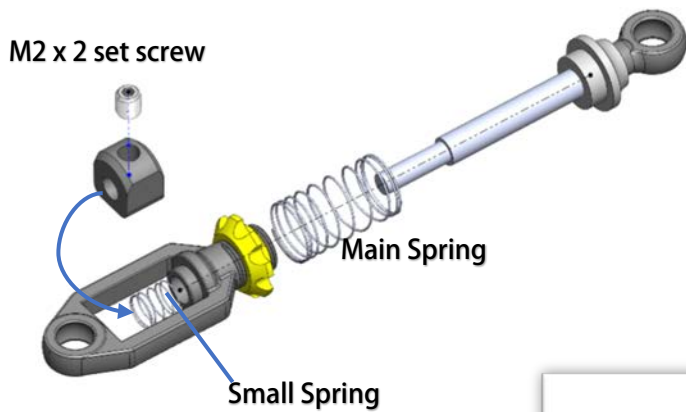
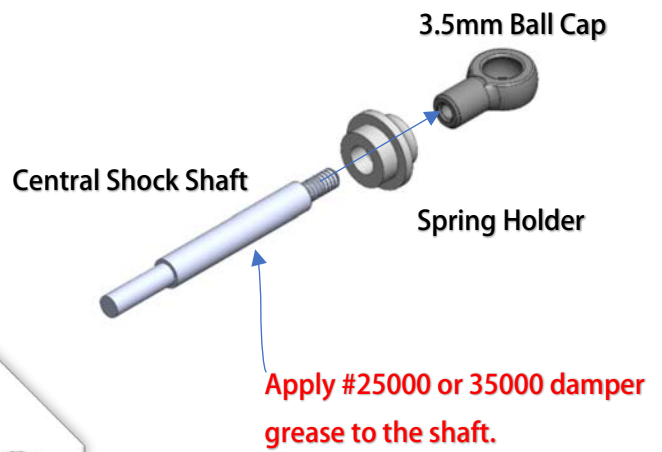
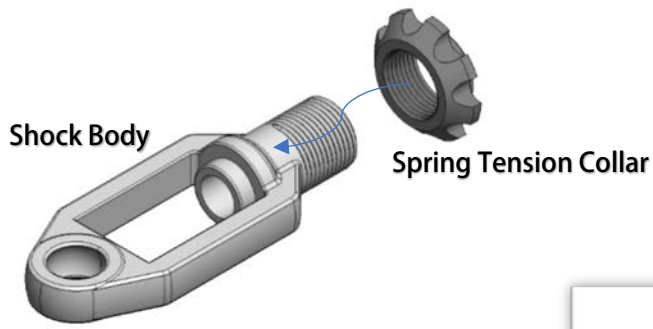

19 Center Shock Damper

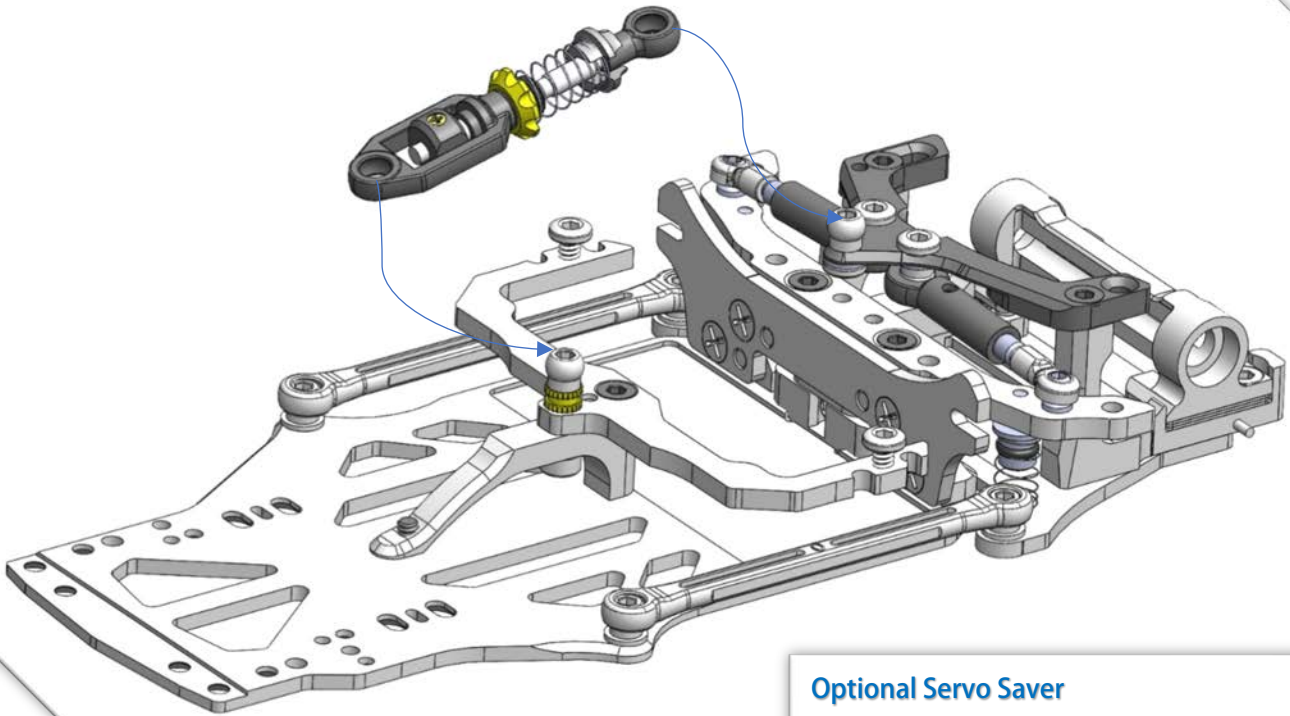

Optional Servo Saver
MRZ-UP01-V2

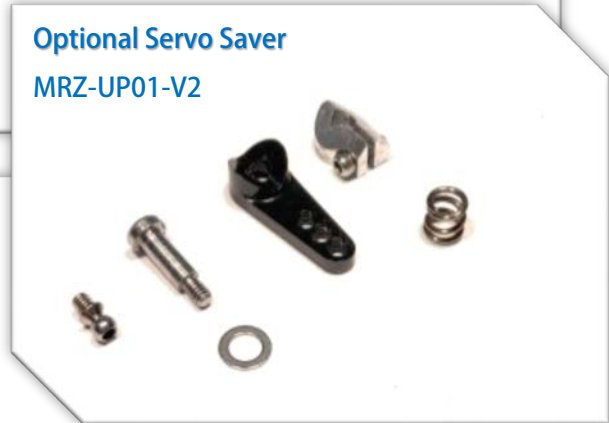

20 Servo Horn

Servo (not included)

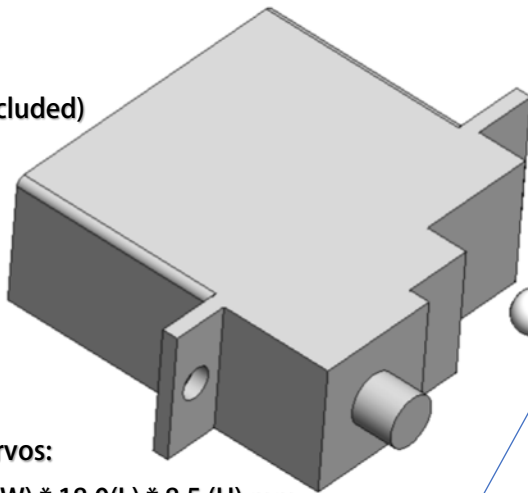

MRZ suitable servos:
size within 20.0(W) * 18.0(L) * 8.5 (H) mm

2.5mm Steel Ball Head, M1.4 thread

**** The Top Hole is recommended.**

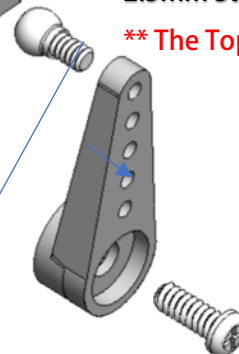

You may need to install the 2.5 ball on the other side of the horn, depends on which type of horn you have. We highly recommend getting the optional servo saver.

21 Servo Installation (open Bag 09)

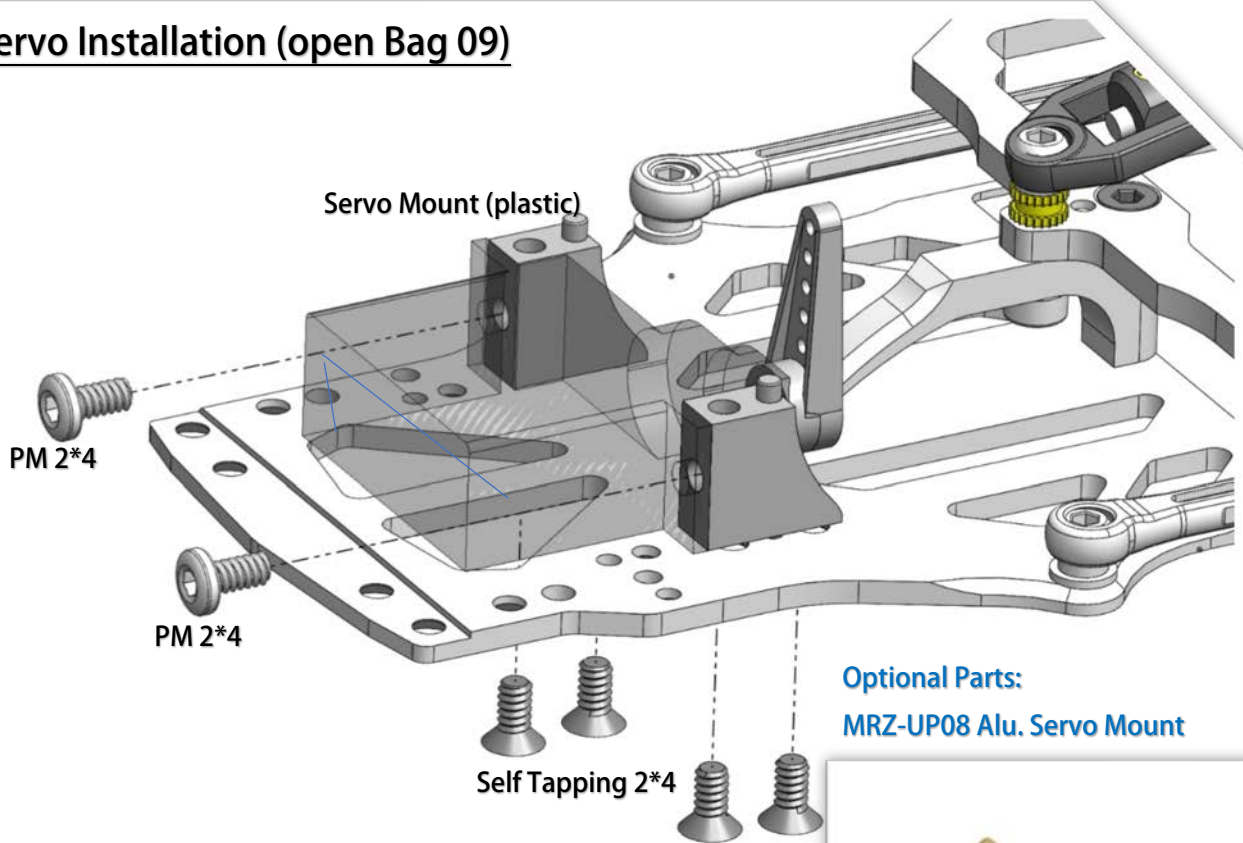

22 Front Bulkhead (open Bag 10)

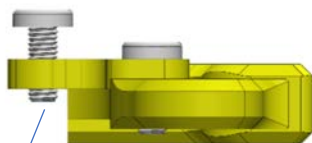
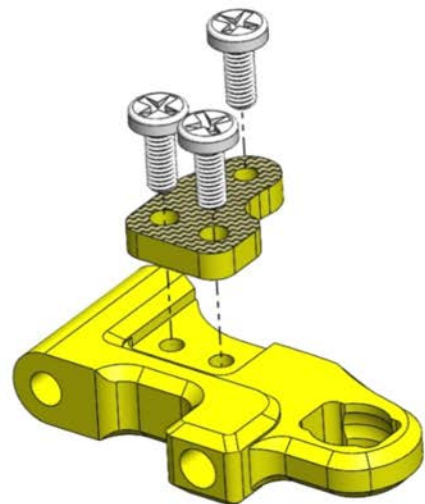
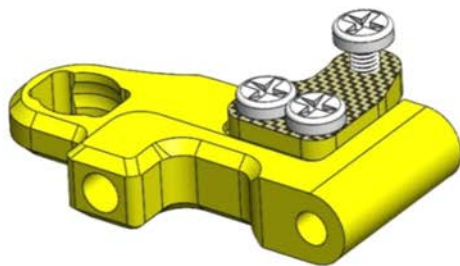

Droop screw tip come out 0.5mm

23 Lower Arm Mounts

Right Arm Mount

Left Arm Mount

KM 1.6 x 4

KM 1.6 x 4

24 Front Bulkhead

1.6 x 2.7 x 0.2 shim

1.5 x 12 pin

KM 2 x 4

Upgrade parts:

MRZ-UP27 Alu. Front Bulkhead



KM 2 x 4

27 Steering Crank

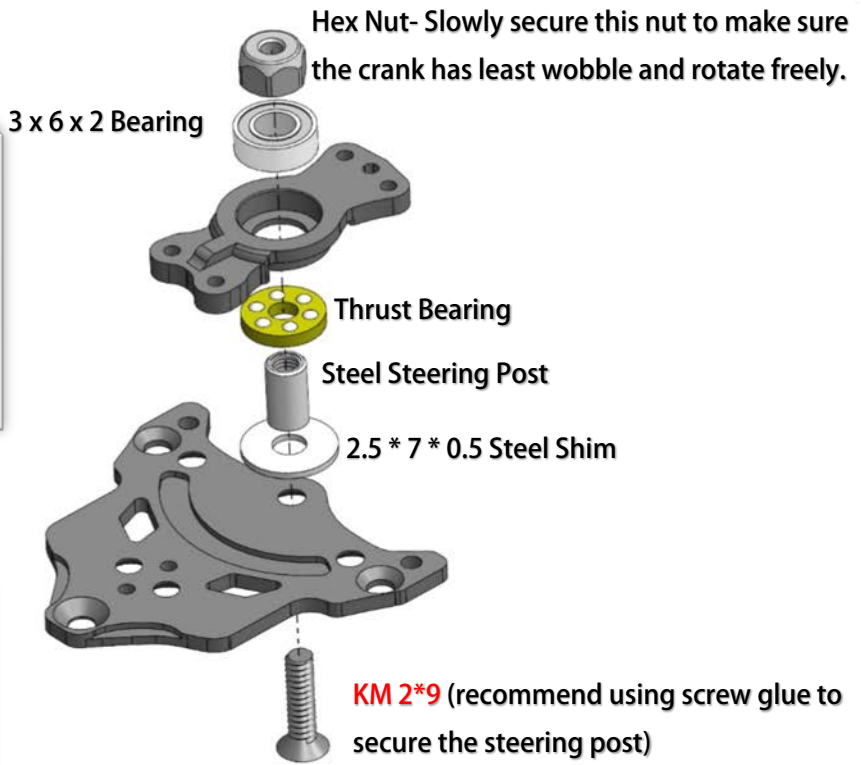
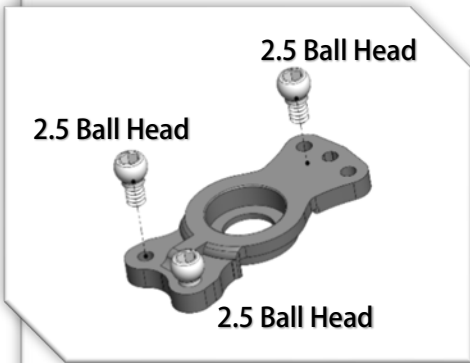

Upgrade parts:

MRZ-UP12 Alu. Steering Crank



28 Steering Angle Limiter

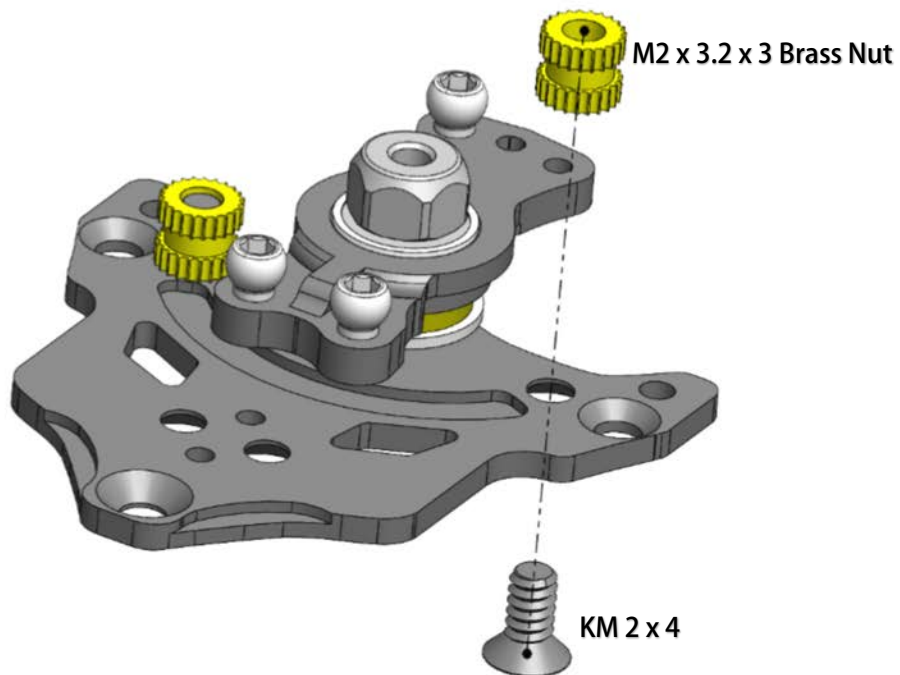

29 Upper Arms (Open Bag 13)

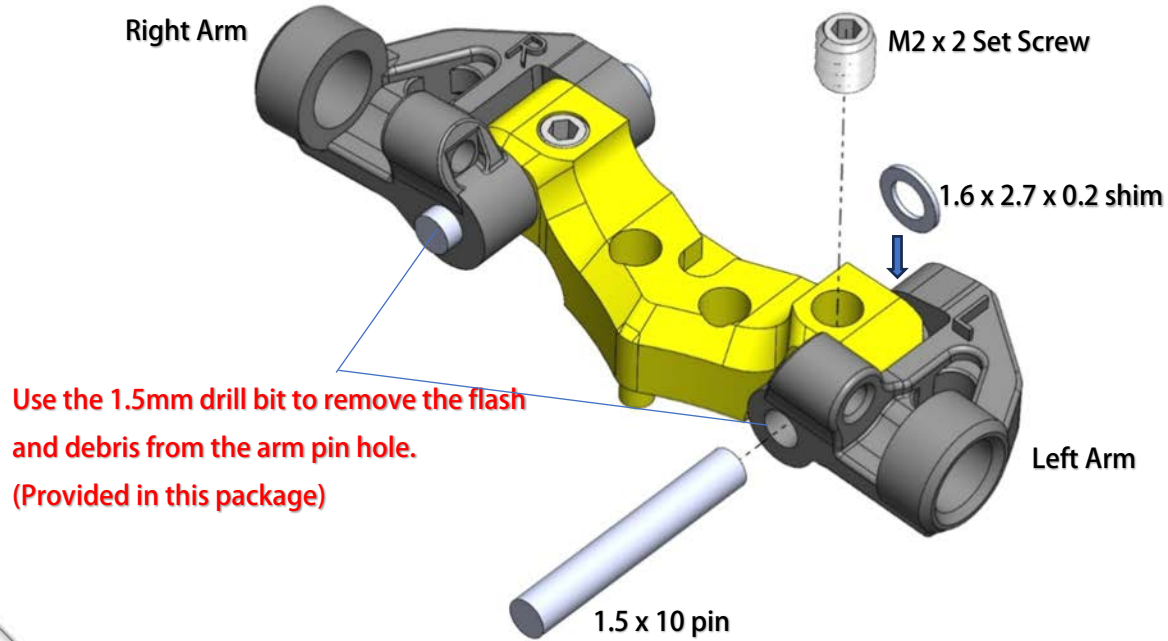

30 Turnbuckles

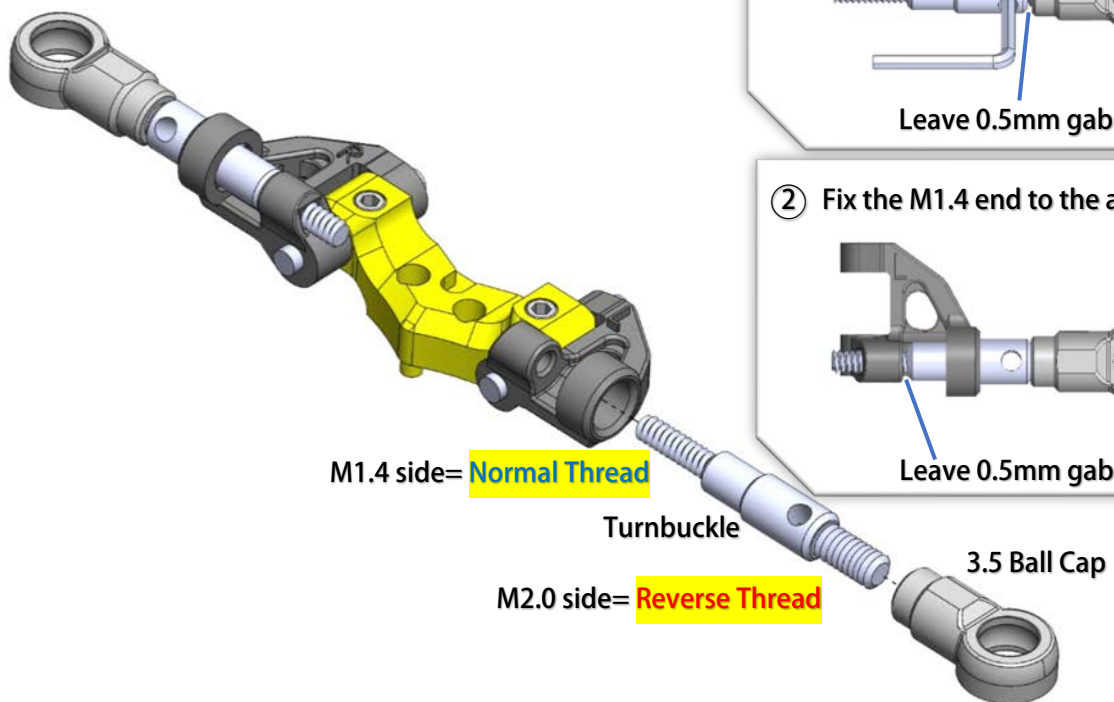

31 Upper Arm Mount

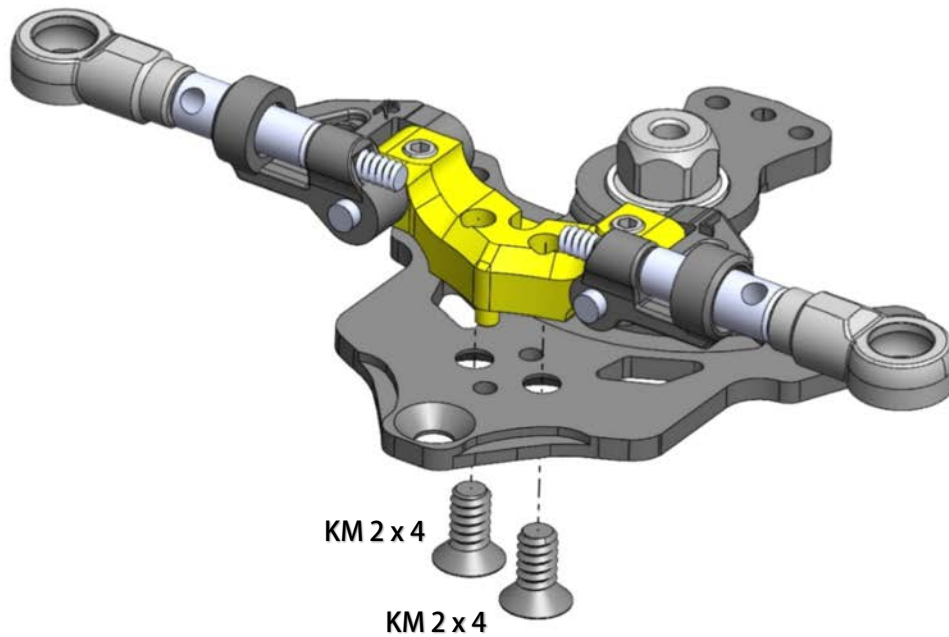

32 Pivot Ball (Open Bag 14)

Insert the Pivot Ball vertically and then turn 90 degrees inside the groove.

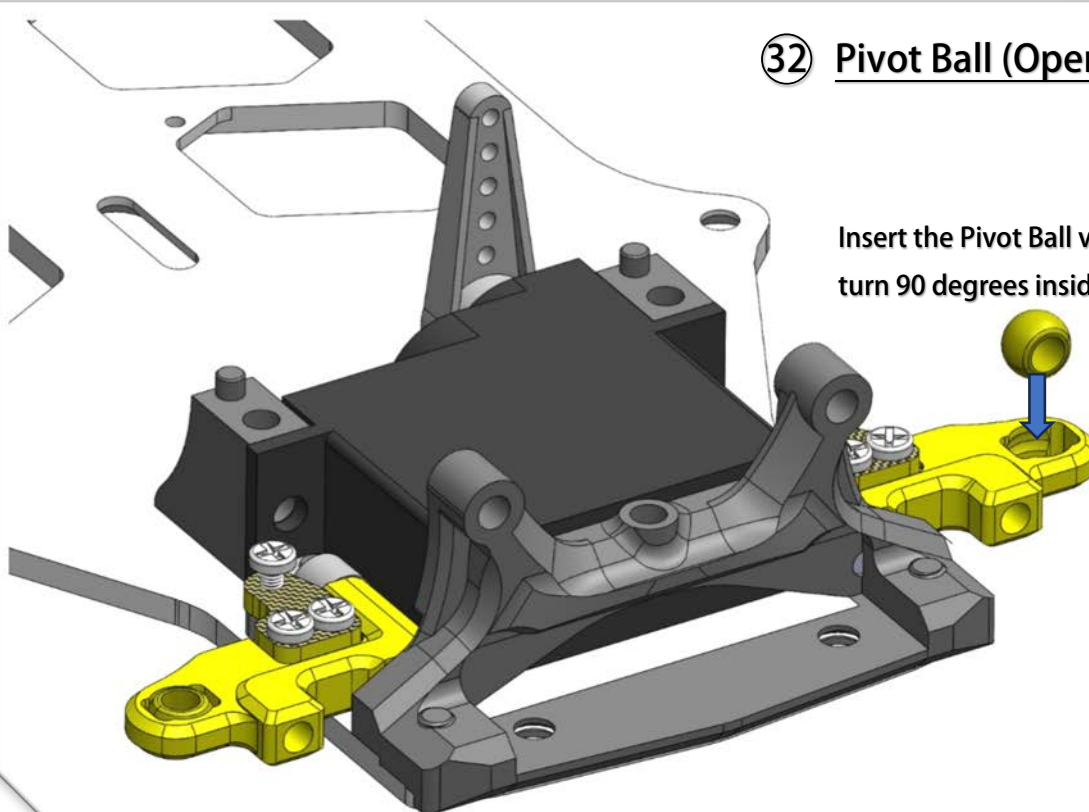

33 Steering Knuckles

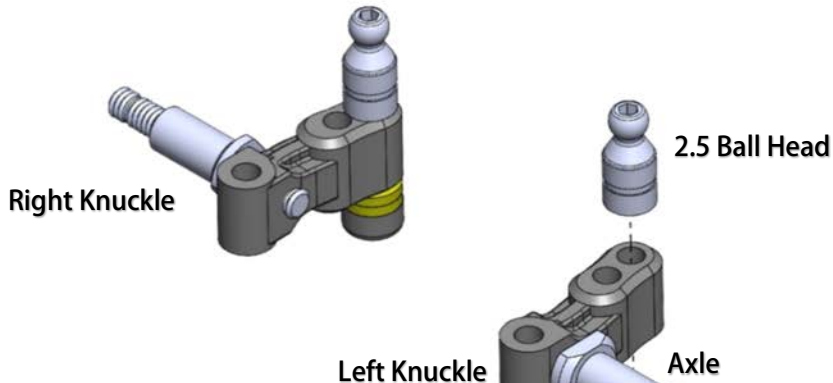

Upgrade parts:
MRZ-UP09 Alu. Knuckle

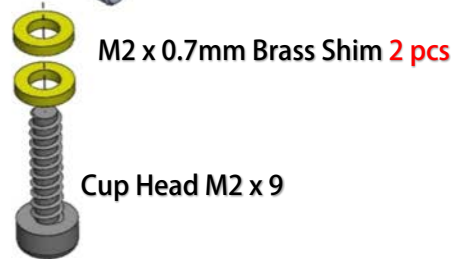

34 Steering Knuckles

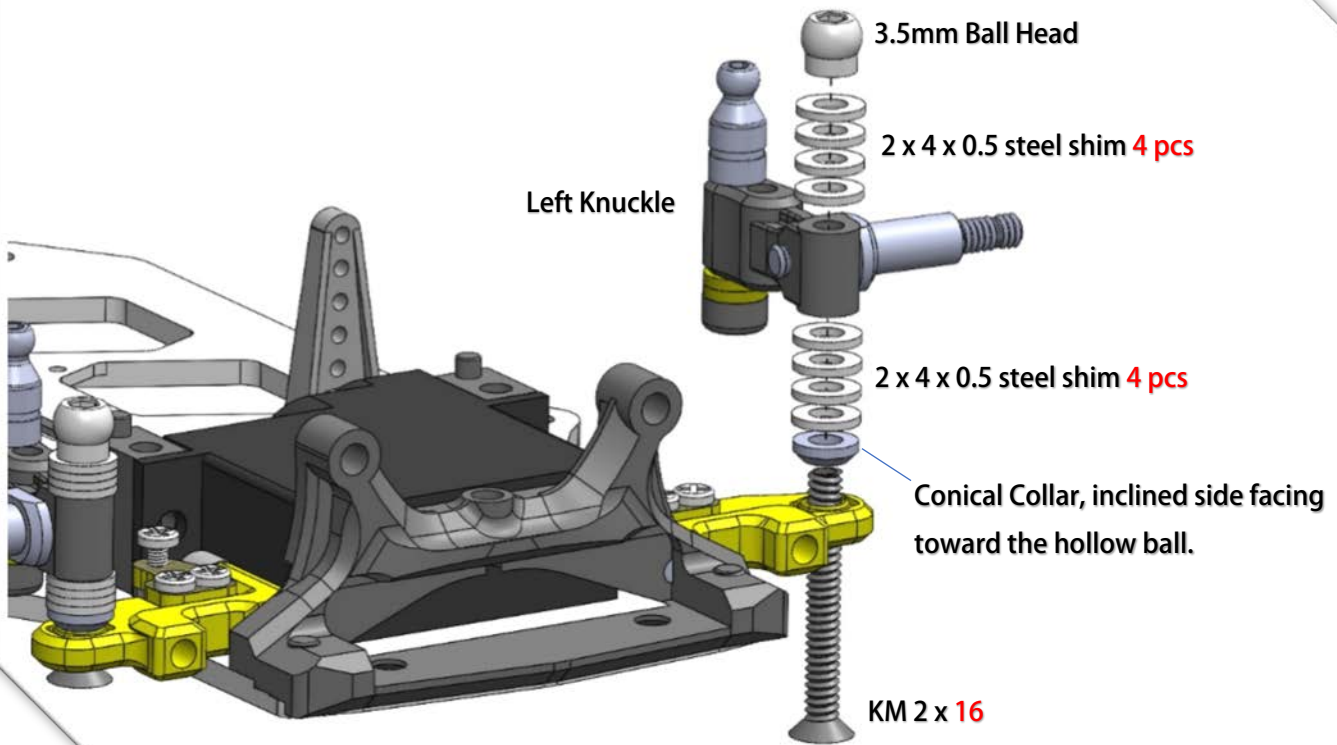

35 Steering System

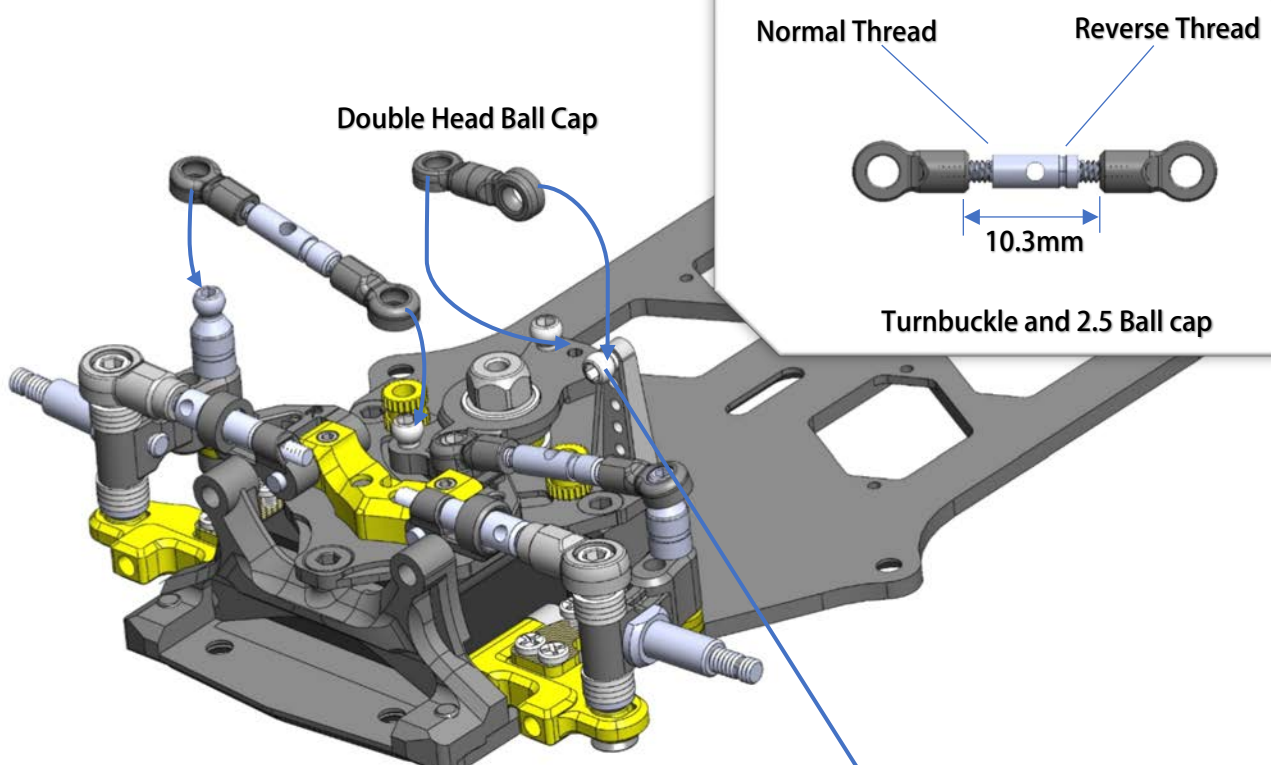
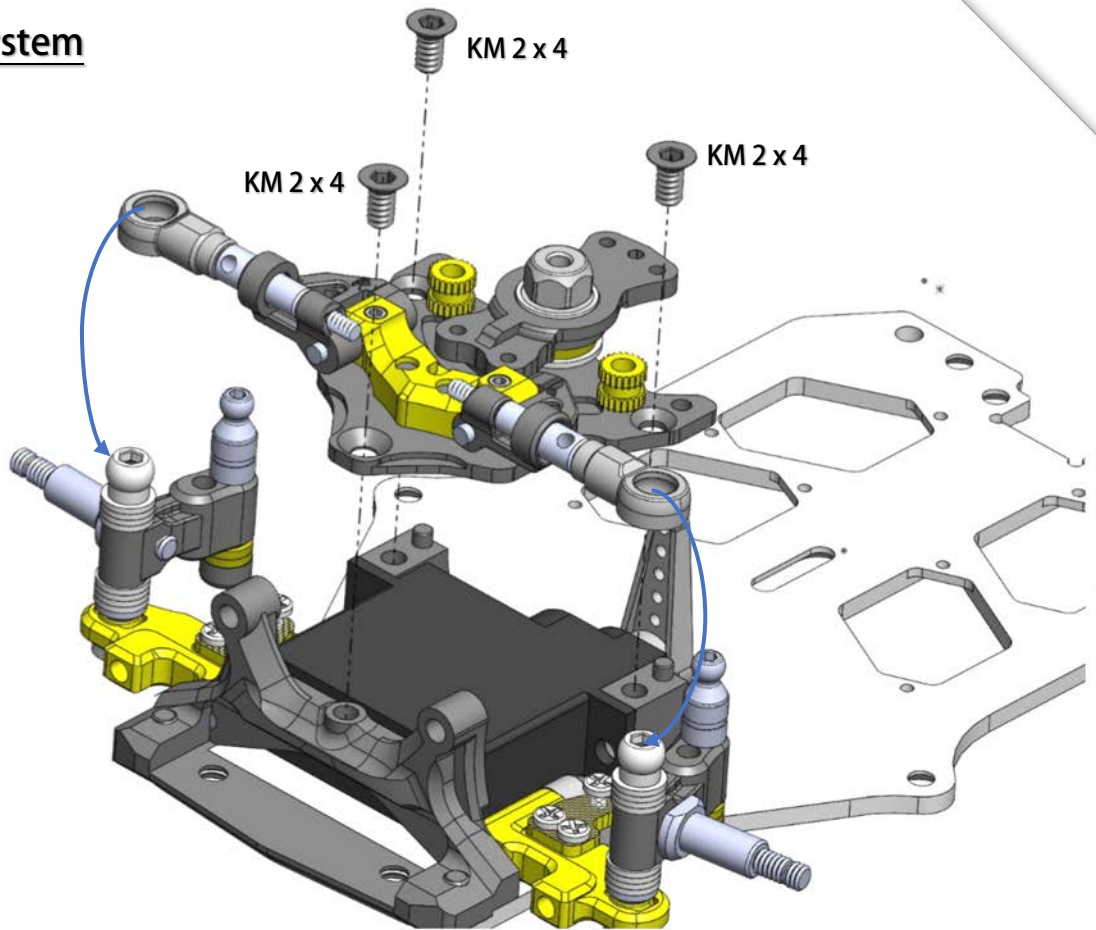

You may need to install the 2.5 ball on the other side of the horn, depends on which type of horn you have. We highly recommend getting the optional servo saver, as it is specially designed for this car.

36 Front Dampers (Open Bag 15)

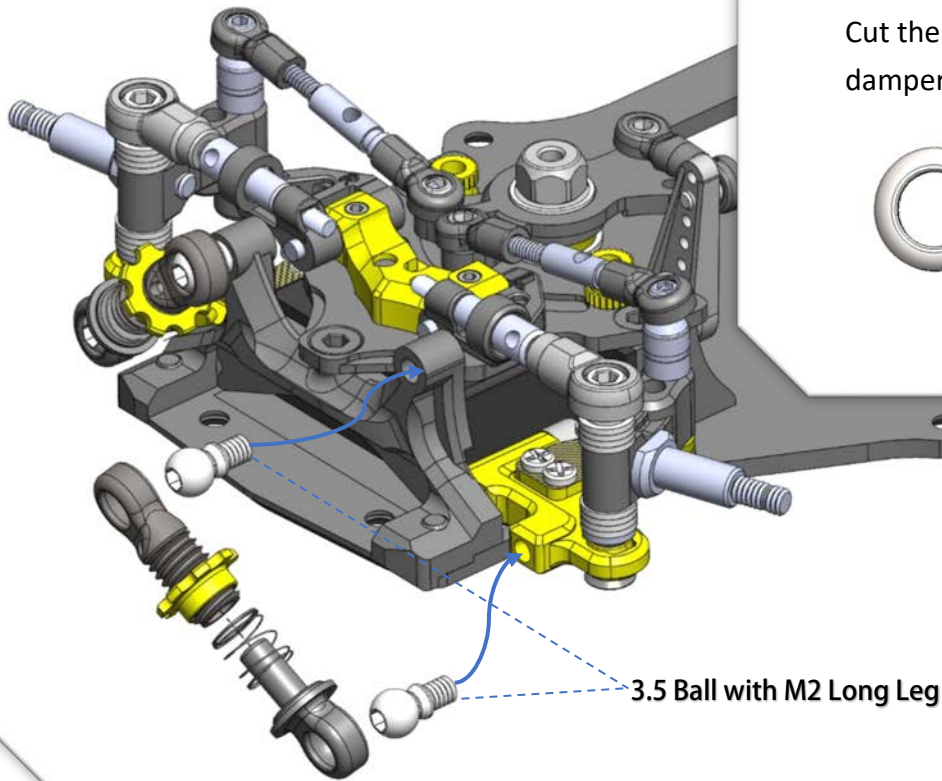

36 Gear Differential (open Bag 11)

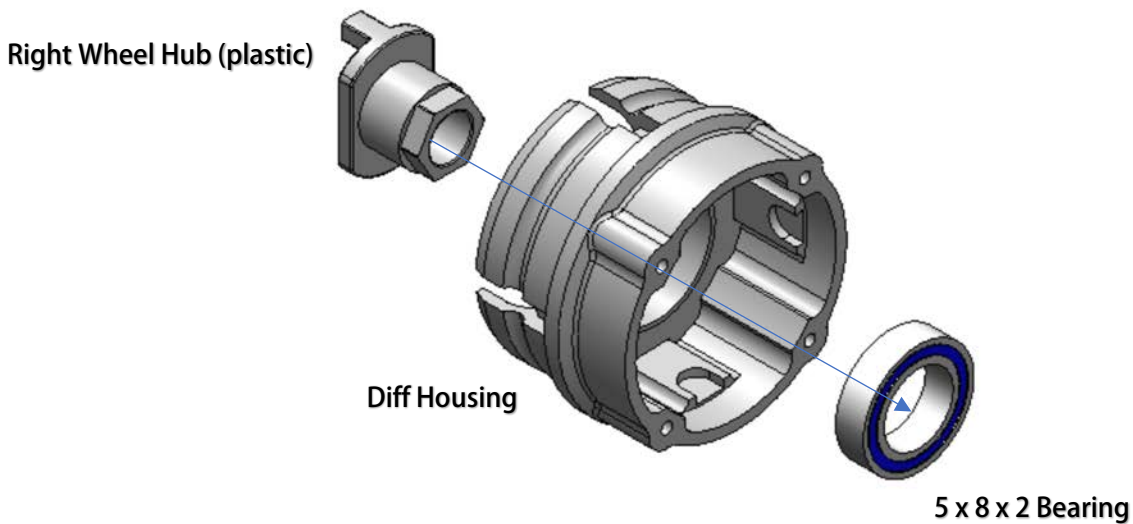

37 Gear Differential

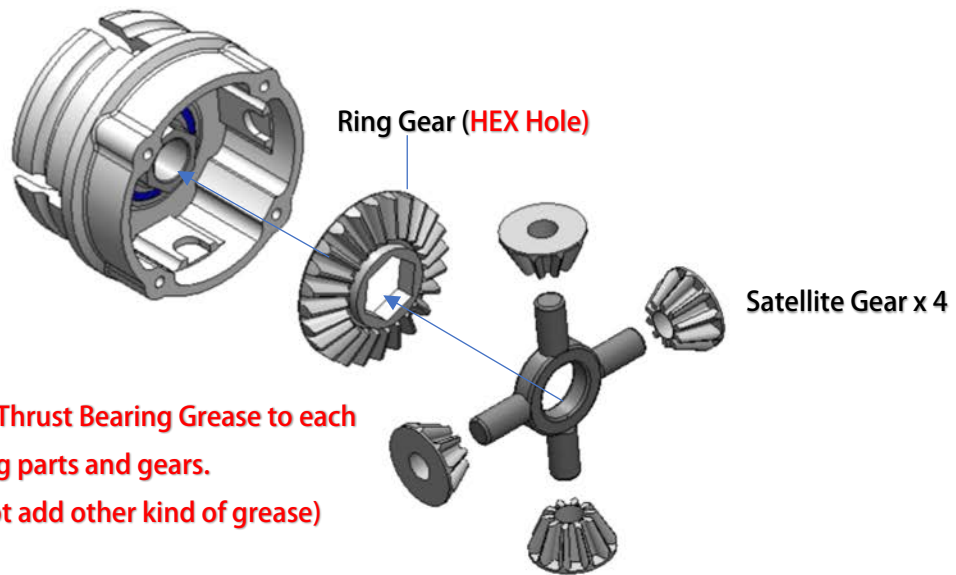

38 Gear Differential

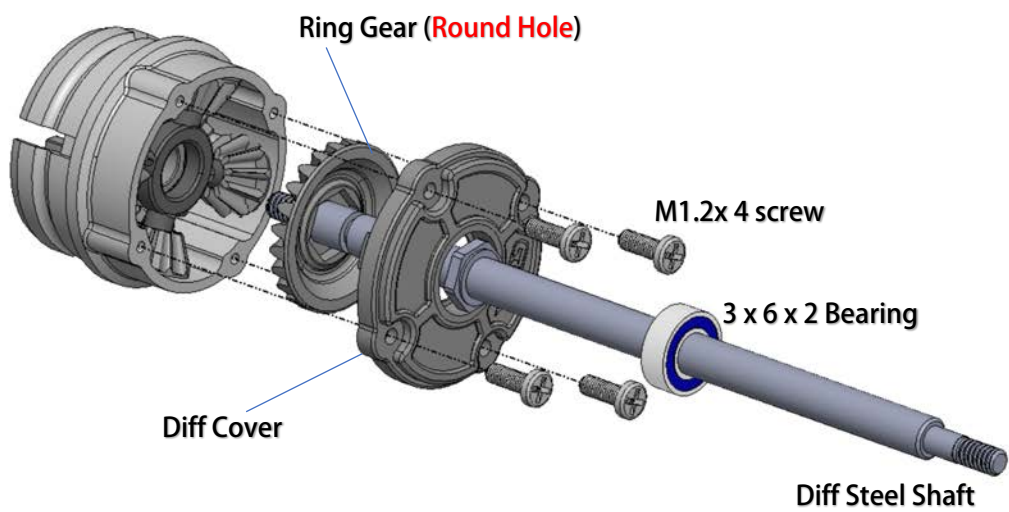

39 LSD Clutch

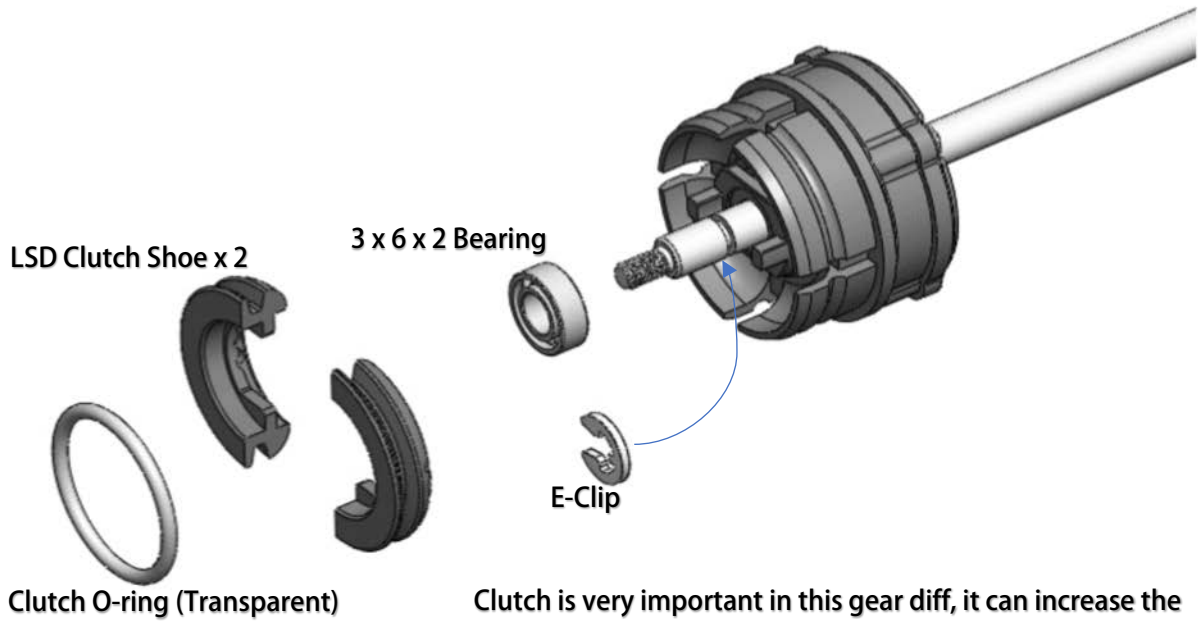

Clutch is very important in this gear diff, it can increase the friction of the diff system when the car accelerate and make the car more stable driving out of the corner.

37 Spur Gear

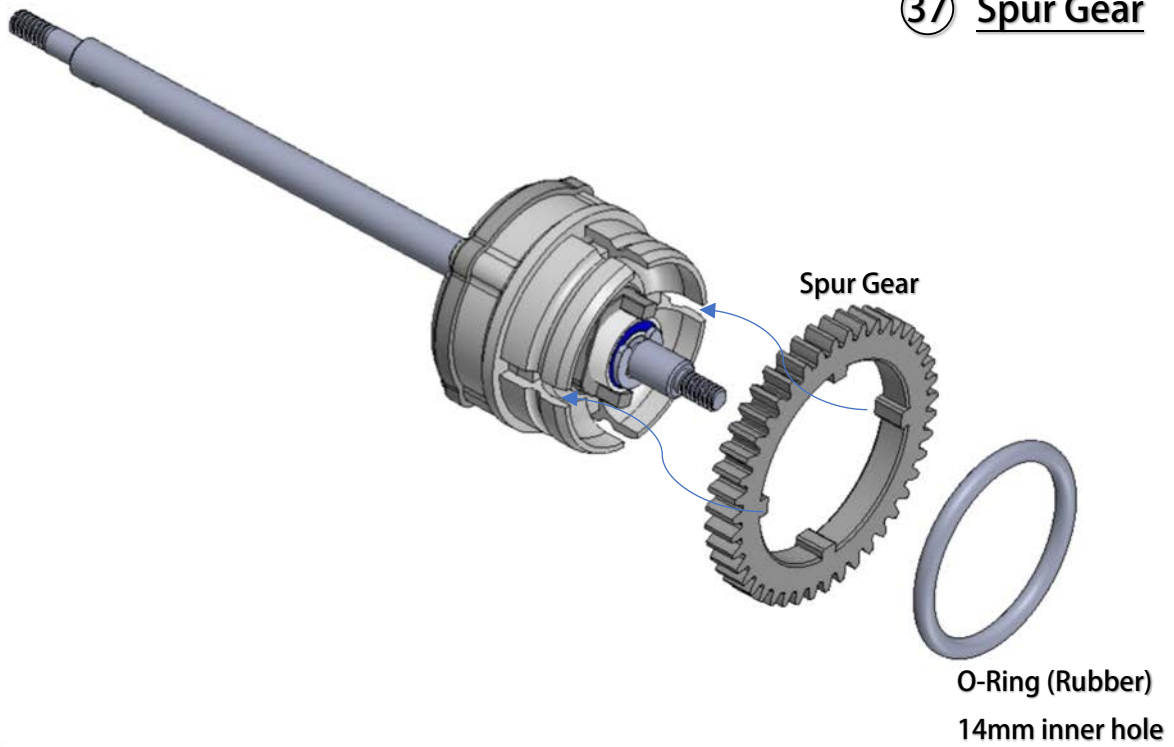

④① Install the Differential

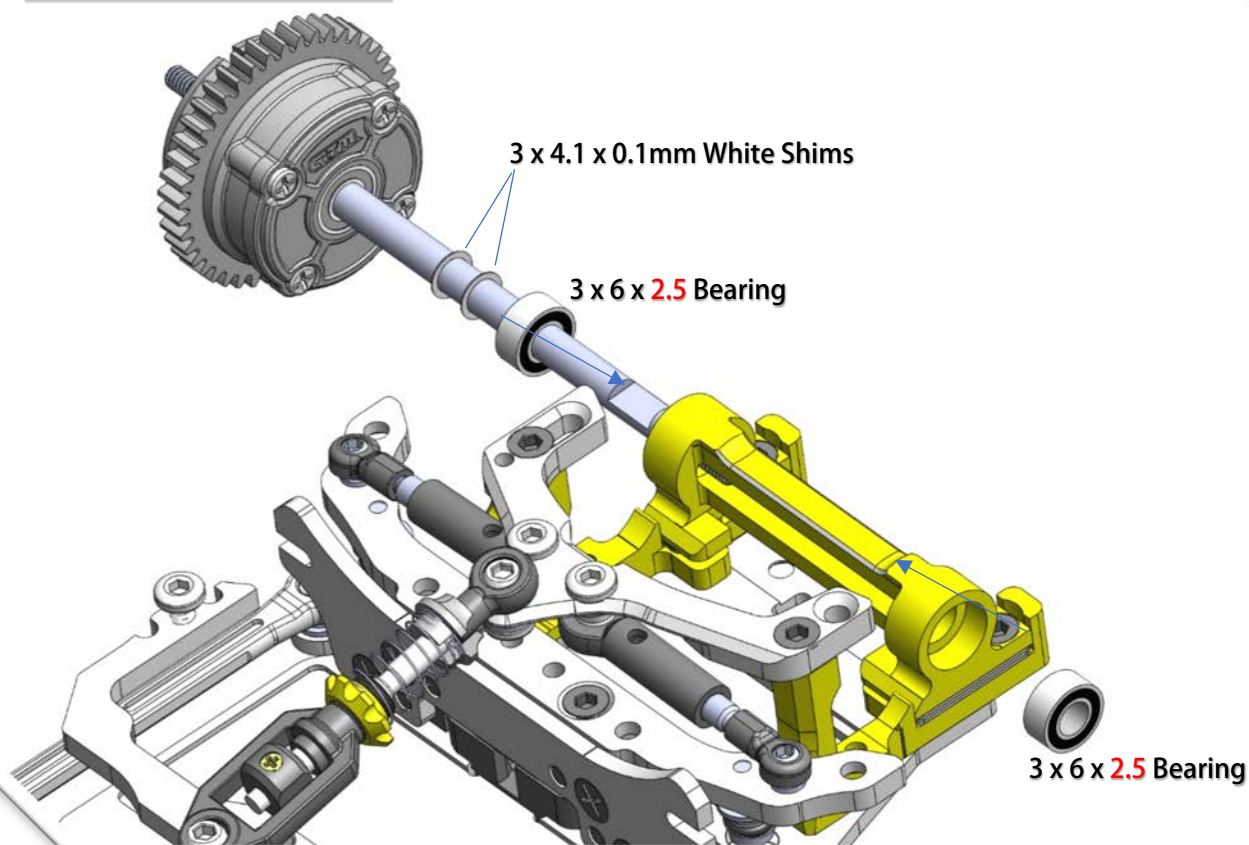

④② Wheel Adaptor

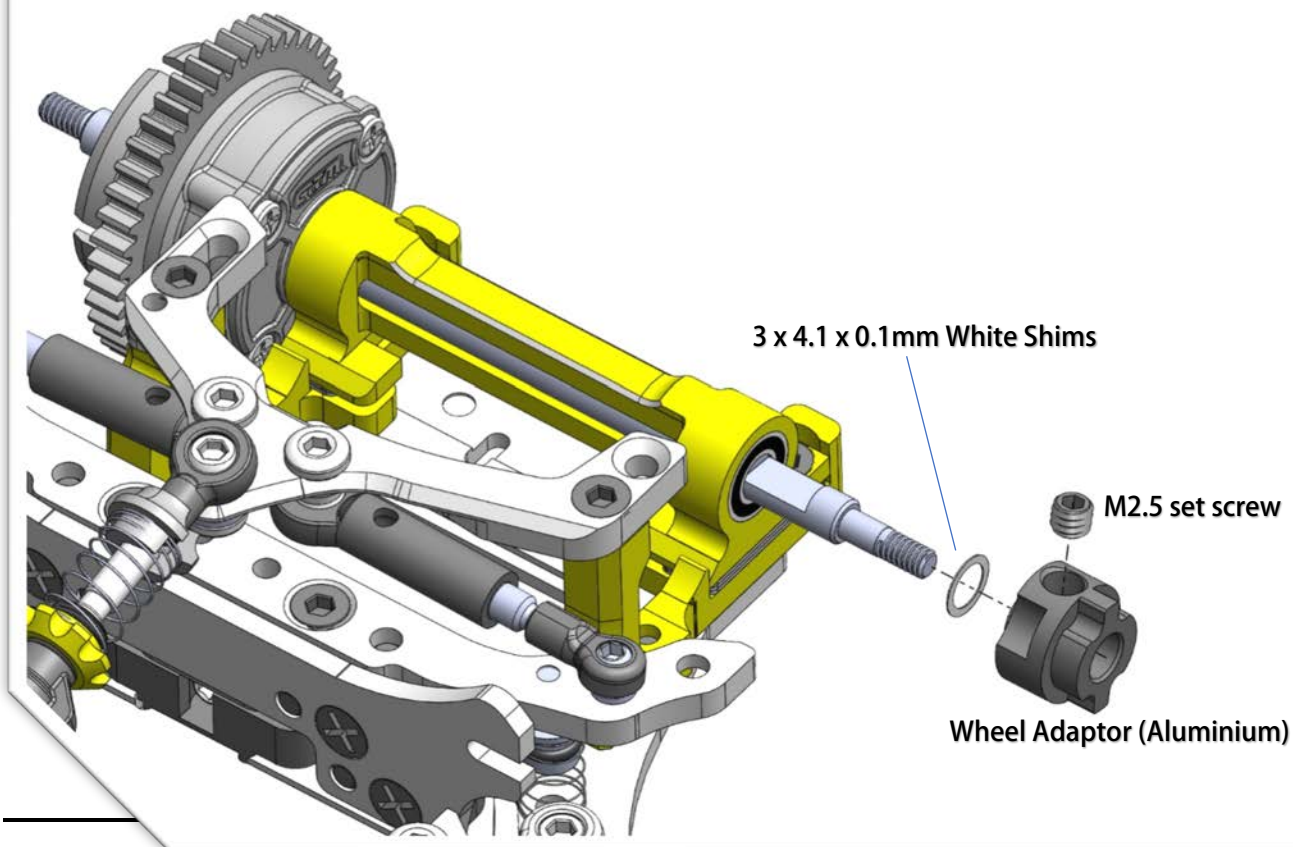

④② Diffuser

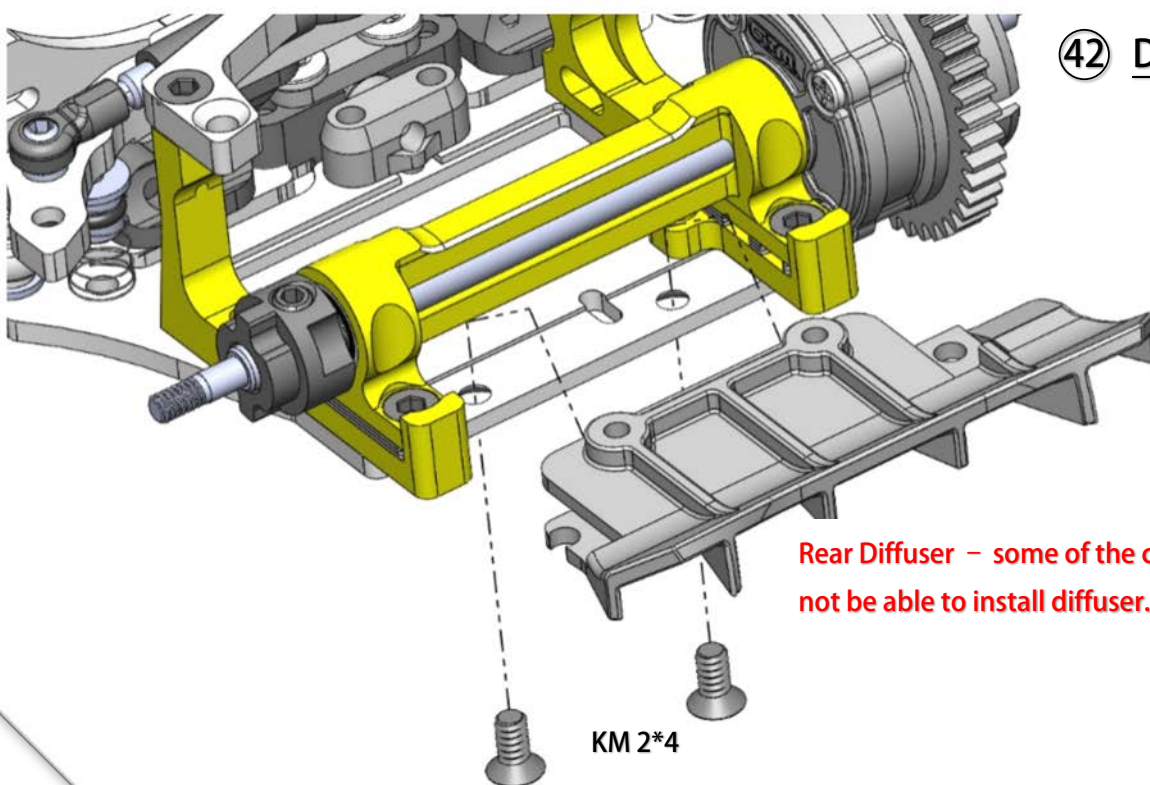

Rear Diffuser – some of the car body might not be able to install diffuser.

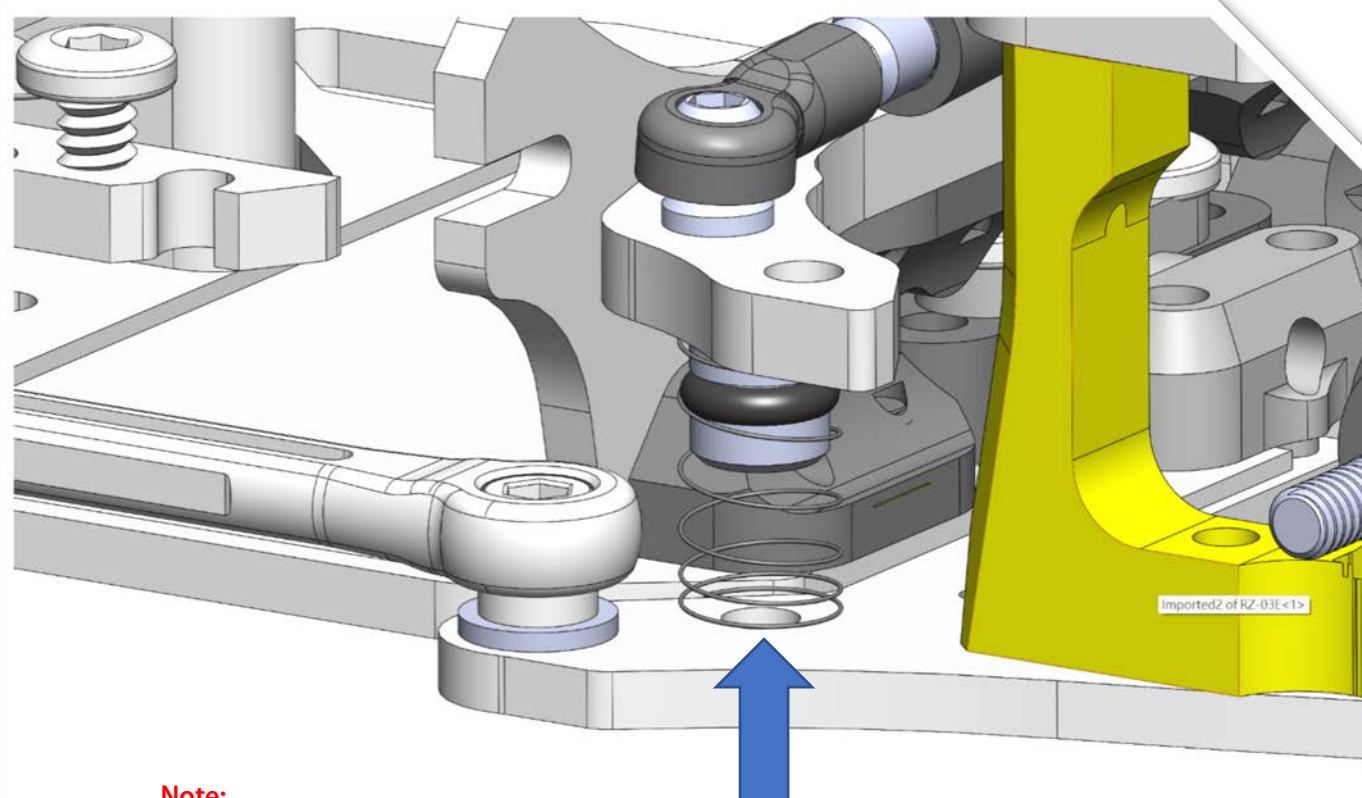

Note:

- Use 1.5 Hex Tool to adjust the side spring pressure thru the bottom hole of motor plate.
- Make sure the bottom of the spring just barely touches the motor plate. Excess spring force will make the rear of car loose grip.

Recommend using wheel:

Front N-0 offset wheel =74mm width

Rear W+2 offset wheel =74mm width

Rotate the turnbuckle to adjust the camber angle:
1.5 degree is a recommended.

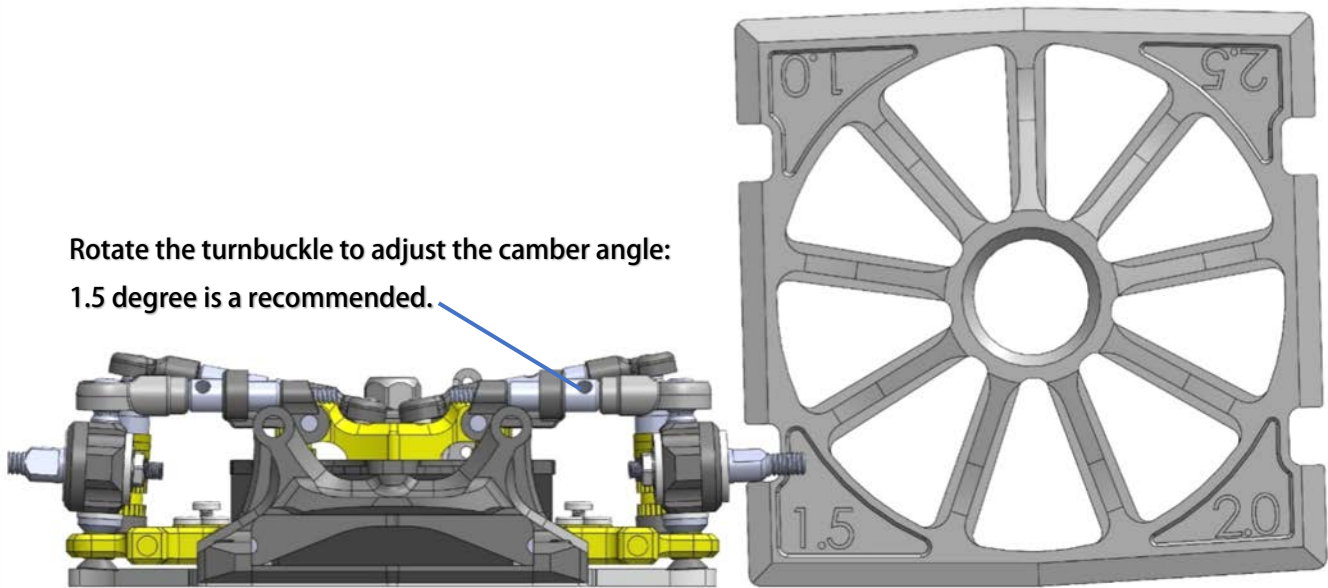

Adjust the spring tension, to achieve around 1.8 to 2.0mm ride height.

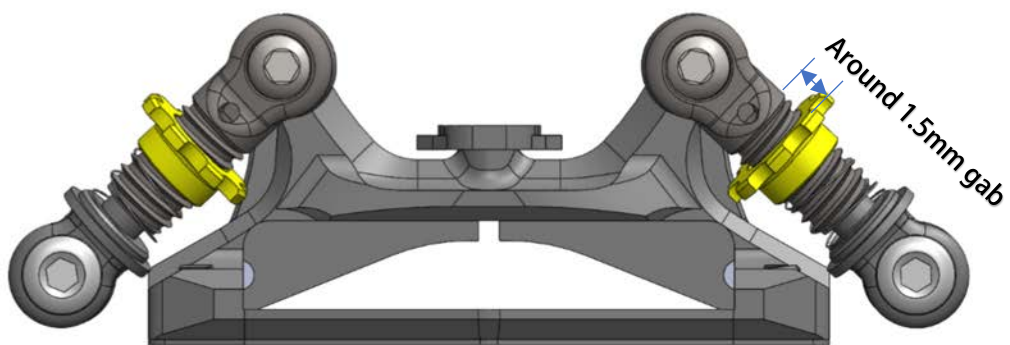

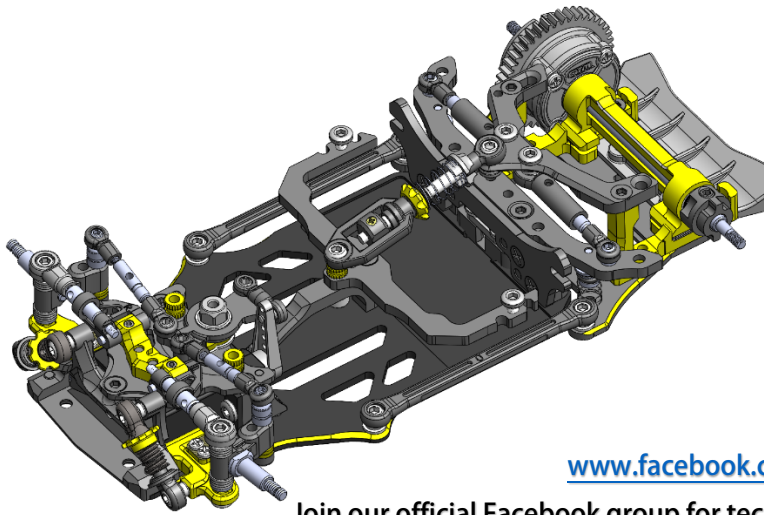

www.facebook.com/groups/1317091951707294

Join our official Facebook group for technical help or news information.

MRZ-UP04S	MRZ Mid Spring Soft (Red)
MRZ-UP04M	MRZ Mid Spring Medium (White)
MRZ-UP04H	MRZ Mid Spring Hard (Yellow)
MRZ-UP05	Spacer for Motor Pod (0.3mm) 6 pcs
MRZ-UP06	Spacer for Front Body Mount (0.5mm) 2 pcs
MRZ-UP07P2	DWS Optional Spring Set
MRZ-UP08	MRZ Alu. Servo Mount
MRZ-UP09	MRZ Alu. Knuckle
MRZ-UP12G	MRZ Alu. Steering Crank (Gold)
MRZ-UP12K	MRZ Alu. Steering Crank (Black)
MRZ-UP16	MRZ Ball Differential
MRZ-UP21	MRZ Light weight Mid Damper Shaft
MRZ-UP22	MRZ Rear Body Post
MRZ-UP24-10	Hard Coated 64DP Pinion 10T (MRZ)
MRZ-UP24-11	Hard Coated 64DP Pinion 11T (MRZ)
MRZ-UP24-12	Hard Coated 64DP Pinion 12T (MRZ)
MRZ-UP24-13	Hard Coated 64DP Pinion 13T (MRZ)
MRZ-UP24-14	Hard Coated 64DP Pinion 14T (MRZ)
MRZ-UP24-CB	Hard Coated 64DP Pinion Set 10-14T (MRZ)
MRZ-UP29	MRZ Aluminium Chassis Set
MRZSF-02S	MRZ SF Side Spring (Soft-Red)
MRZSF-02M	MRZ SF Side Spring (Medium-Black)
MRZSF-02H	MRZ SF Side Spring (Hard-Silver)
MRZSF-02-01	MRZ SF Side Spring O-ring (4 pcs)
MRZSF-02-02	MRZ SF Side Spring Hub (2pcs)