

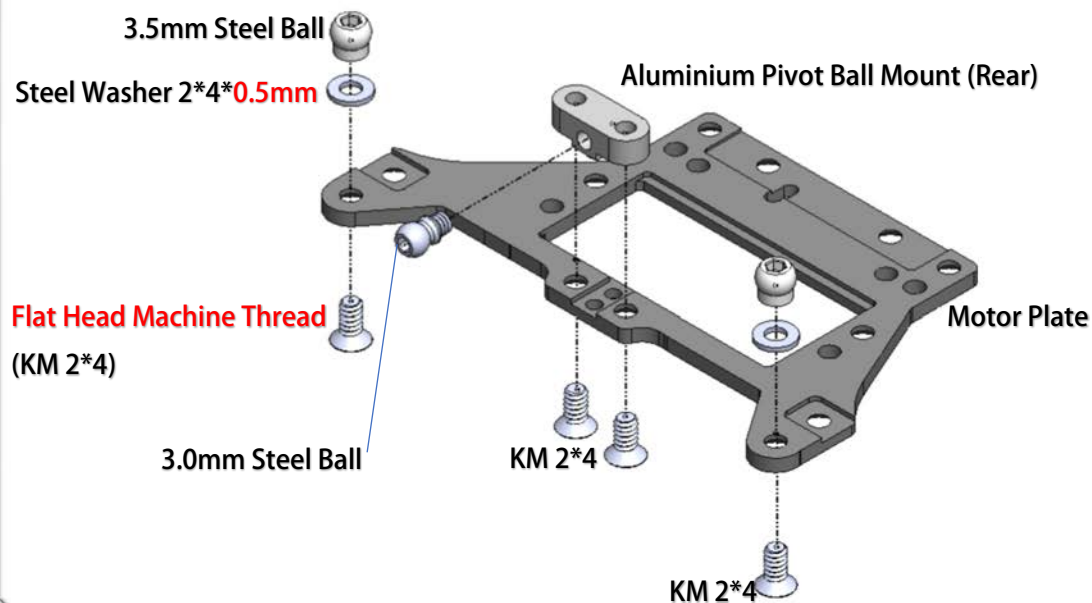

V1.1 Assembly Manual

01 Chassis Center Pivot (open Bag 1 to 5)



02 Chassis Center Pivot

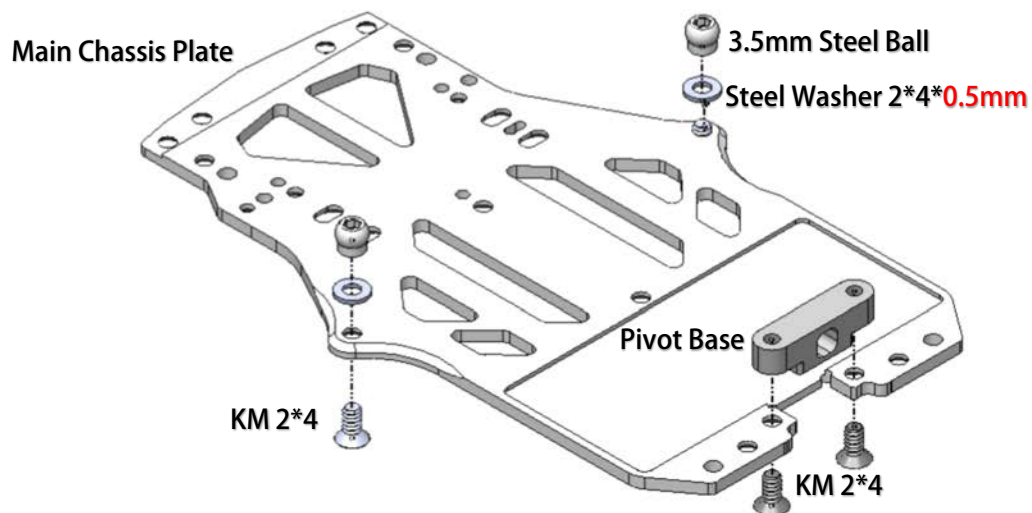

③ Side Links System

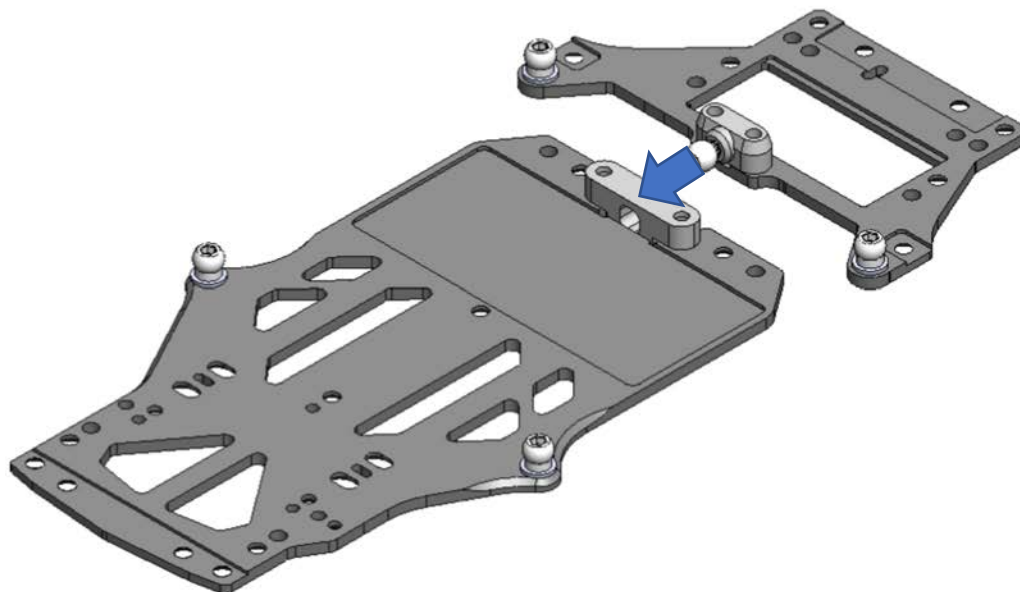

④ Fixing Side Links

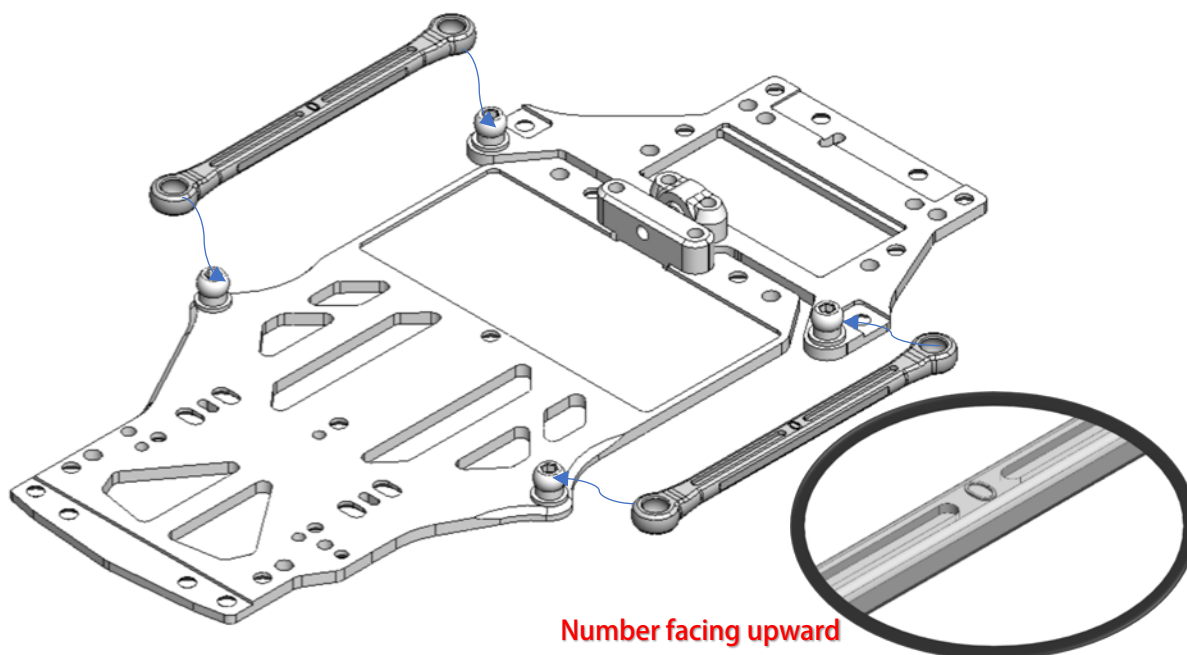

⑤ Side Body Mount (open Bag 06, 07)

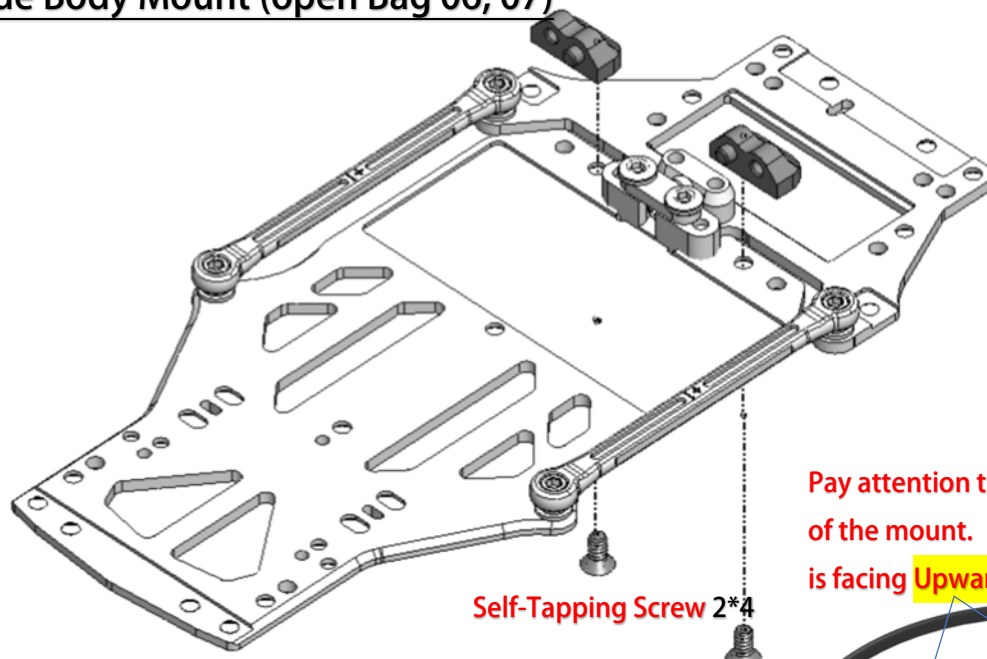

Pay attention to the orientation of the mount. "Wave shape" is facing **Upward**.

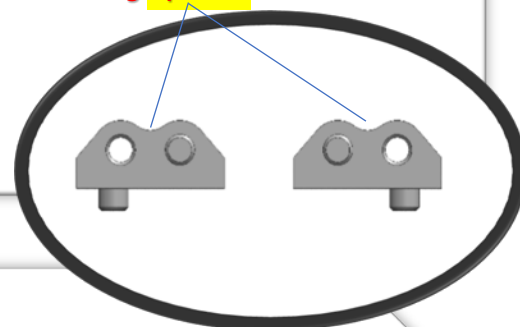

⑥ Car Body Mount Plate

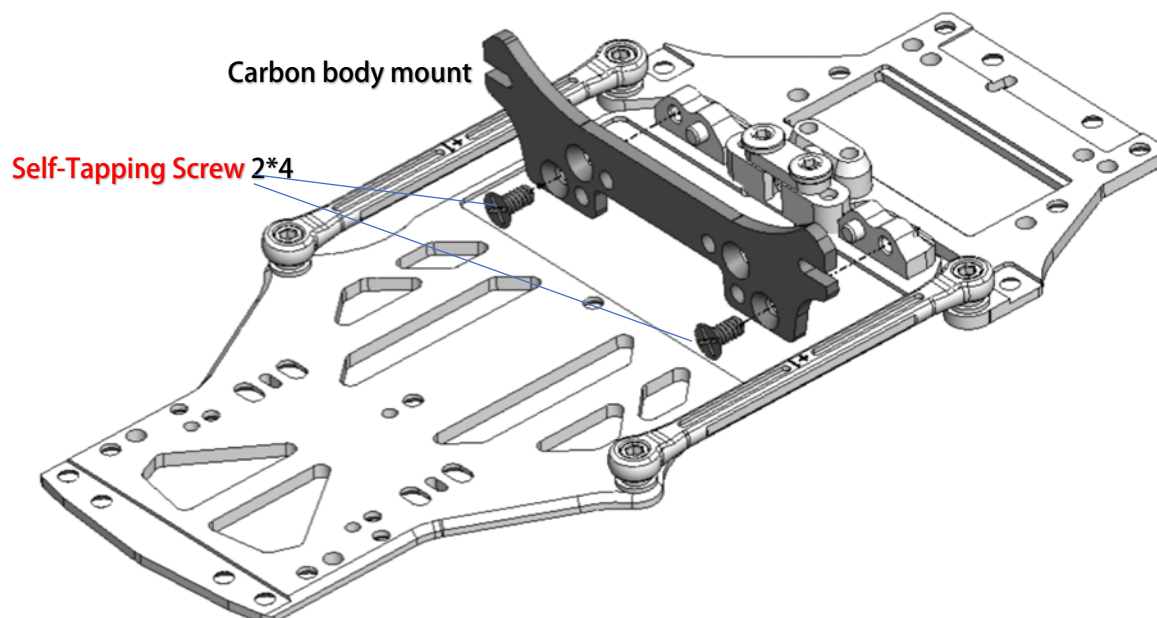

07 Car Body Mount Plate

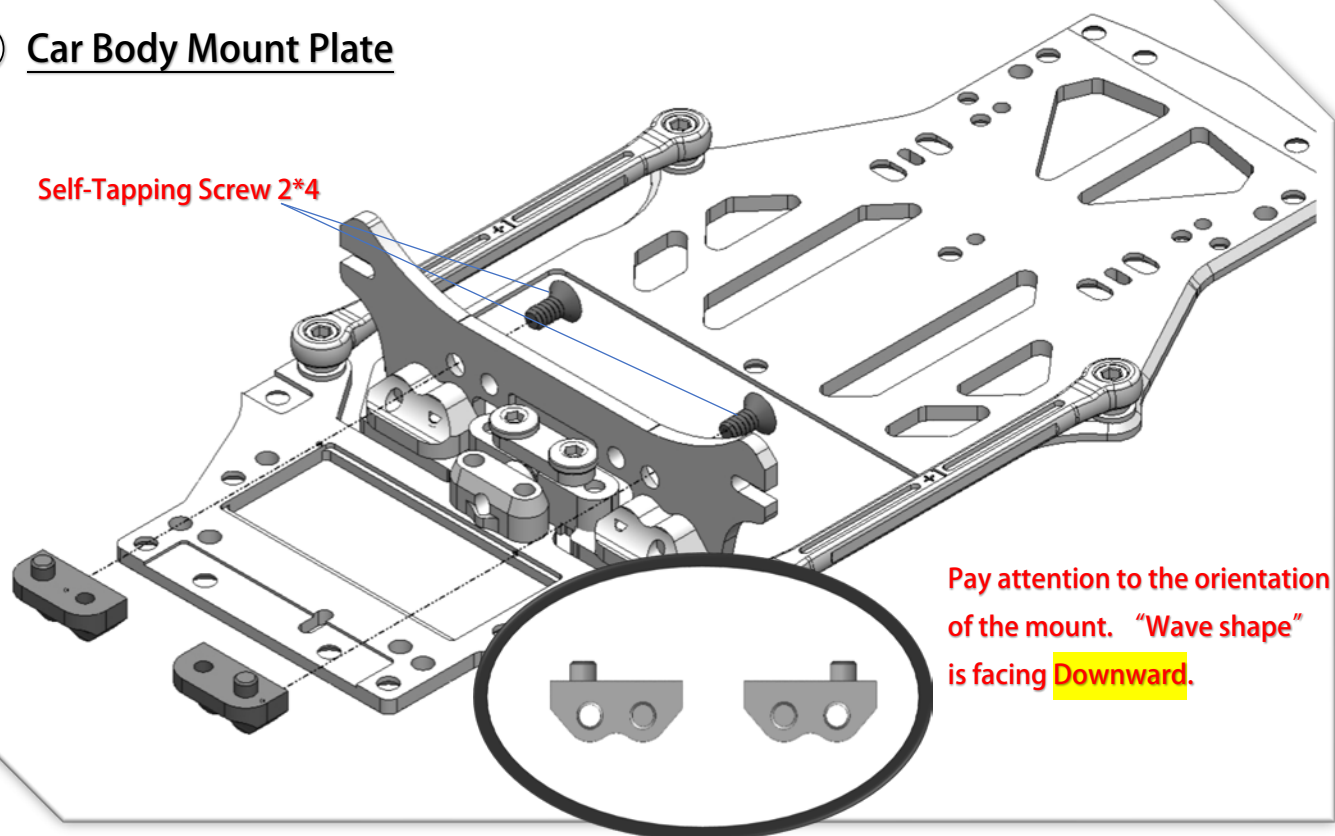

08 Motor Pod

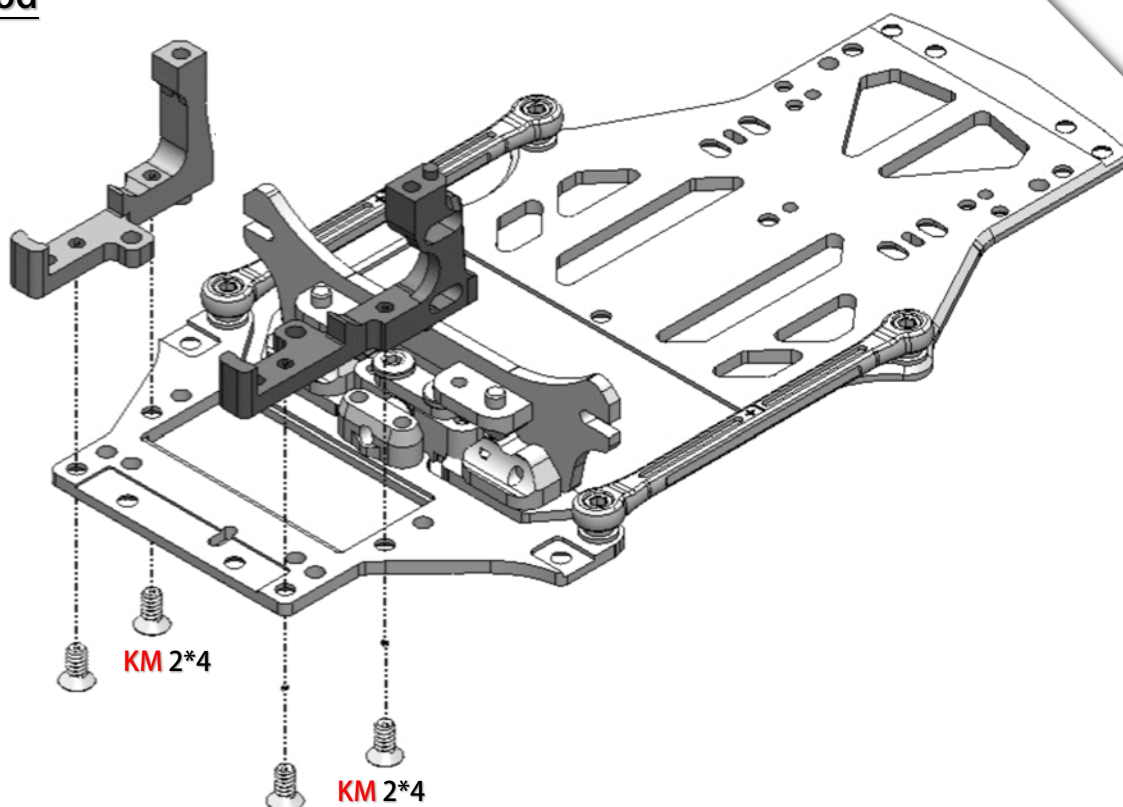

09 Ride Height Spacers

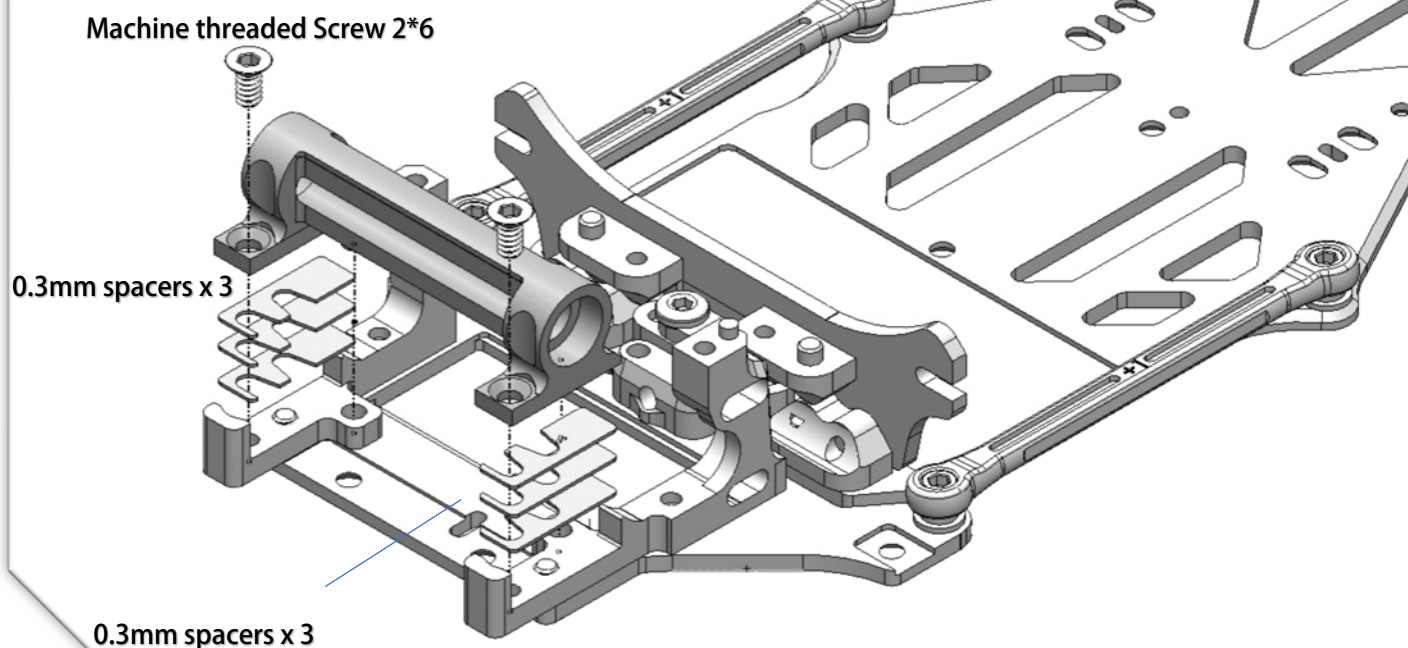

10 Side Spring Hub (open Bag 08)

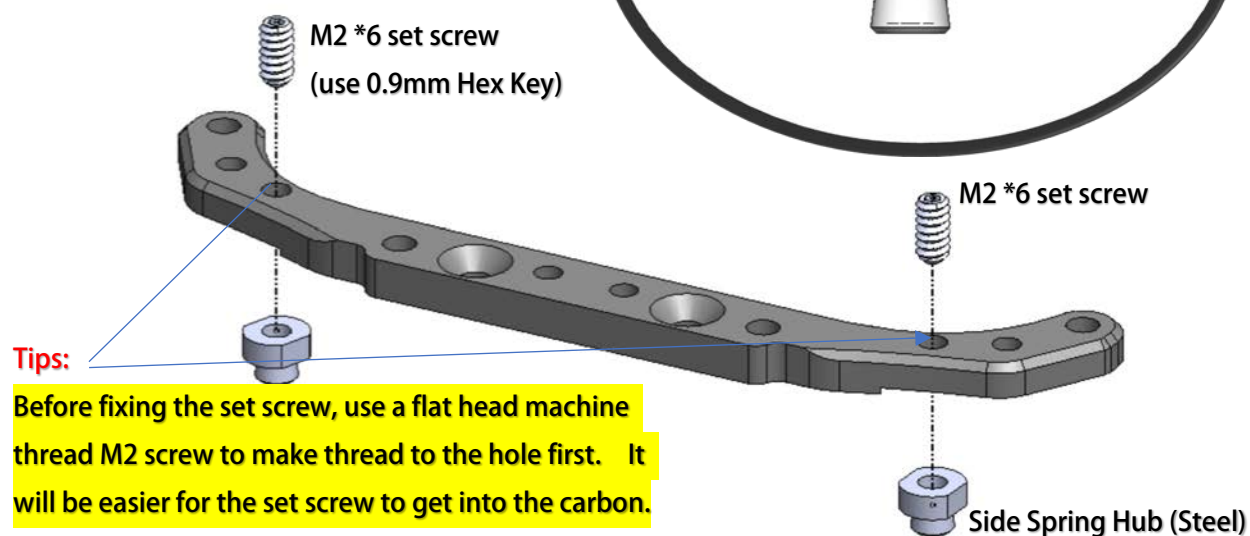

⑪ Side Springs (open Bag 09)

Tips:

Put the carbon plate upside down on a flat surface, then press the spring against the hub. Make sure the spring is sat and locked by the hub.

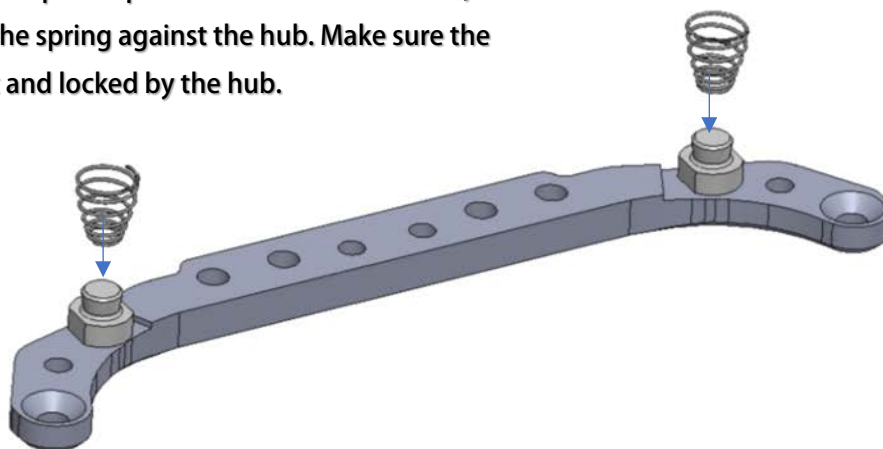

⑫ Body Post Plate

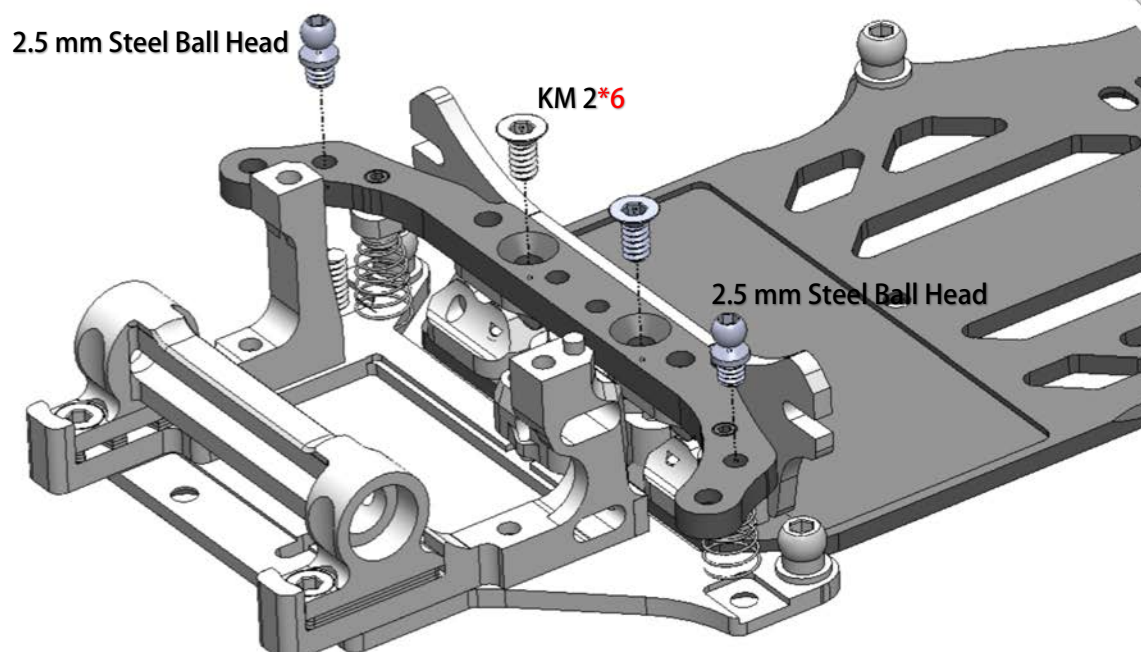

⑬ Middle Chassis Support

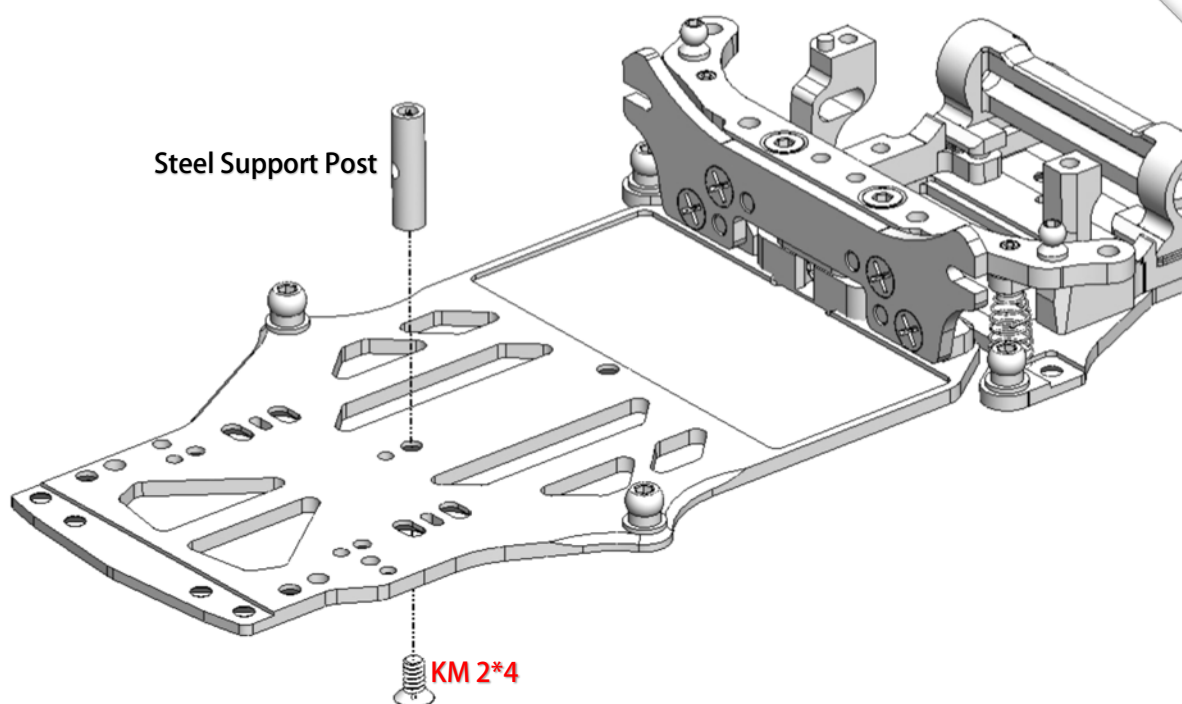

⑭ Battery Mount

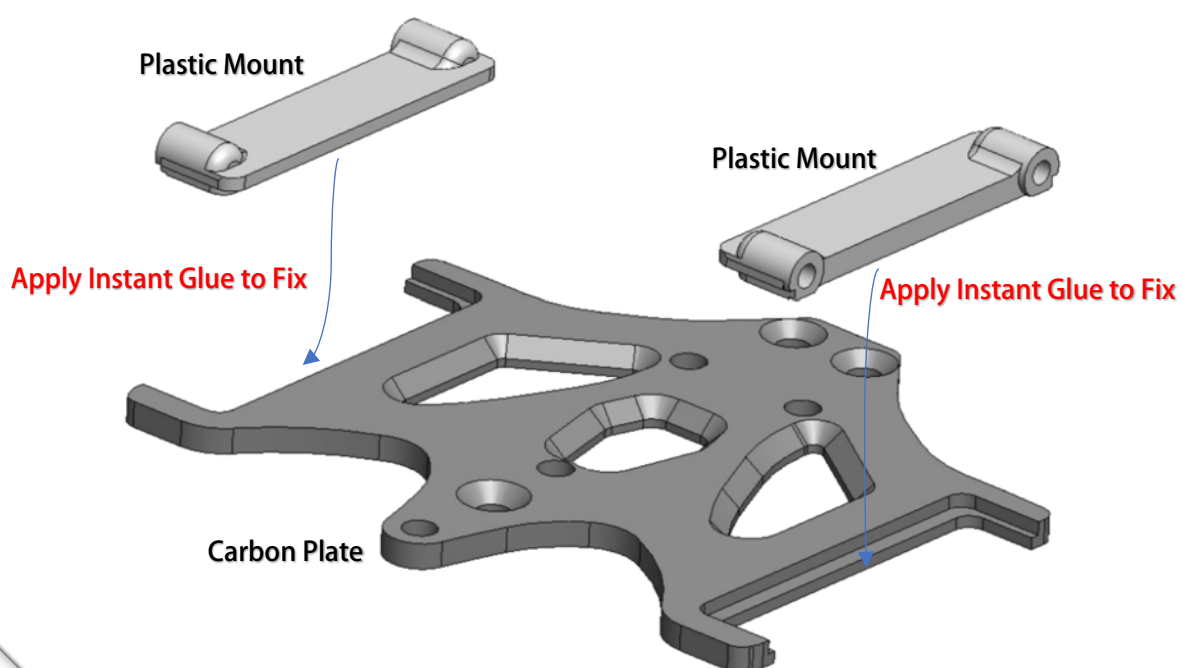

15 Battery Mount Door

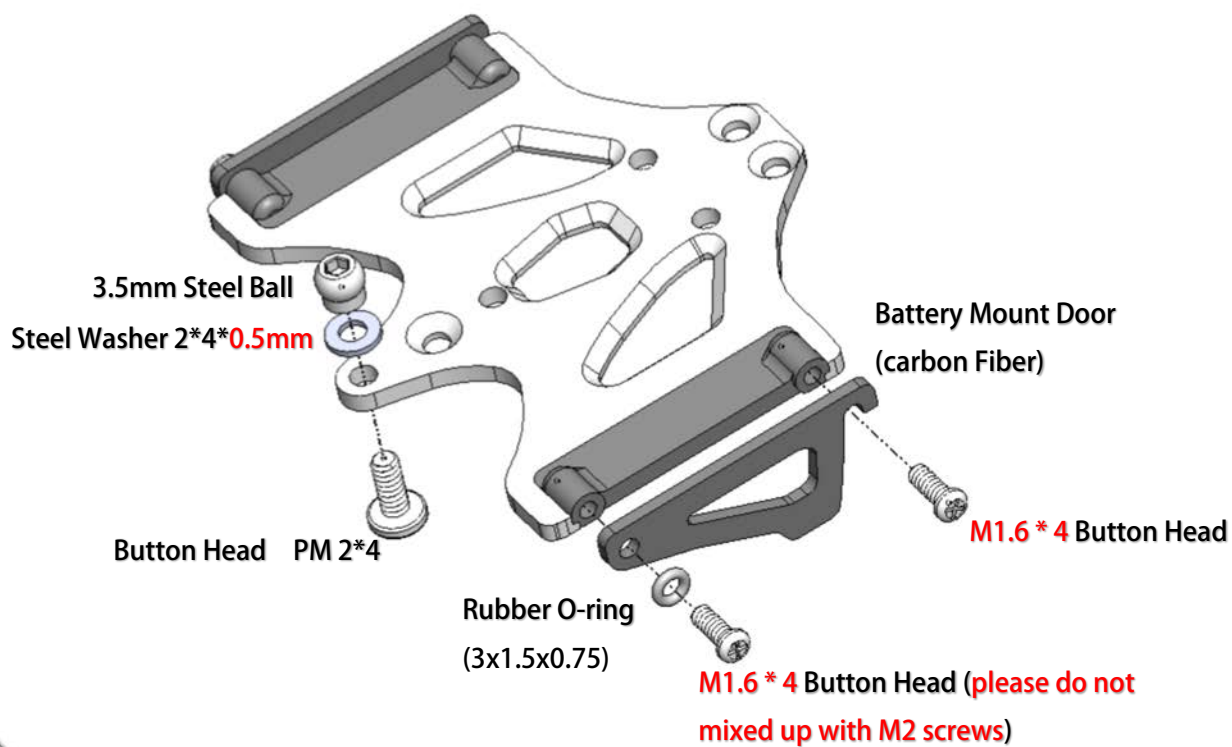

16 Battery Mount Installation

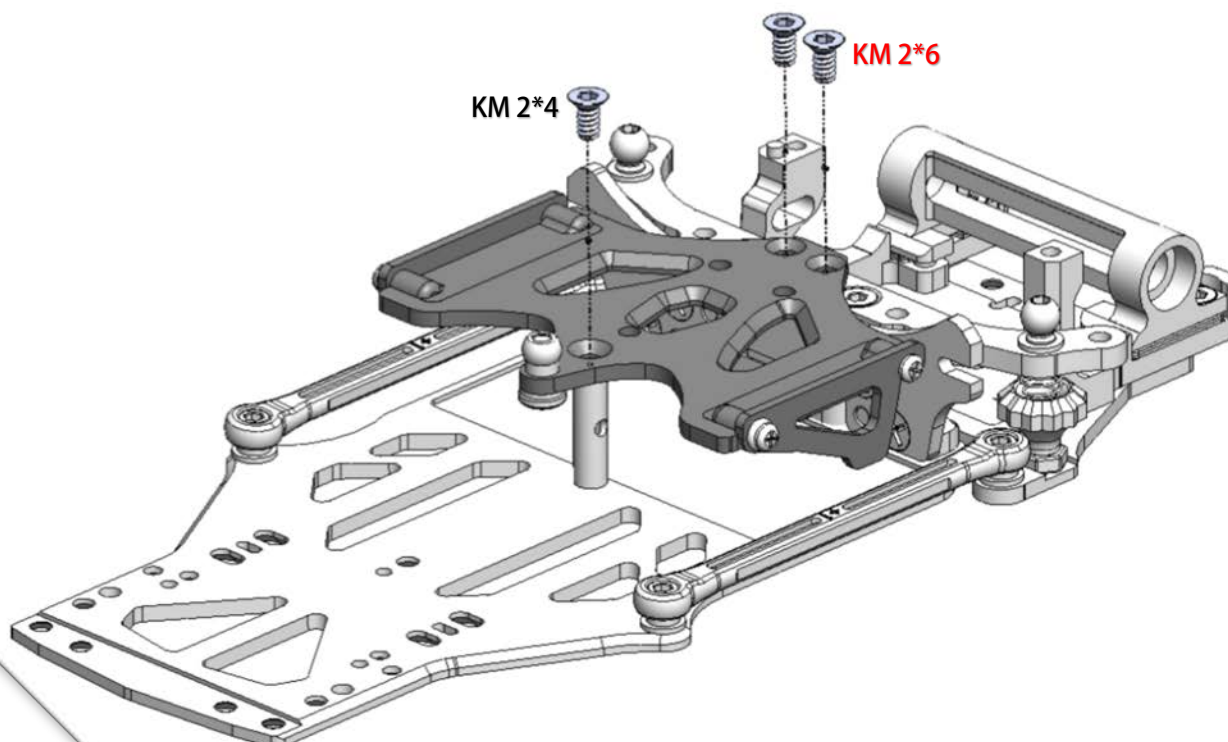

17 Lateral Shock Dampers

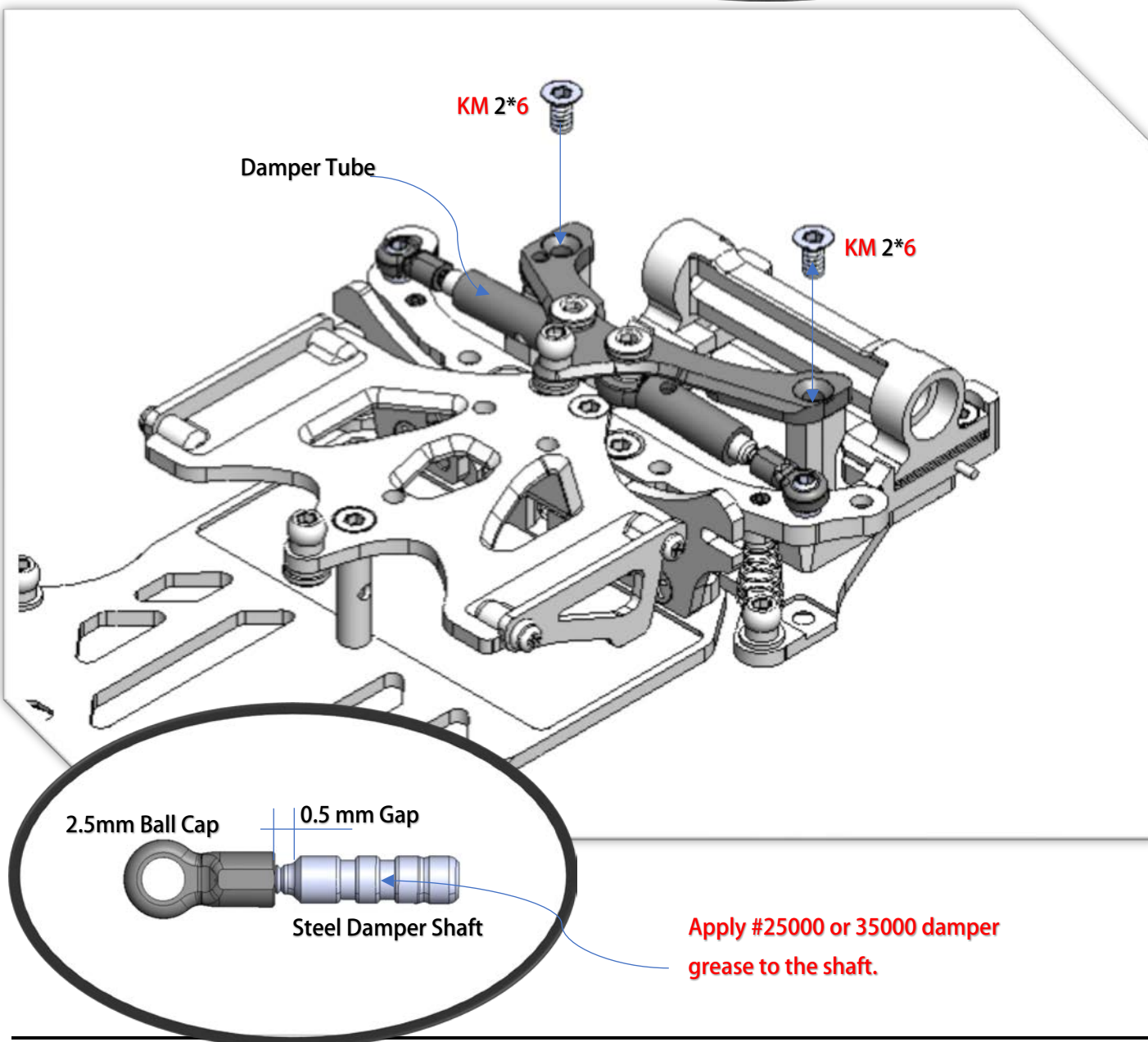
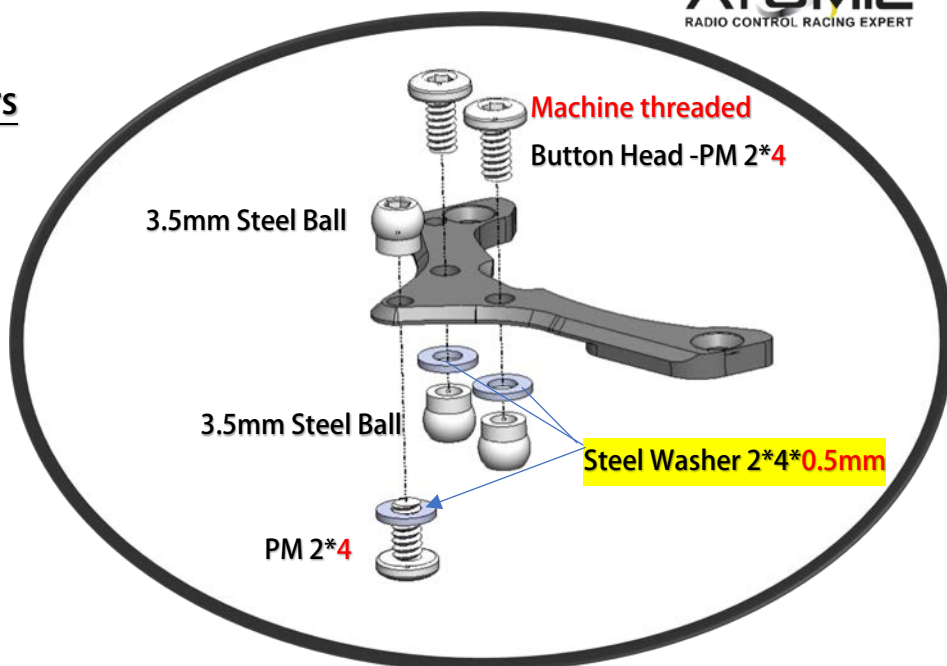

18 Center Shock Damper

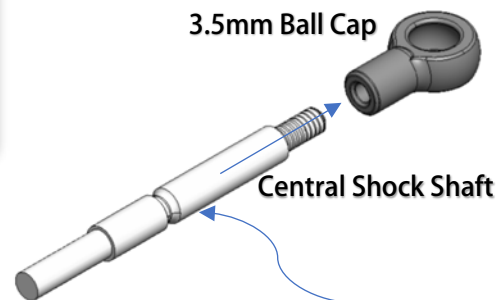
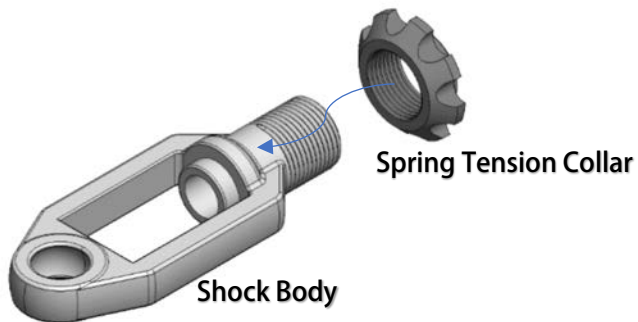

Apply #25000 or 35000 damper grease to the shaft.

Insert Small Mid Spring
(3mm long)

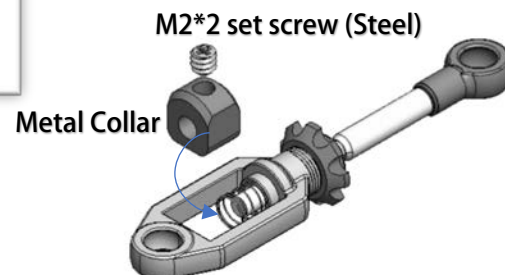
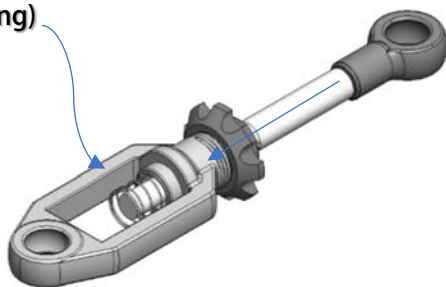

Spring support
(Plastic)

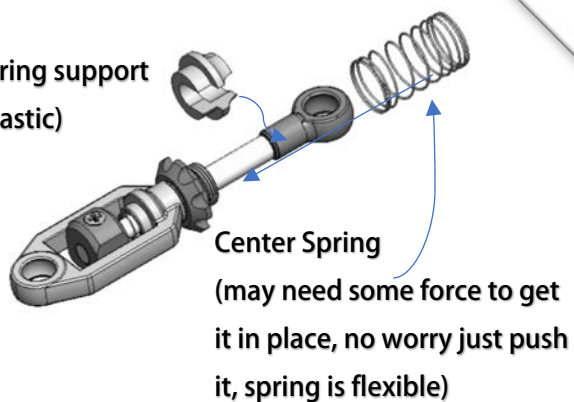

19 Center Shock Damper

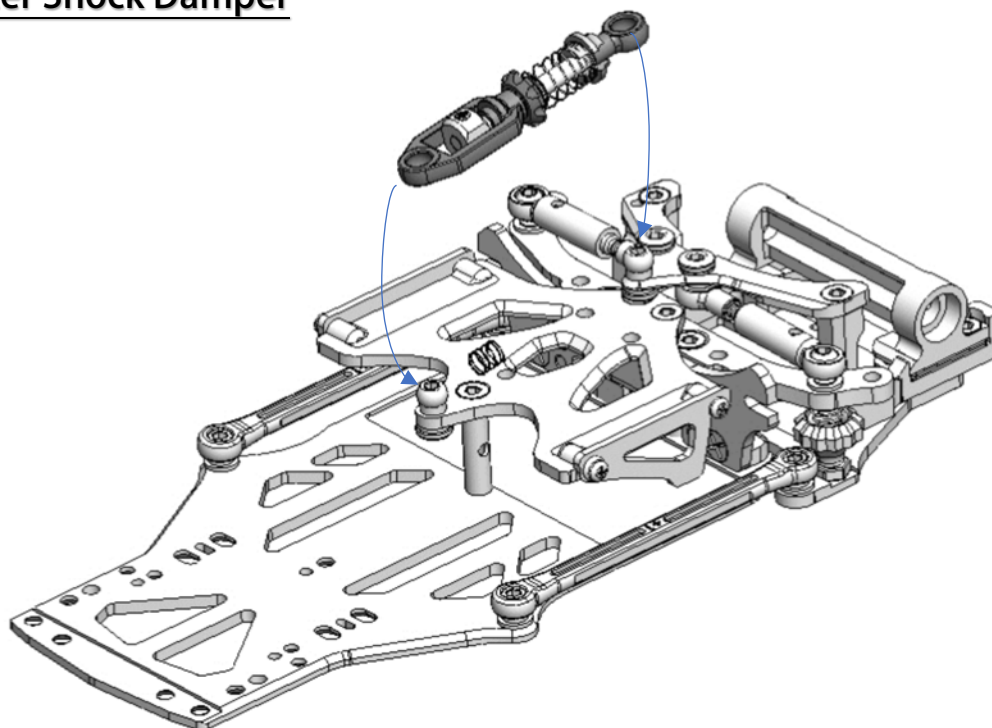

20 Servo Horn

Servo (not included)

MRZ suitable servos:
size within 20.0(W) * 18.0(L) * 8.5 (H) mm

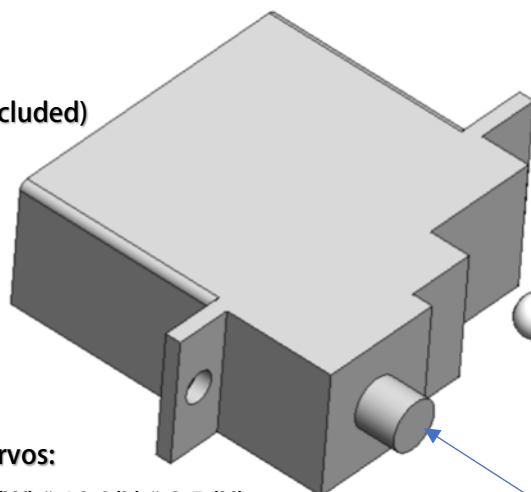

2.5mm Steel Ball Head, M1.4 thread

**** The Second Top Hole is recommended.**

Please use the screw and
servo horn that come with
the servo.

21 Servo Installation (open Bag 10)

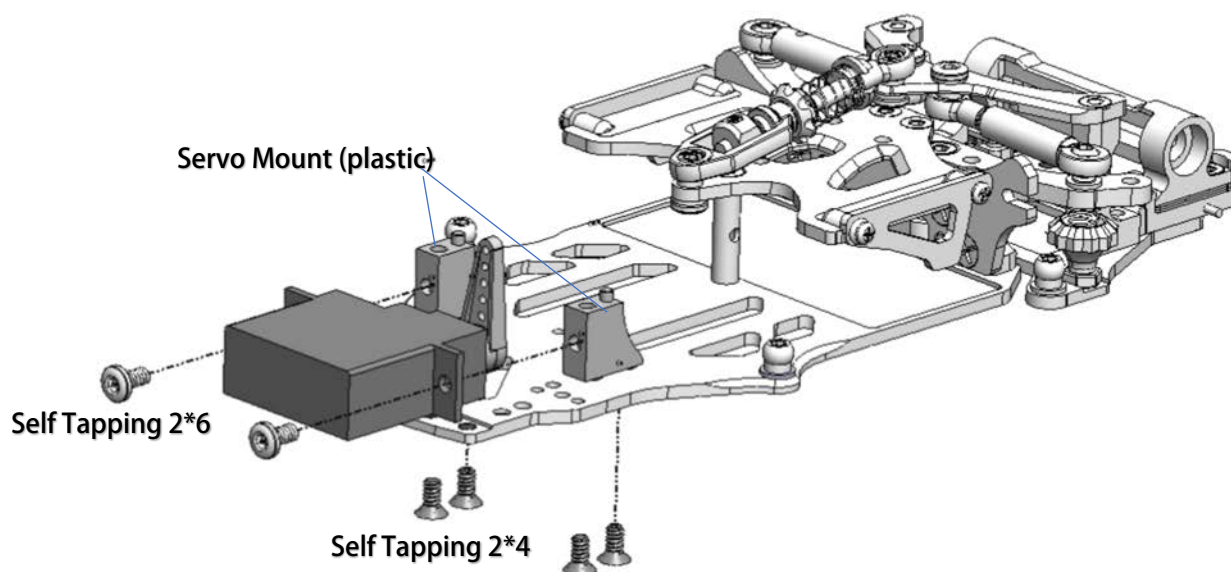

22 Lower Arms (open Bag 13)

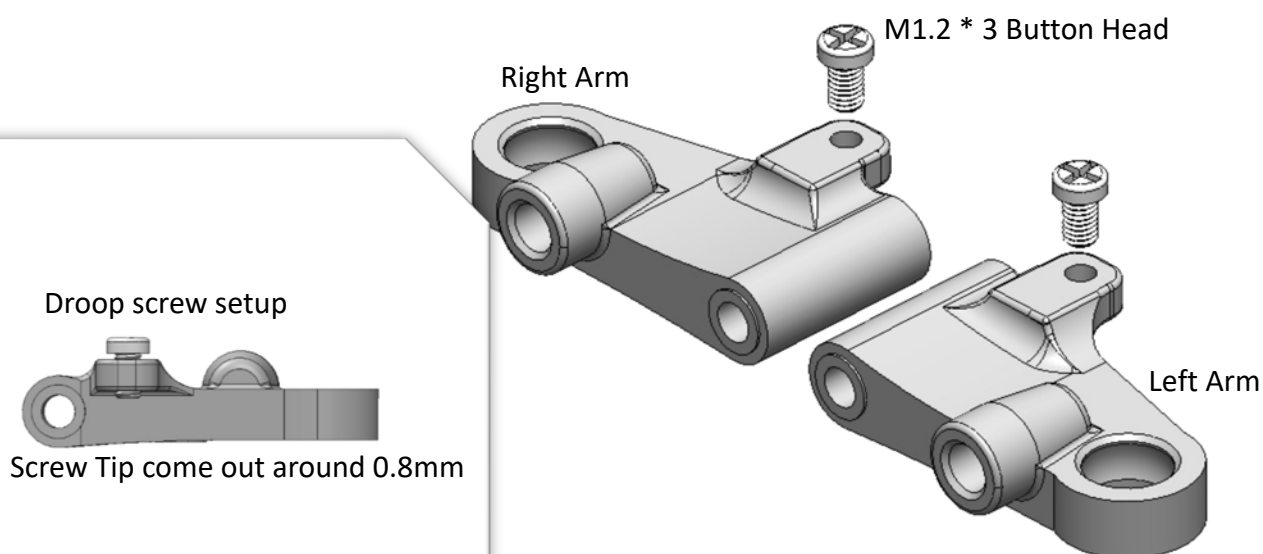

22 Lower Arms

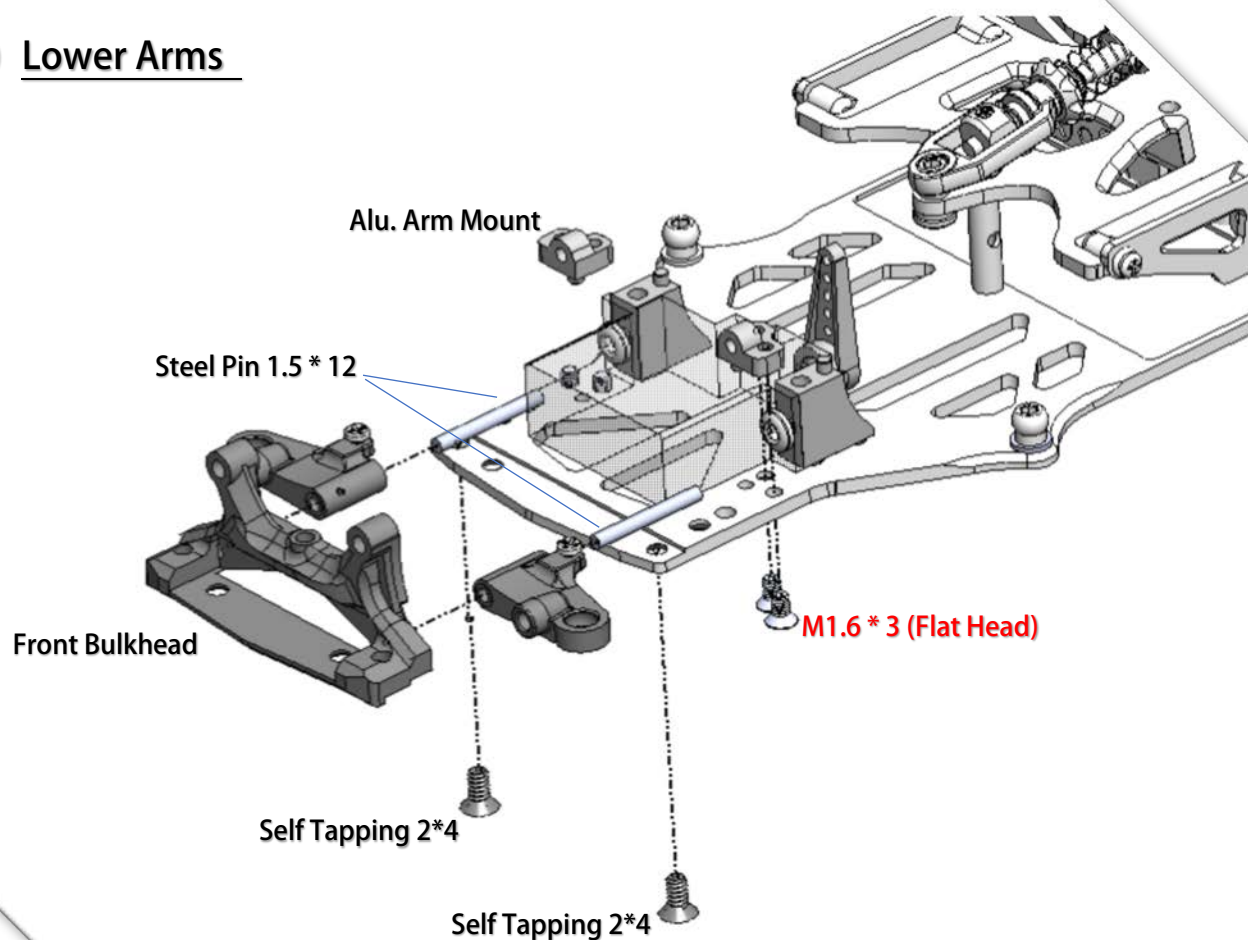

23 Upper Arm Mount

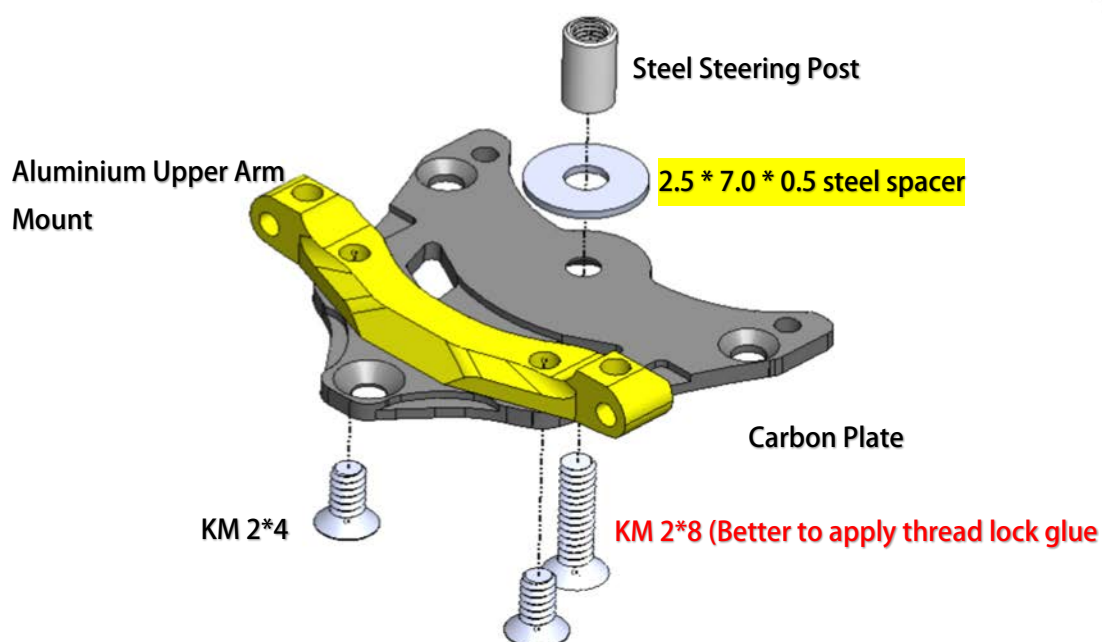

24 Install the Servo Plate

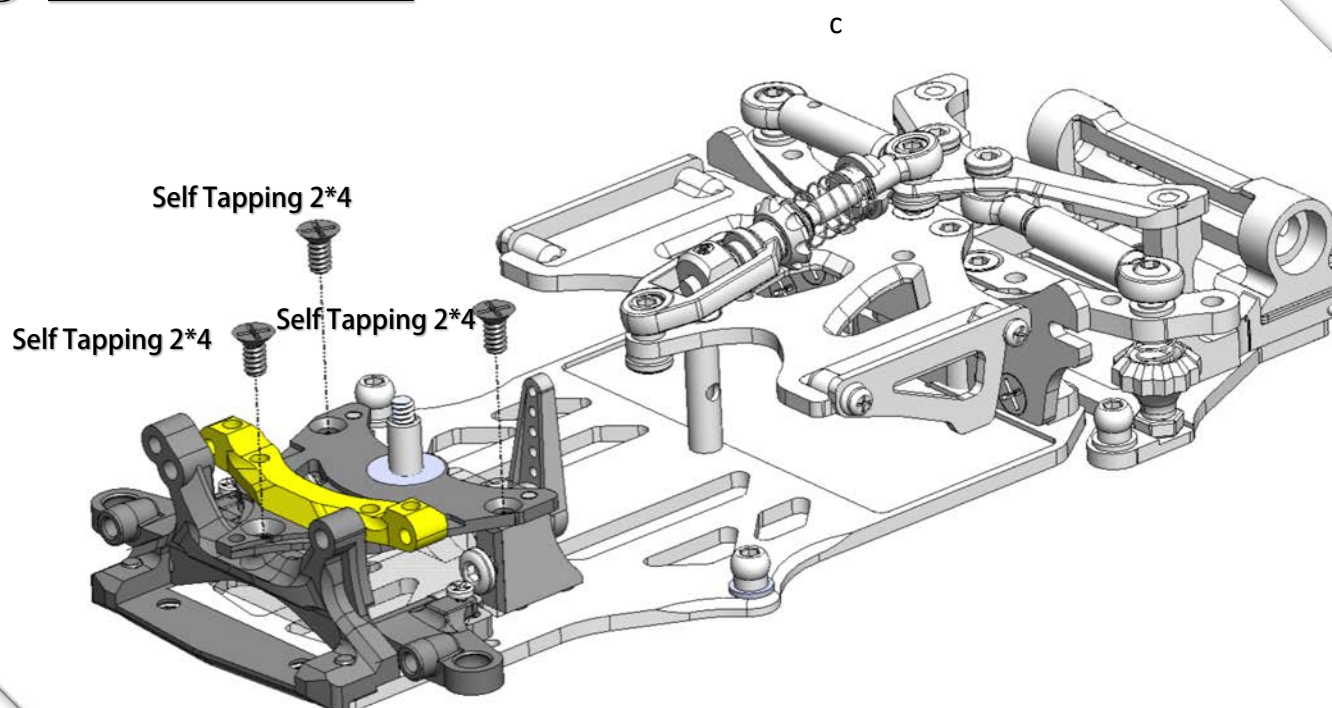

25 Steering Knuckles **Build Left and Right Knuckle as picture shown.**

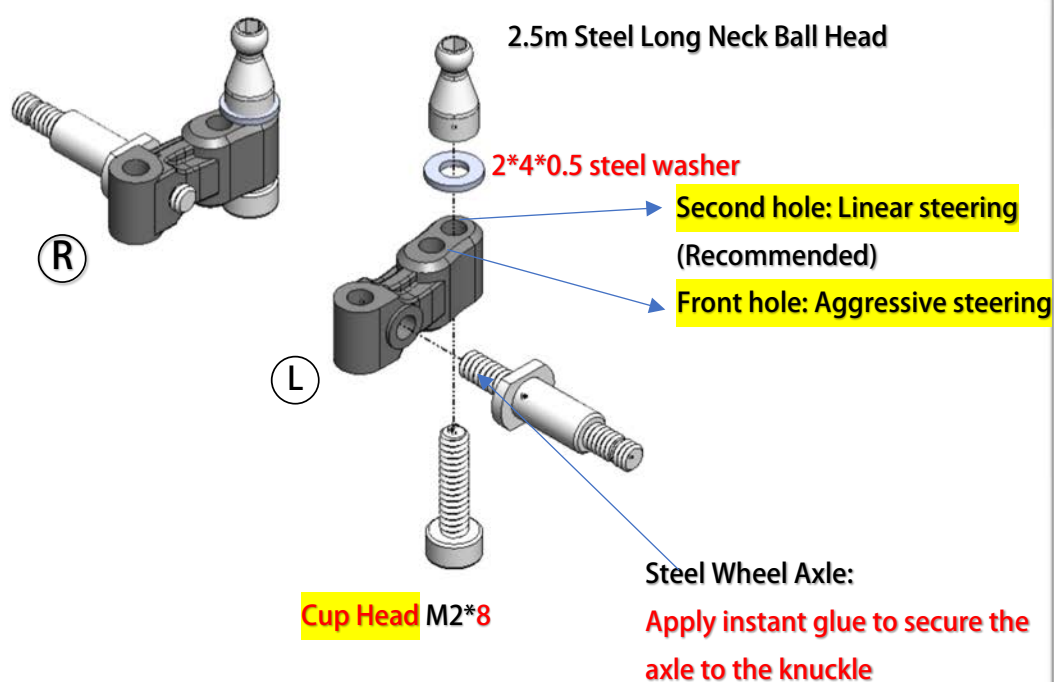

25 Steering Knuckles

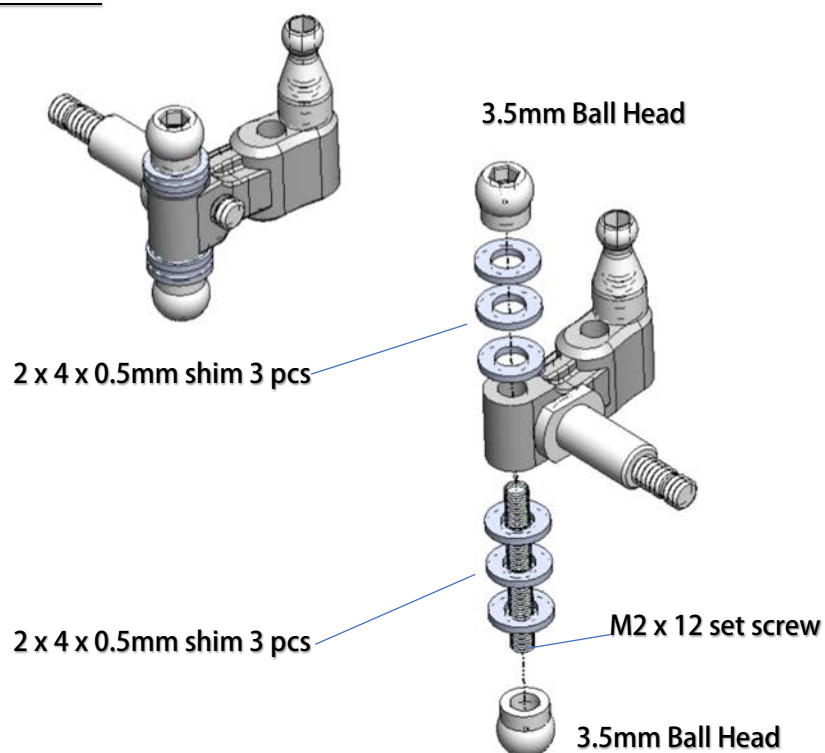

26 Upper Arms Preparation

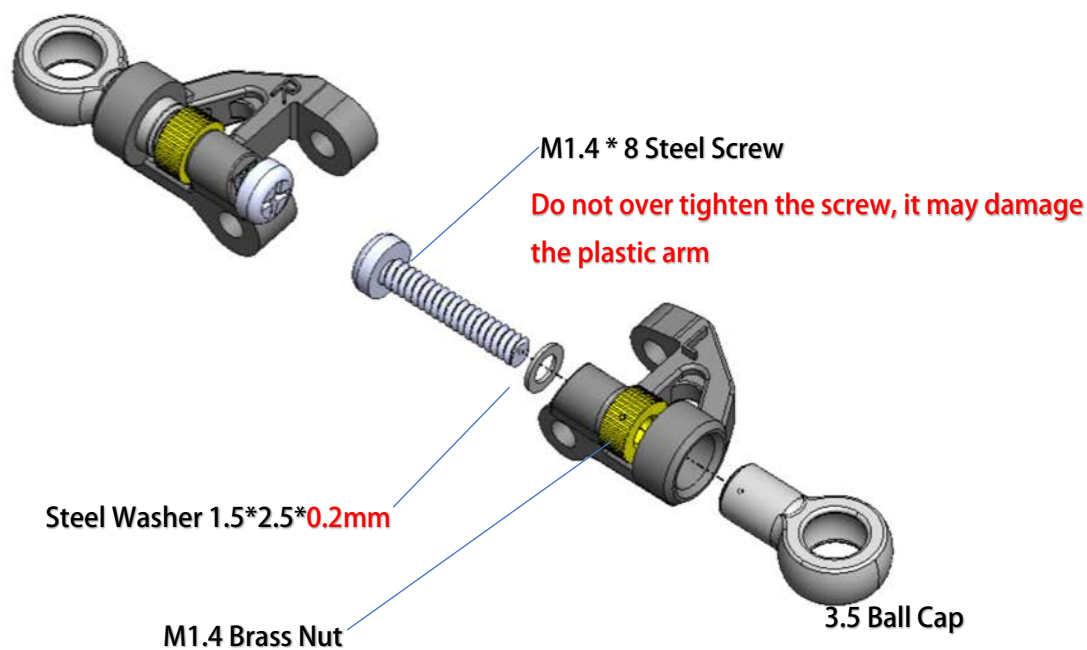

27 Upper Arms Preparation

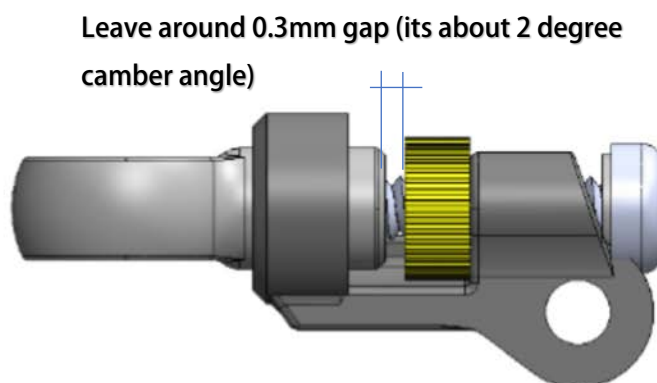

28 Upper Arms

0.05mm Steel Washer:

To eliminates wobble, if there is necessary.

1.5*10 Steel Pin

M2 *2 Set Screw

(to secure the pin, remove wobble)

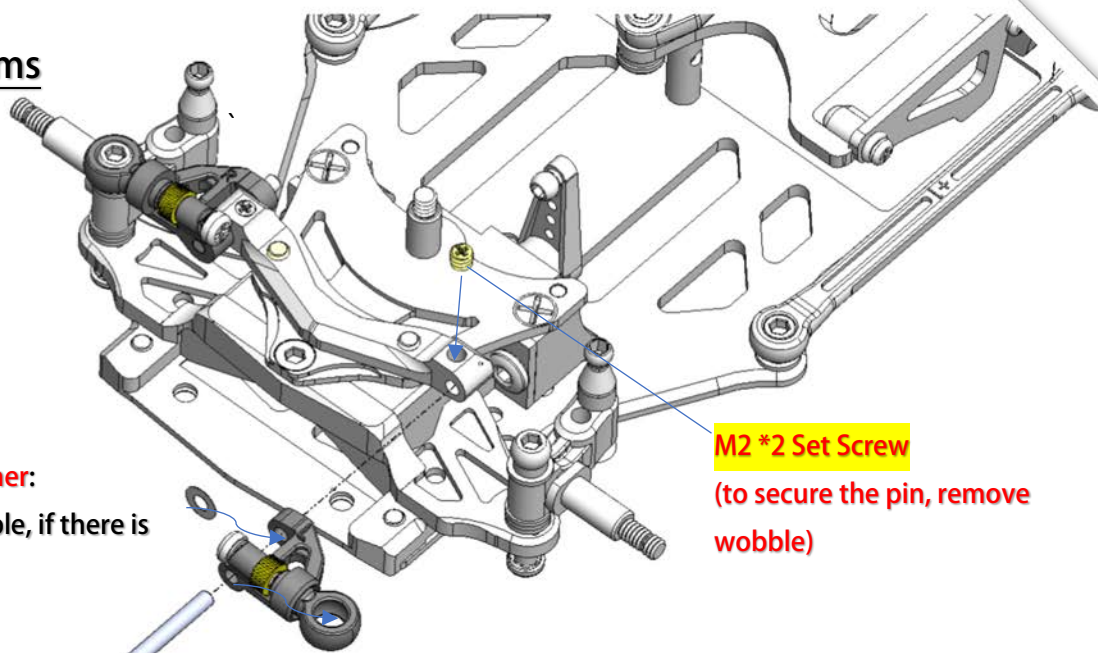

29 Steering Crank

3*6*2 Bearing

2.5mm Steel Ball Head

2.5mm Steel Ball Head

Steering Crank (Plastic)

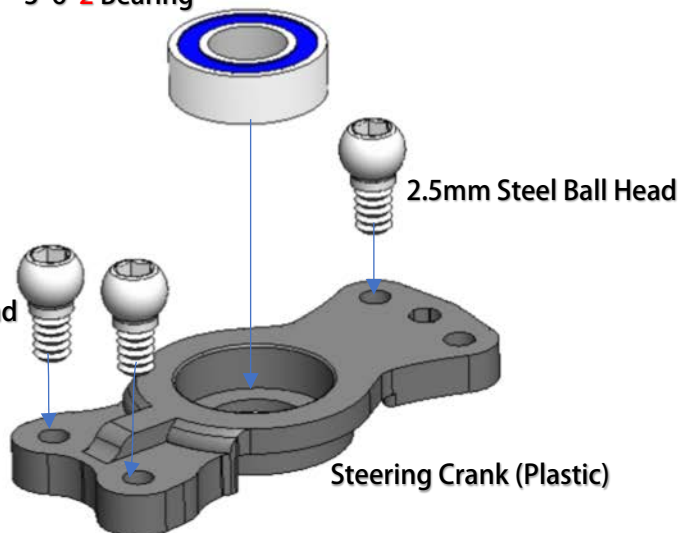

30 Installing Steering Crank

Tighten the Nylon nut slowly, adjust it and make sure the crank rotates smooth and no wobble.

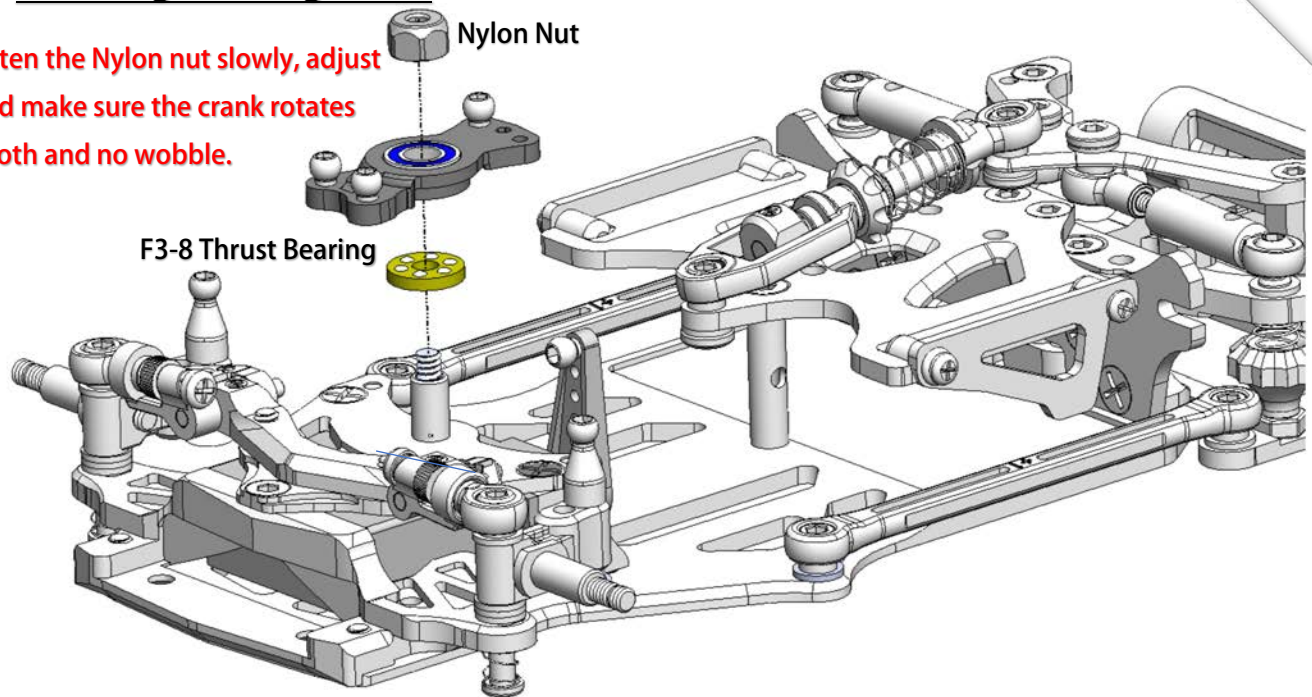

31 Steering Linkages

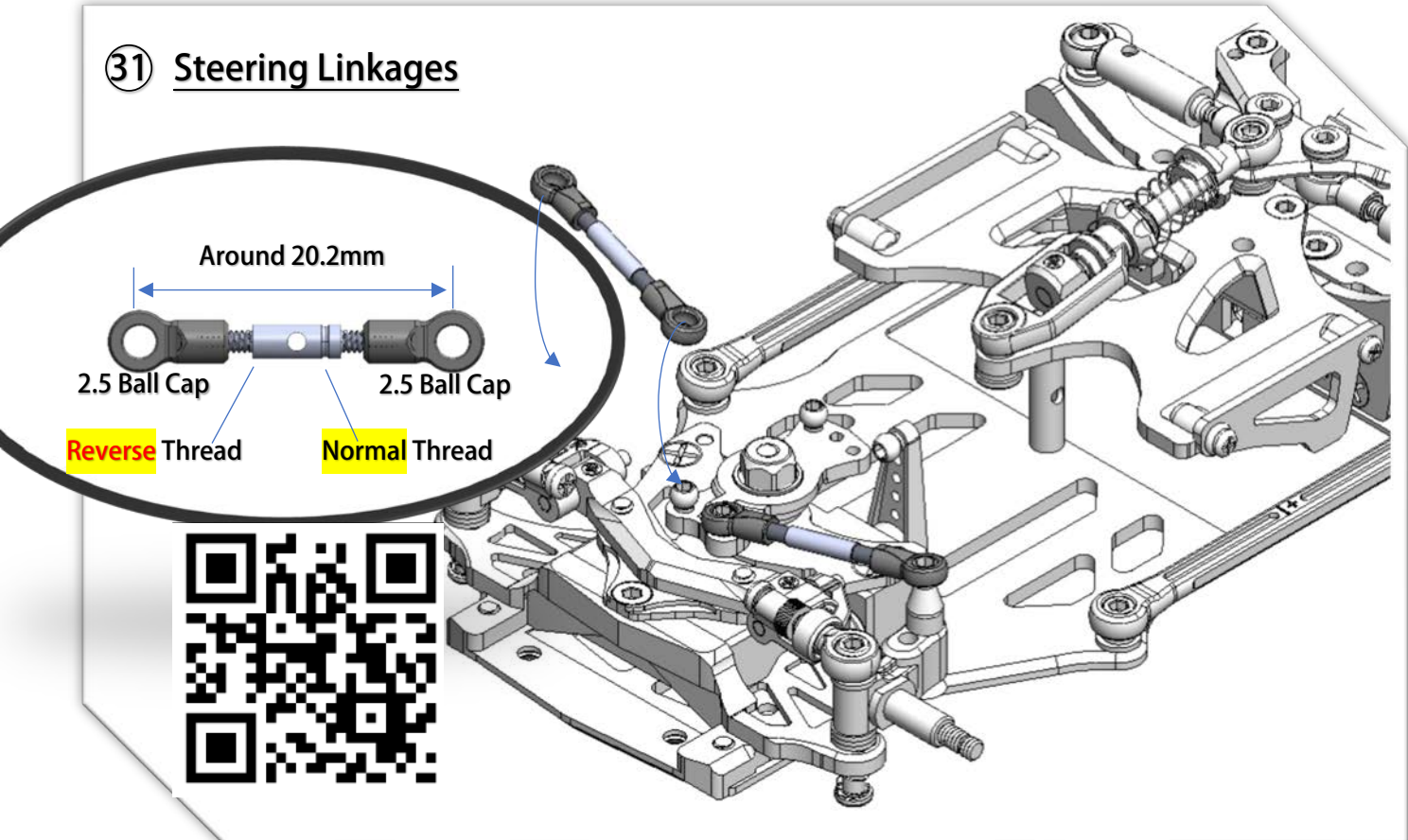

YouTube **Video:** Scan this QR Code to see how to make the ball link Smooth and no wobble.

https://www.youtube.com/watch?feature=youtu.be&v=RMhkoIUS_og

32 Servo Linkage

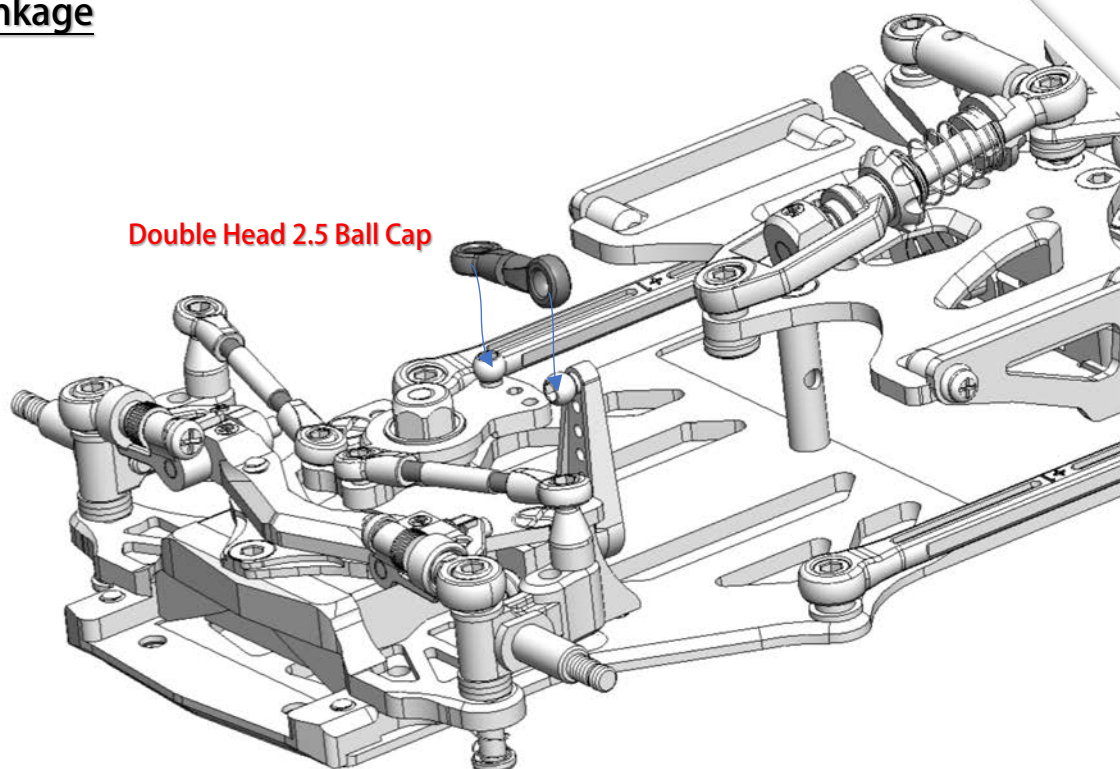

33 Gear Differential (open Bag 11)

Right Wheel Hub (plastic)

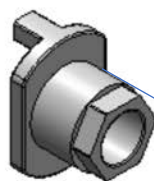

Diff Housing

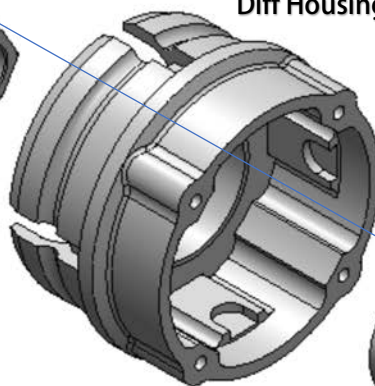

5 x 8 x 2 Bearing

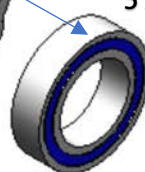

34 Gear Differential

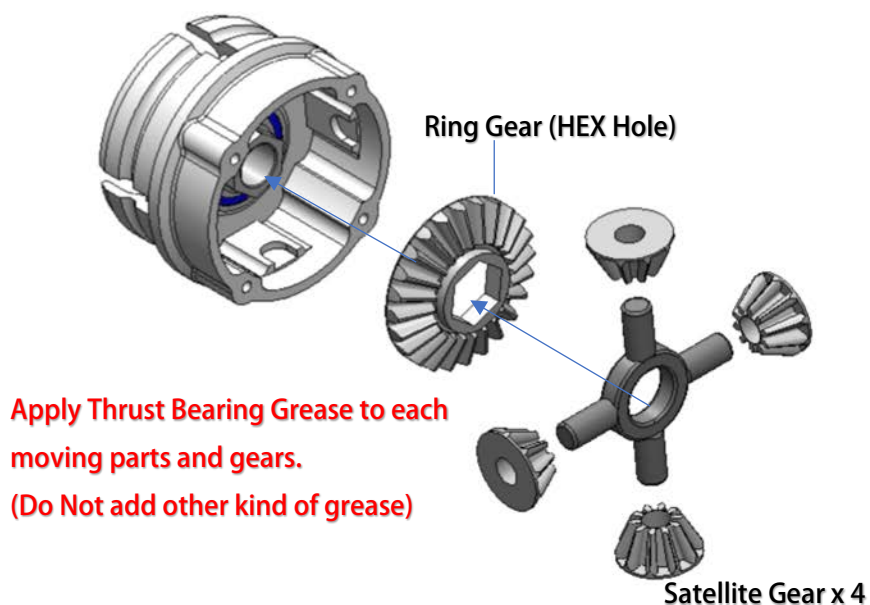

35 Gear Differential

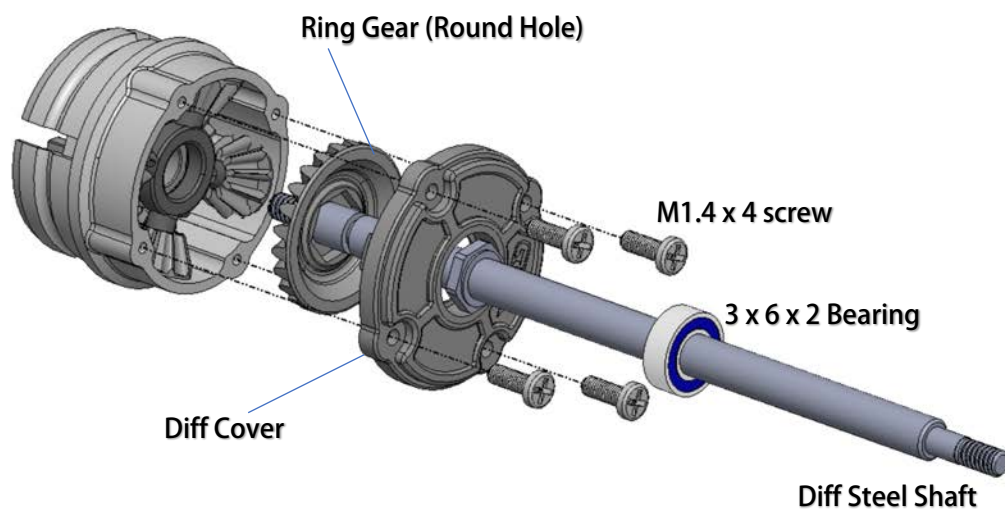

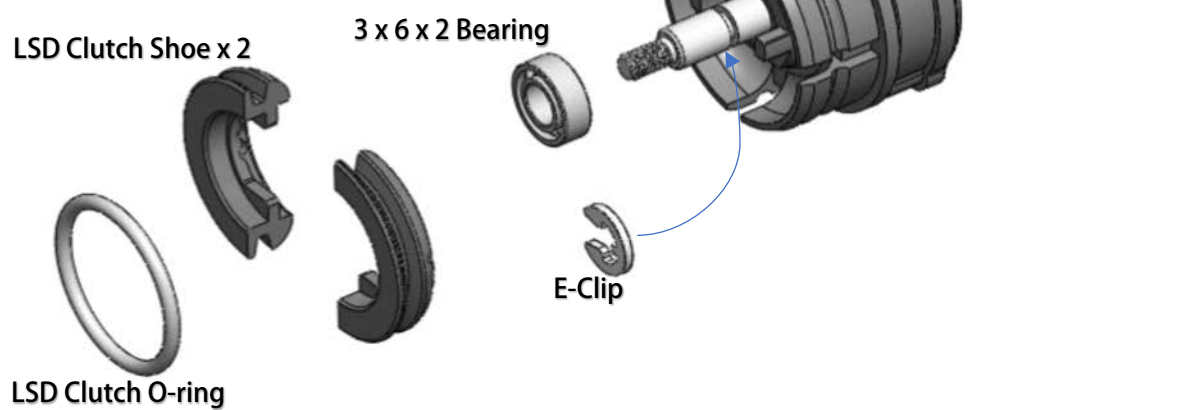
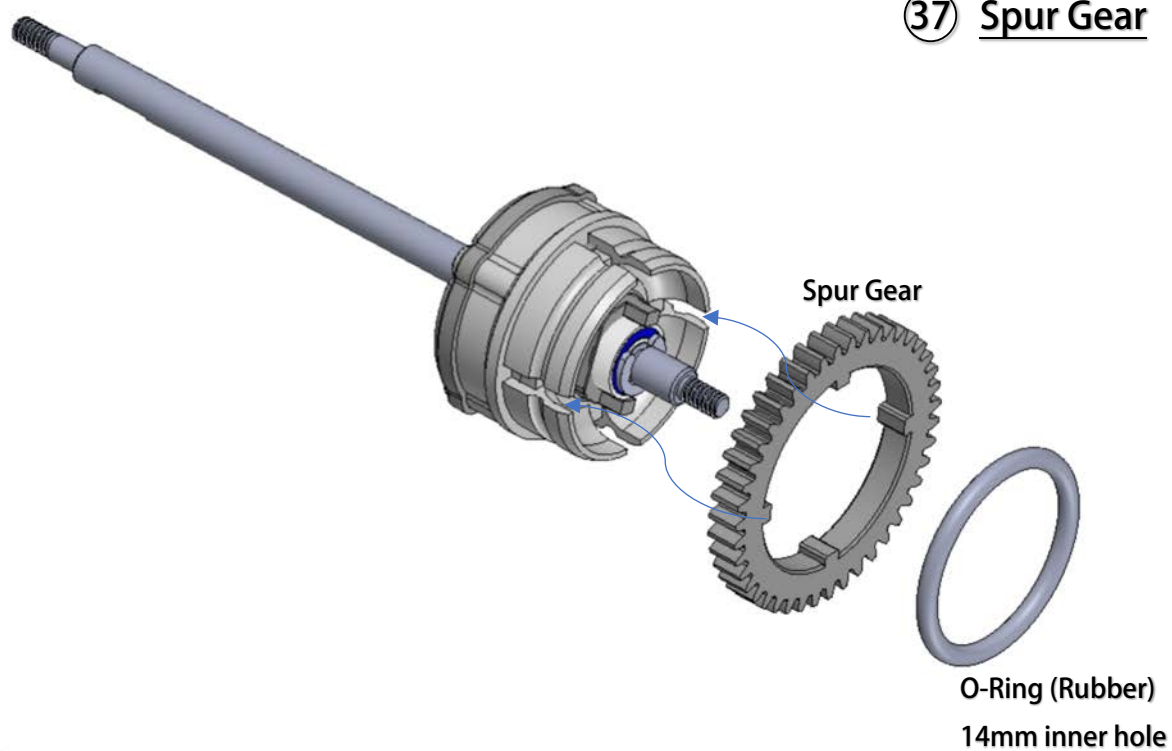
36 LSD Clutch**36** Gear Differential**37** Spur Gear

38 Install the Differential

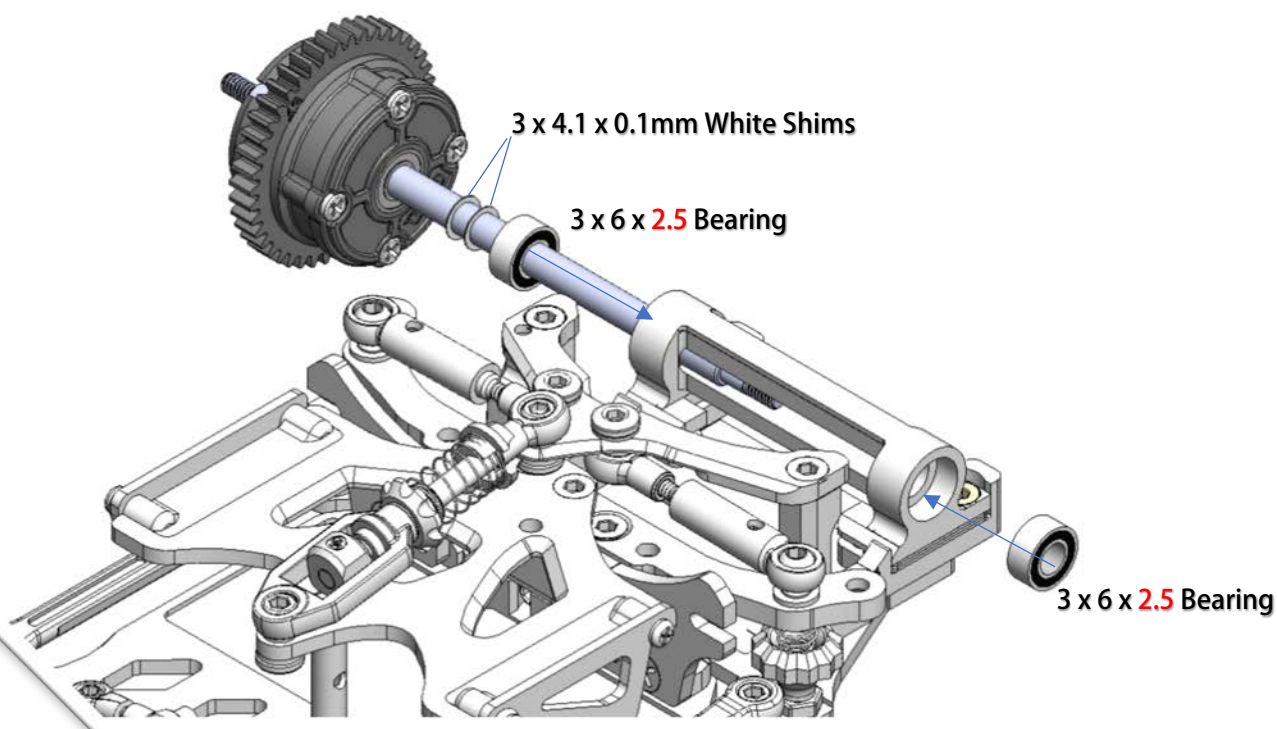

39 Wheel Adaptor

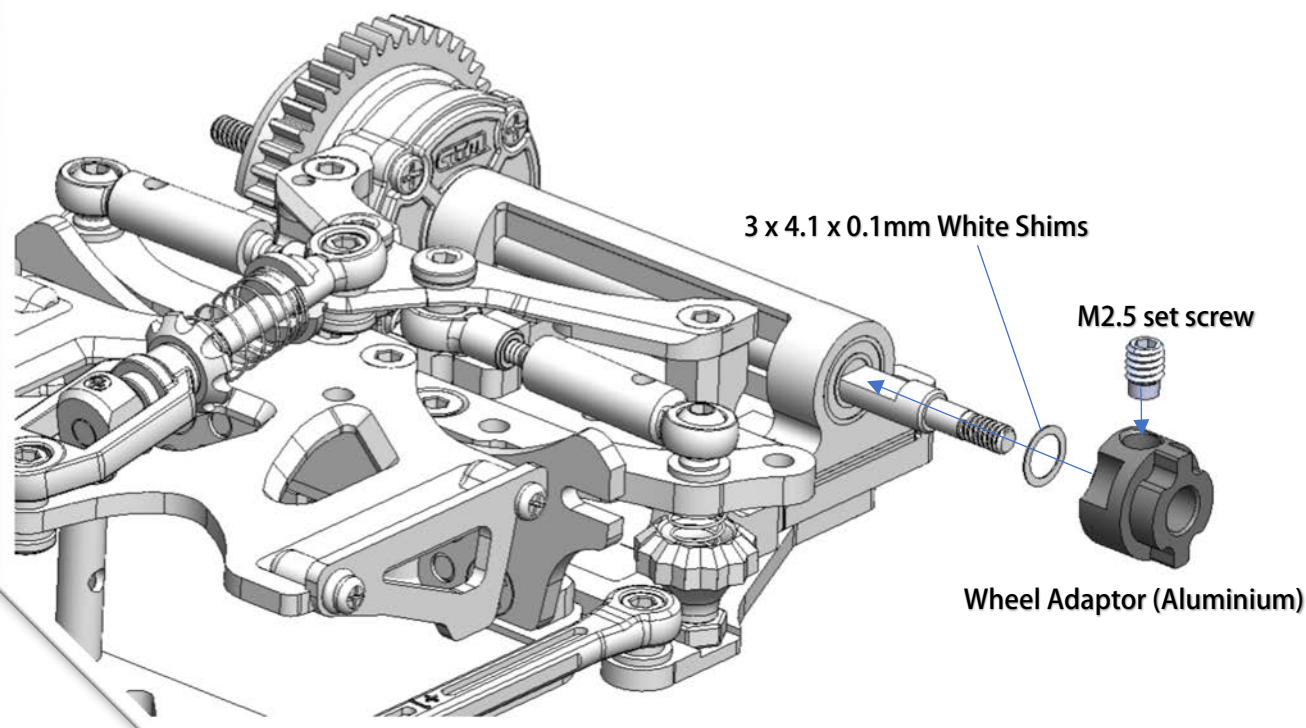

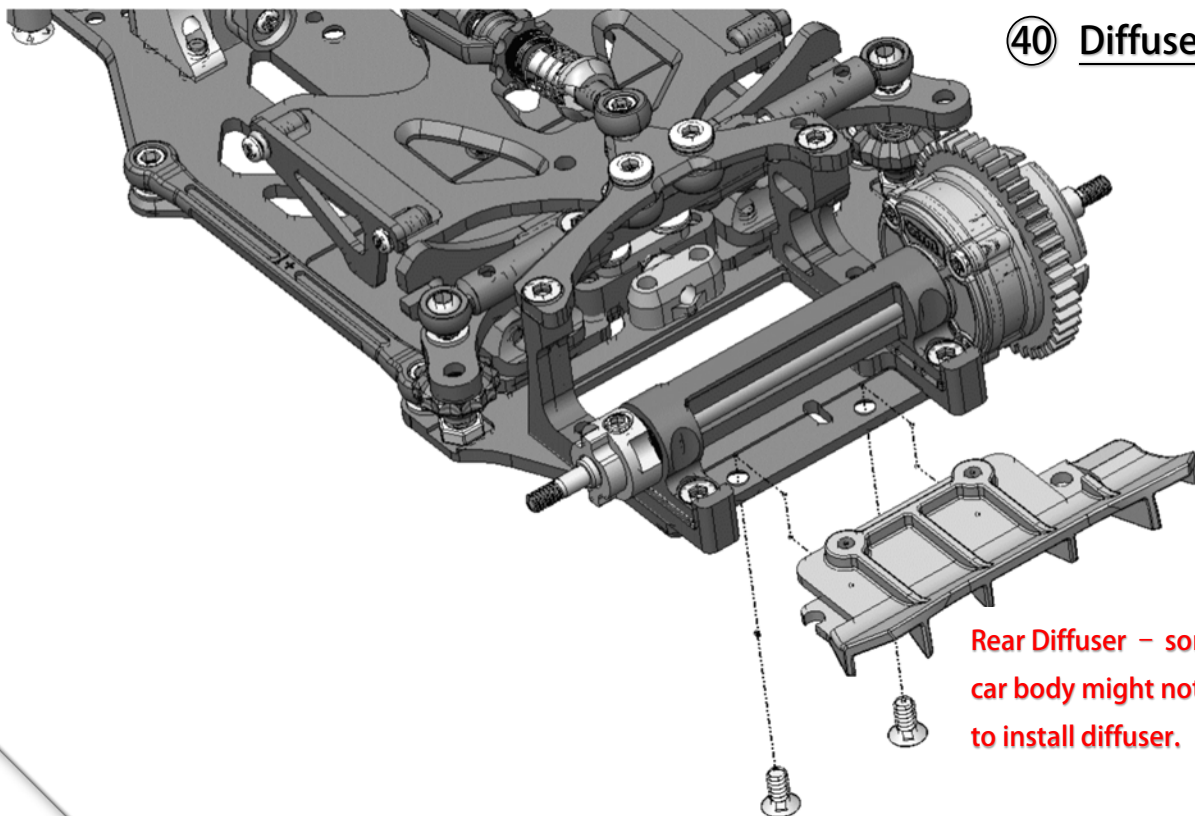
40 Diffuser

Rear Diffuser – some of the car body might not be able to install diffuser.

Hex Flat Head M2*4

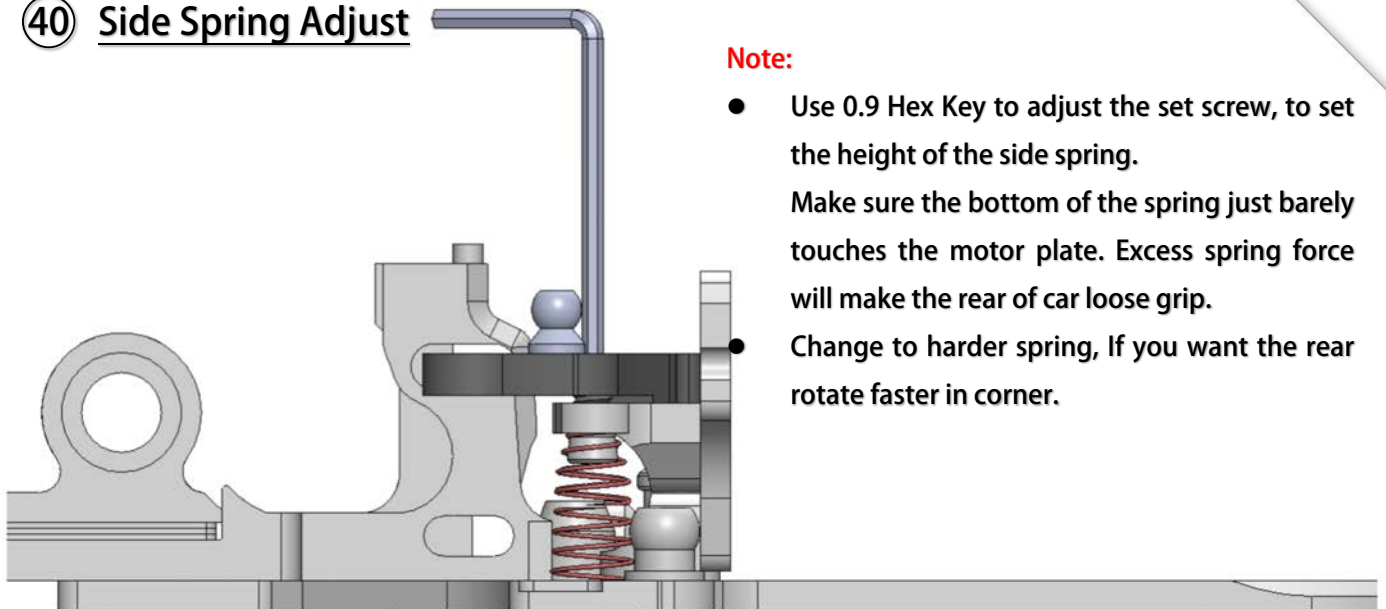
40 Side Spring Adjust**Note:**

- Use 0.9 Hex Key to adjust the set screw, to set the height of the side spring.
Make sure the bottom of the spring just barely touches the motor plate. Excess spring force will make the rear of car loose grip.
- Change to harder spring, If you want the rear rotate faster in corner.

41 Prepare the Dampers.

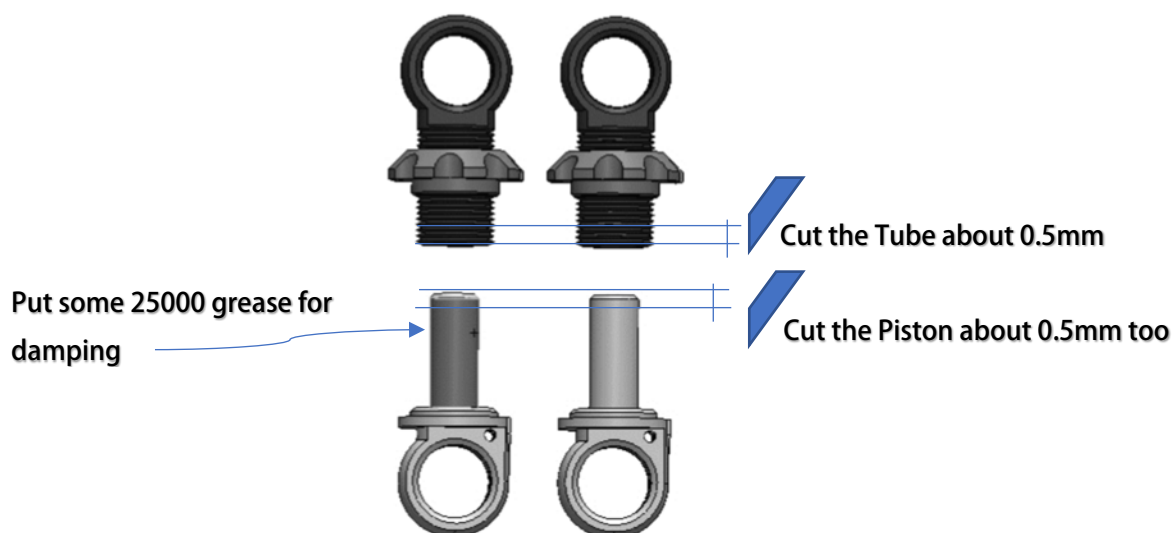
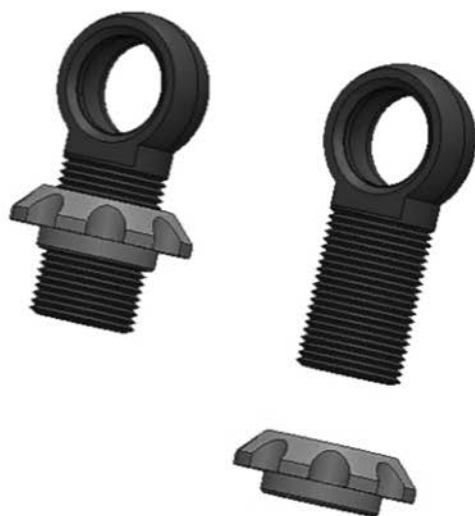

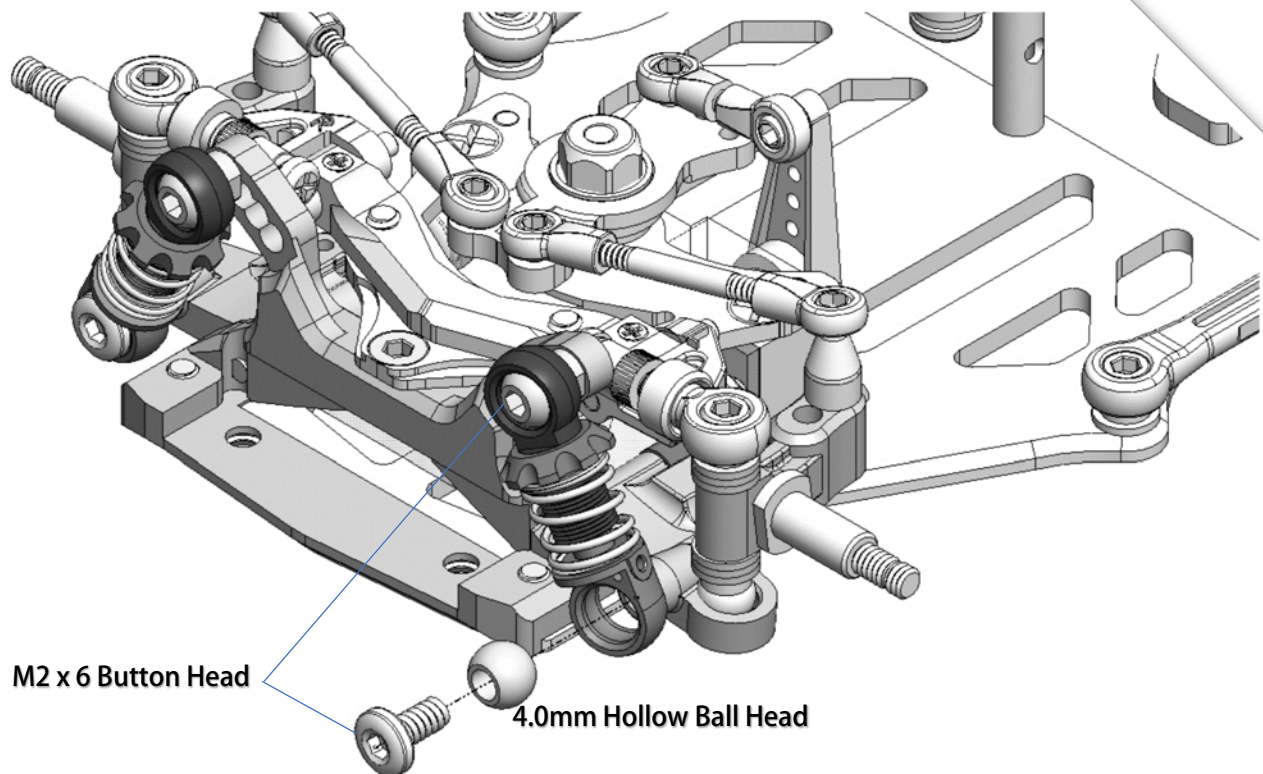

④② Install the Dampers

④③ Adjust Ride Height and Droop

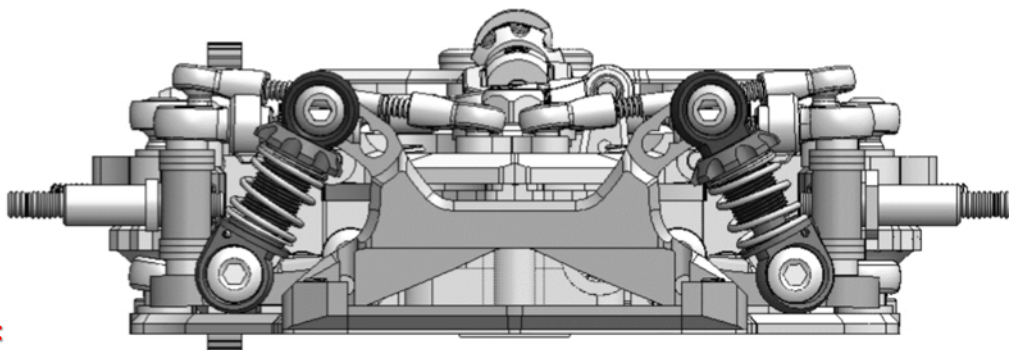

Note:

To have a good performance and stable car, the key point is to make sure there is “No droop” no matter what ride height the front it is. That means, the front arm is not able to drop down if you lift the car. Adjust it thru the “droop screw” of the lower arm to achieve this.
 (If you sway Bar is installed, the situation is different. it needs some droop to work well)

MRZ-UP01	MRZ Metal Servo Saver (M1.6 for BA-82MG)
MRZ-UP02S	MRZ Front Spring Soft (Blue)
MRZ-UP02M	MRZ Front Spring Medium (Red)
MRZ-UP02H	MRZ Front Spring Hard (White)
MRZ-UP03XS	MRZ Side Spring Extra Soft (Green)
MRZ-UP03S	MRZ Side Spring Soft (Blue)
MRZ-UP03M	MRZ Side Spring Medium (Red)
MRZ-UP03H	MRZ Side Spring Hard (White)
MRZ-UP03XH	MRZ Side Spring Extra Hard (Yellow)
MRZ-UP04S	MRZ Mid Spring Soft (Red)
MRZ-UP04M	MRZ Mid Spring Medium (White)
MRZ-UP04H	MRZ Mid Spring Hard (Yellow)
MRZ-UP05	Spacer for Motor Pod (0.3mm) 6 pcs
MRZ-UP06	Spacer for Front Body Mount (0.5mm) 2 pcs
MRZ-UP07	MRZ Double A-Arm Conversion Kit
MRZ-UP07P1	DWS Spare Lower Arms w/ Pin
MRZ-UP07P2	DWS Optional Spring Set
MRZ-UP07P3	DWS Damper Shock
MRZ-UP08	MRZ Alu. Servo Mount
MRZ-UP09	MRZ Alu. Knuckle
MRZ-UP10	MRZ Alu. Upper Arm
MRZ-UP11	MRZ Alu. Central Mount
MRZ-UP12G	MRZ Alu. Steering Crank (Gold)
MRZ-UP12K	MRZ Alu. Steering Crank (Black)
MRZ-UP13	MRZ 102mm WB Motor Pod Plate
MRZ-UP14	MRZ Arm Mount Caster 2 Deg.
MRZ-UP15	MRZ Arm Mount Caster 4 Deg.
MRZ-UP16	MRZ Ball Differential
MRZ-UP17	MRZ Front Chassis Support
MRZ-UP18	MRZ Optional Long Dampers
MRZ-UP19	MRZ Optional Delrin Side Spring Adjuster
MRZ-UP20	Spacer for Front Ride Height (0.25mm)
MRZ-UP21	MRZ Light weight Mid Damper Shaft
MRZ-UP22	MRZ Rear Body Post

MRZ V1.1 Instruction Manual

MRZ-UP23	MRZ Delrin Pivot Base Set (Adjustable WB)
MRZ-UP24-10	Hard Coated 64DP Pinion 10T (MRZ)
MRZ-UP24-11	Hard Coated 64DP Pinion 11T (MRZ)
MRZ-UP24-12	Hard Coated 64DP Pinion 12T (MRZ)
MRZ-UP24-13	Hard Coated 64DP Pinion 13T (MRZ)
MRZ-UP24-14	Hard Coated 64DP Pinion 14T (MRZ)
MRZ-UP24-CB	Hard Coated 64DP Pinion Set 10-14T (MRZ)
MRZ-UP25	Brass Motor Mount Plate (98WB)
MRZ-UP26	Brass Motor Mount Plate (102WB)
MRZ-UP27	DWS Aluminium Bulkhead
MRZ-UP28	MRZ Sway Bar set (Anti-Roll Bar)
MRZ-UP29	MRZ Aluminium Chassis Set