

MRZ-SF

MRZ-SF Assembly Manual

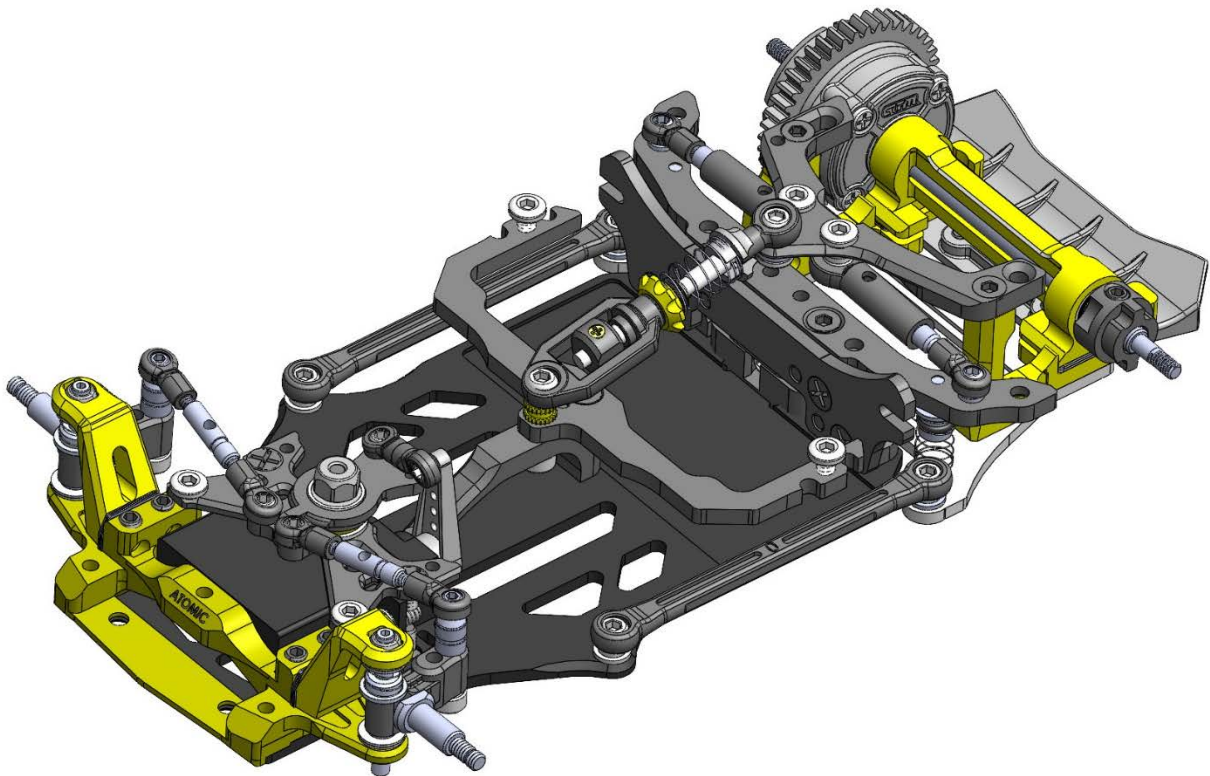

01 Chassis Center Pivot (open Bag 1 to 5)

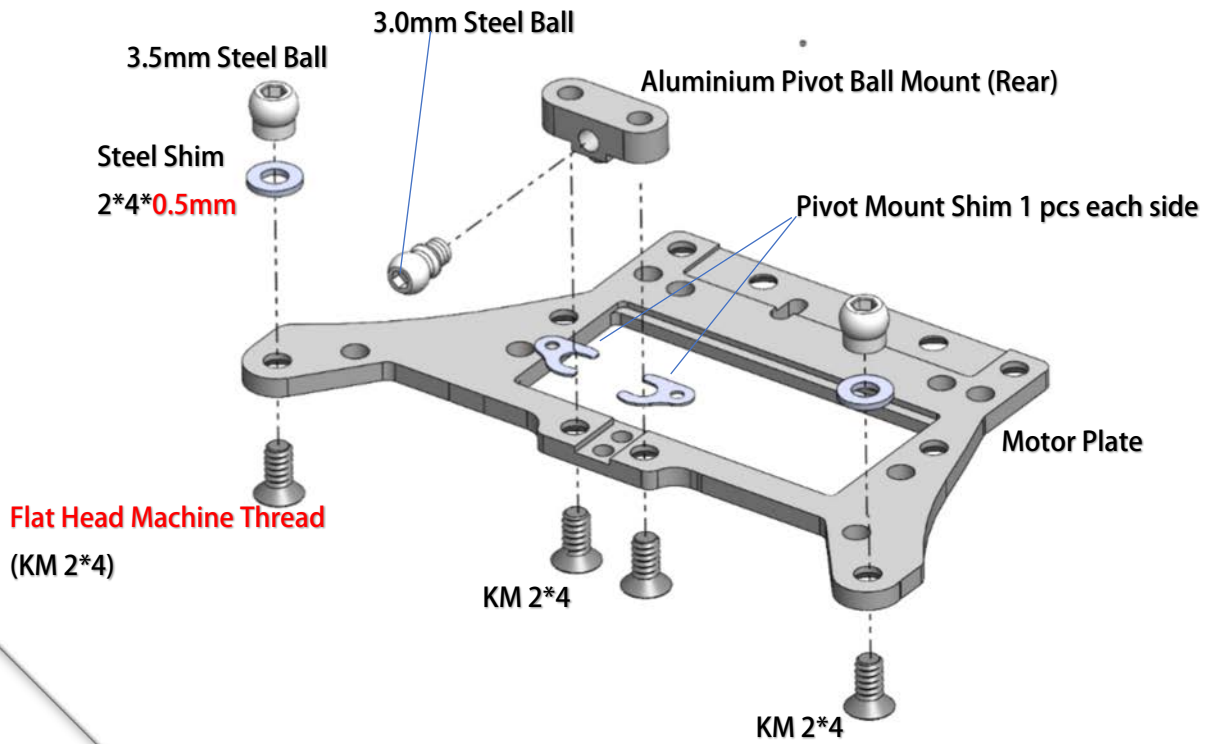

02 Chassis Center Pivot

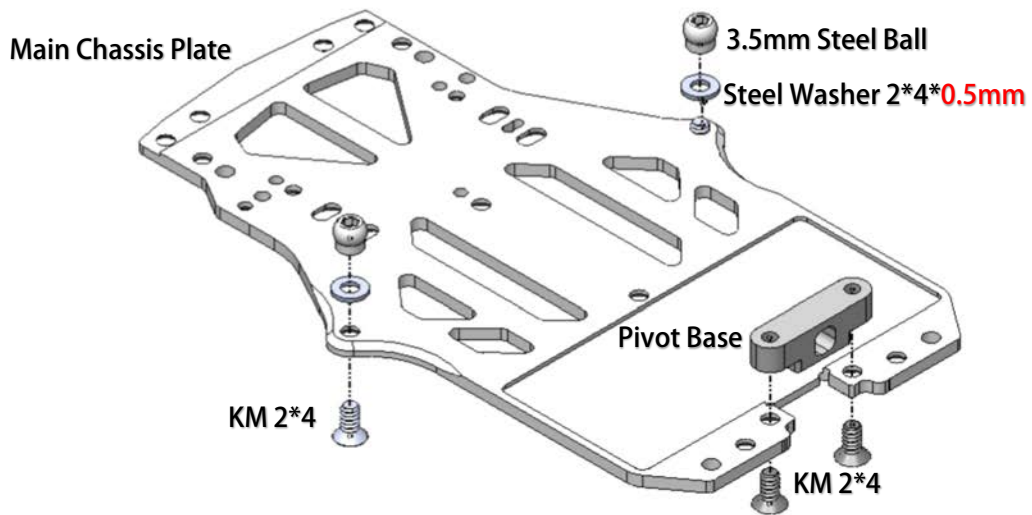

03 Side Links System

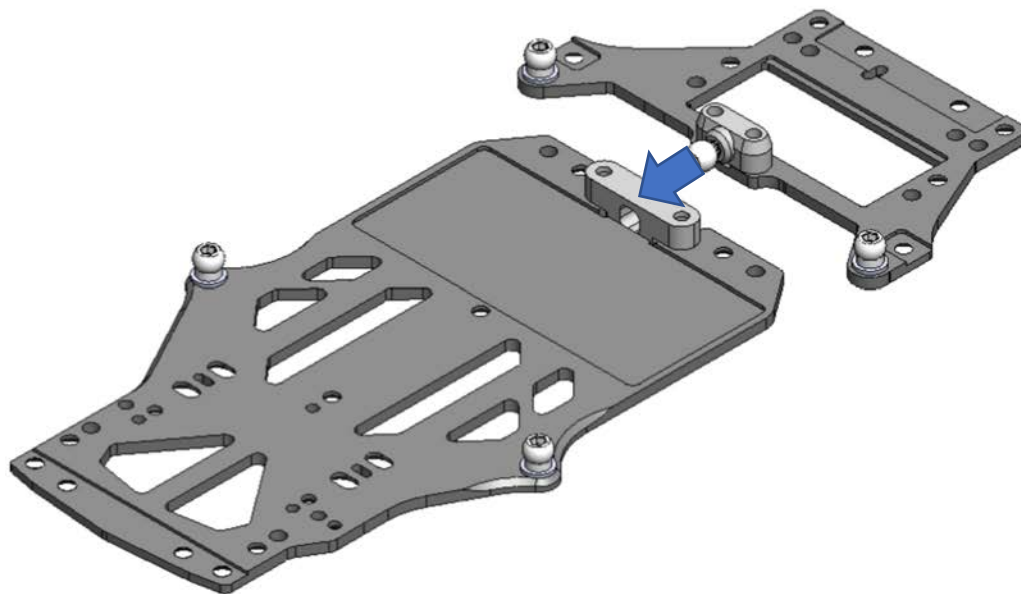

04 Fixing Side Links

YouTube video to show how to smooth and free up ball cap; please scan the QR code.

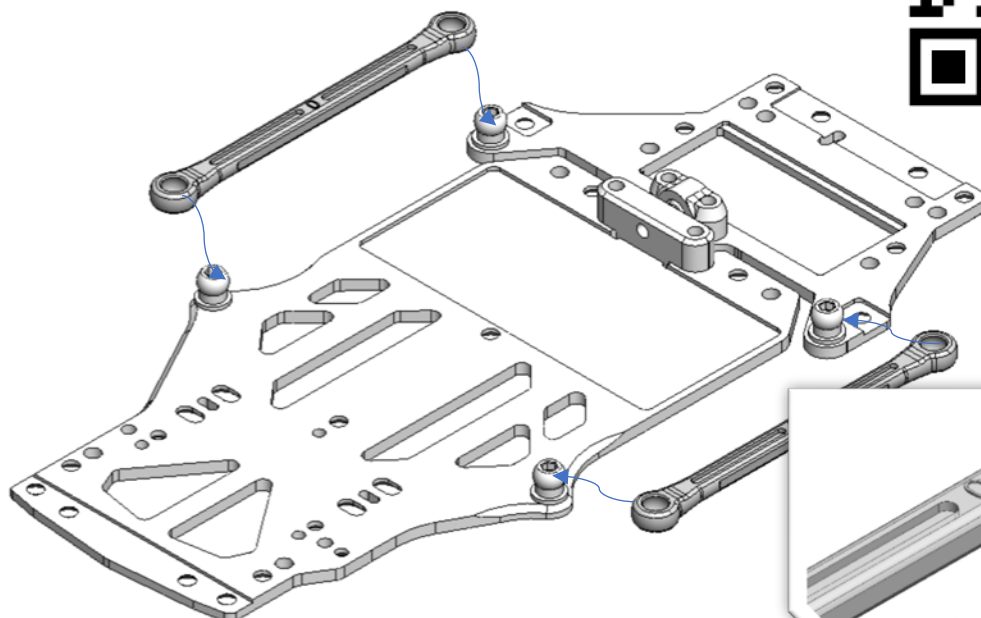

Number facing upward.

05 Side Body Mount (open Bag 06)

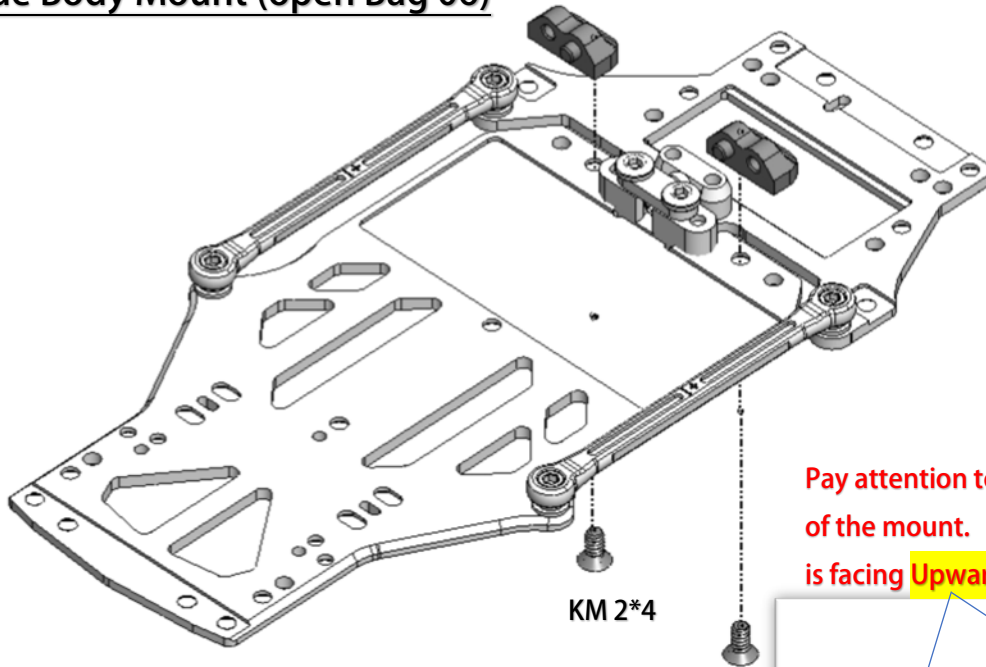

Pay attention to the orientation of the mount. "Wave shape" is facing Upward.



06 Car Body Mount Plate

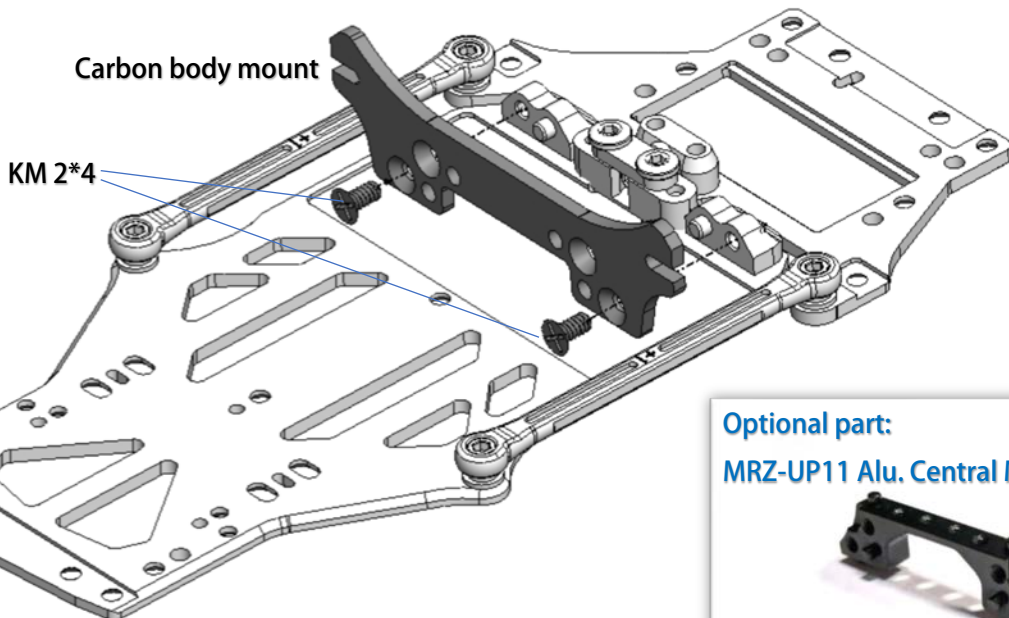

Optional part:
MRZ-UP11 Alu. Central Mount



MRZ
TOMIC

07 Car Body Mount Plate

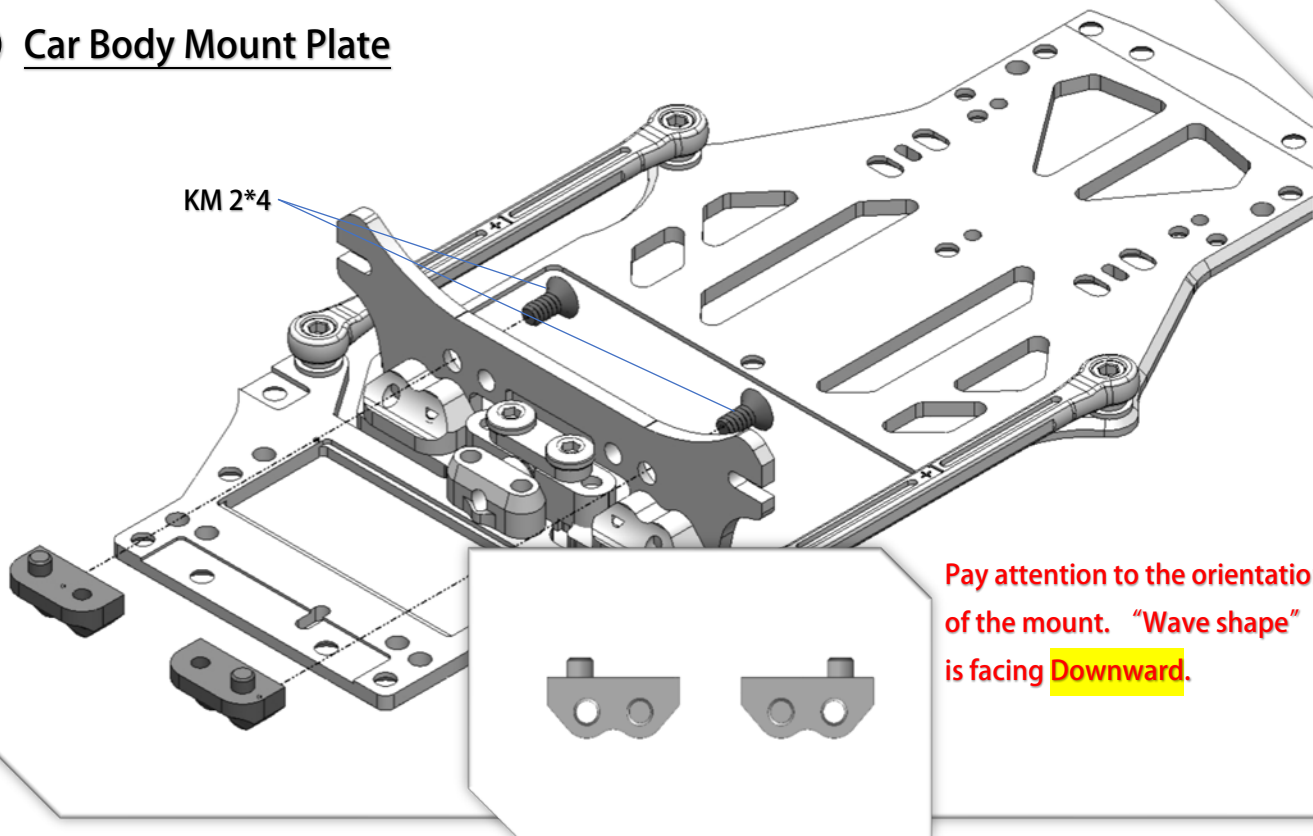

08 Motor Pod

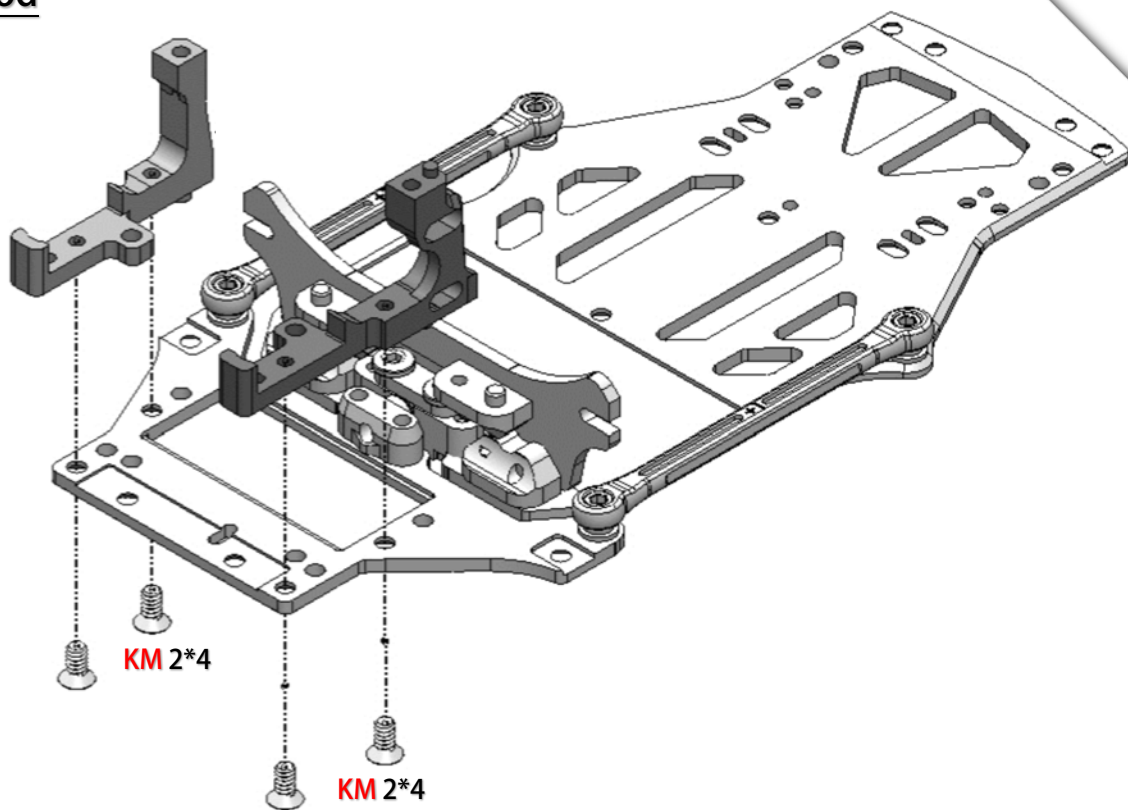

09 Ride Height Spacers

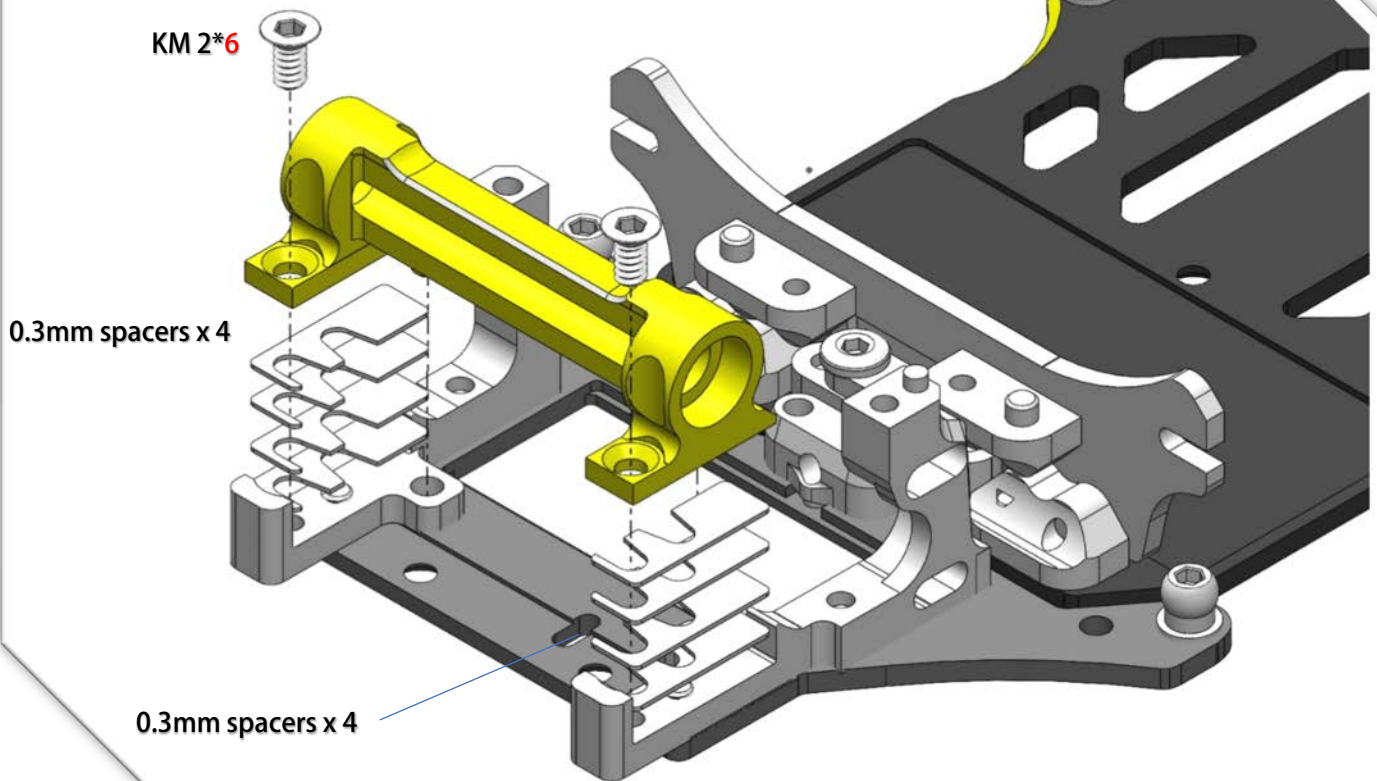

10 Side Spring Hub (open Bag 08)

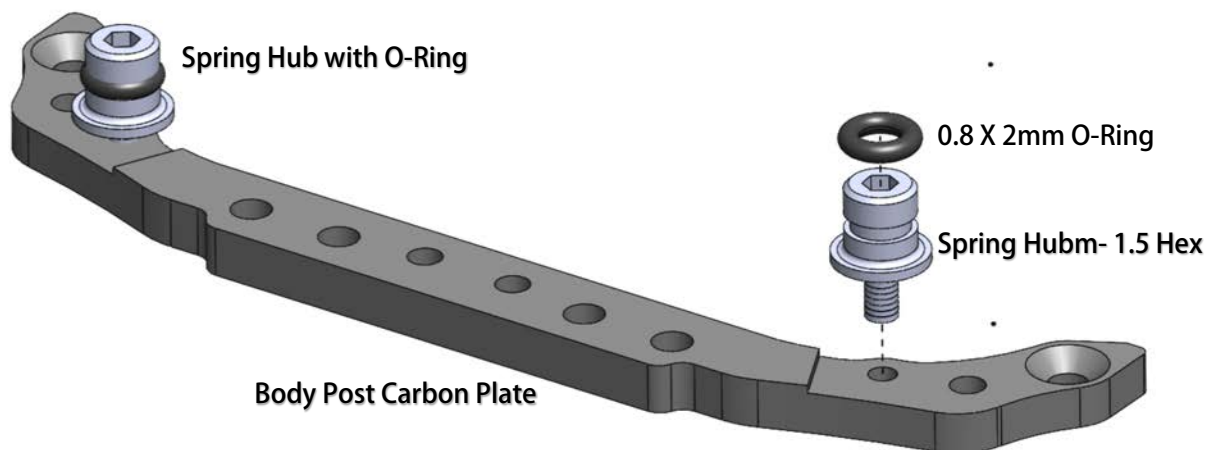

⑪ Side Spring

Put on the Spring and the O-Ring will keep it in place.

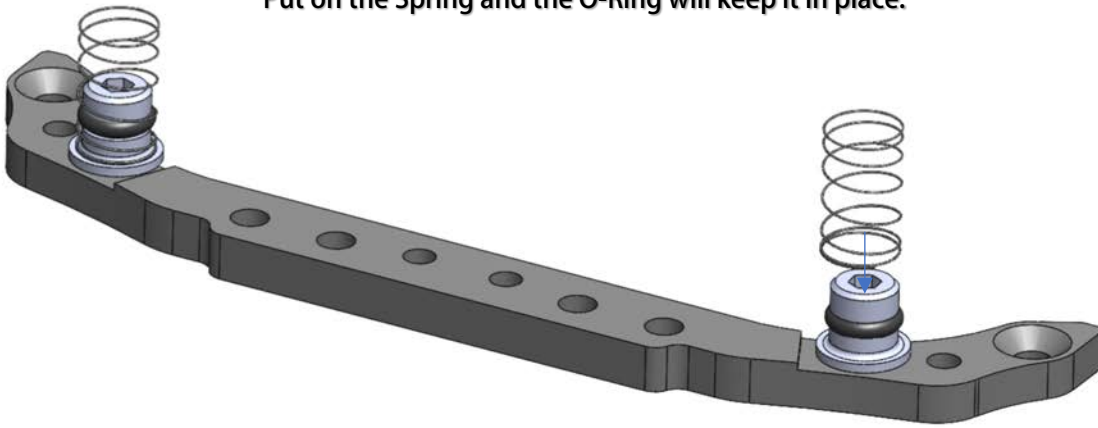

⑫ Body Post Plate

2.5 mm Ball Head- M2 Thread

KM 2*6

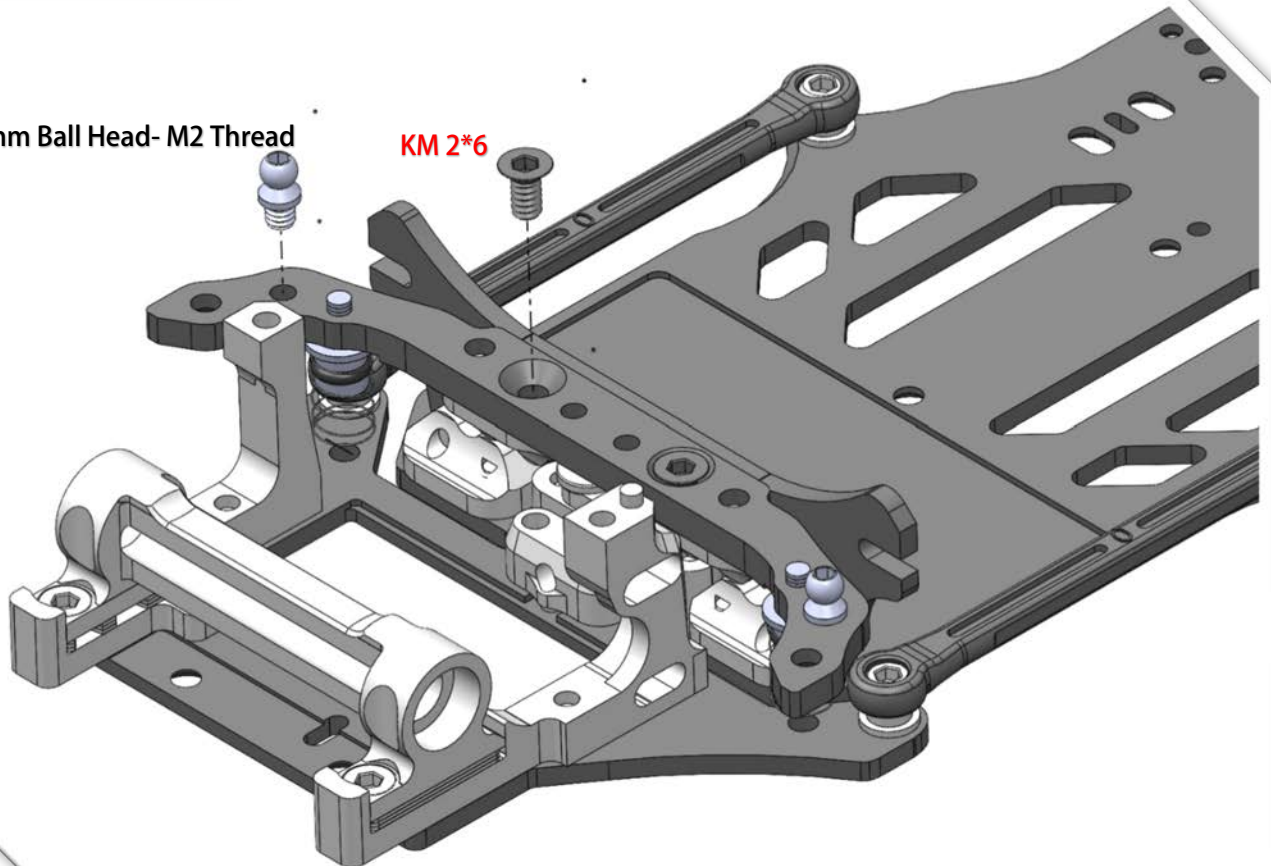

13 Middle Chassis Support and Battery Mount

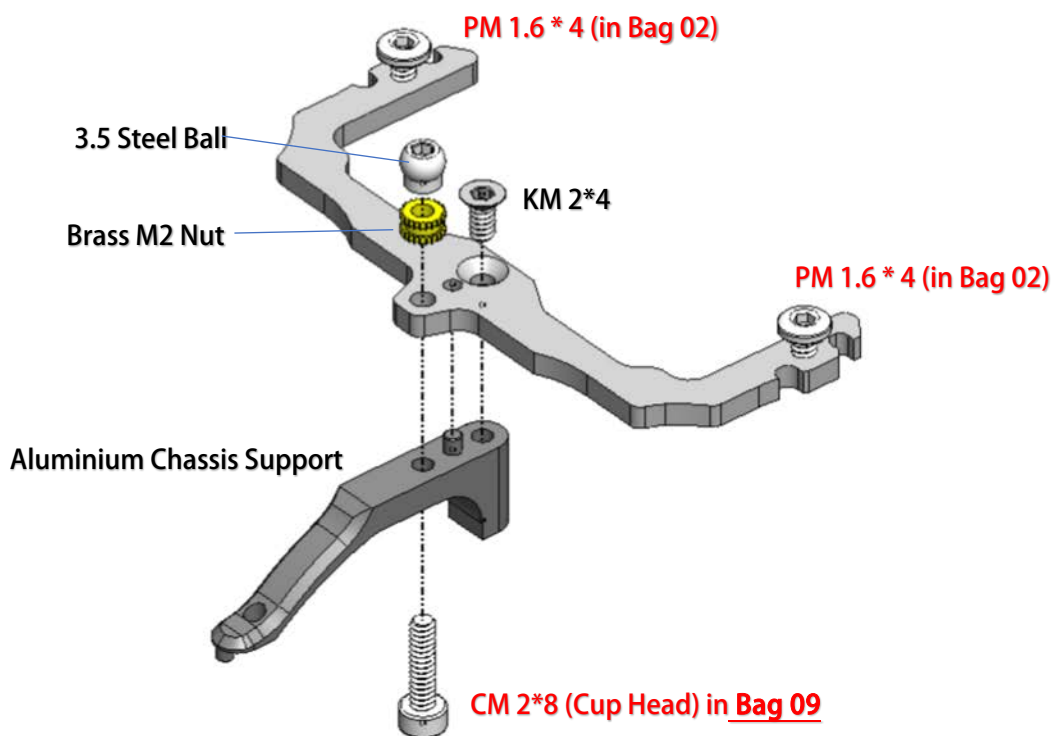

14 Fix Battery Mount

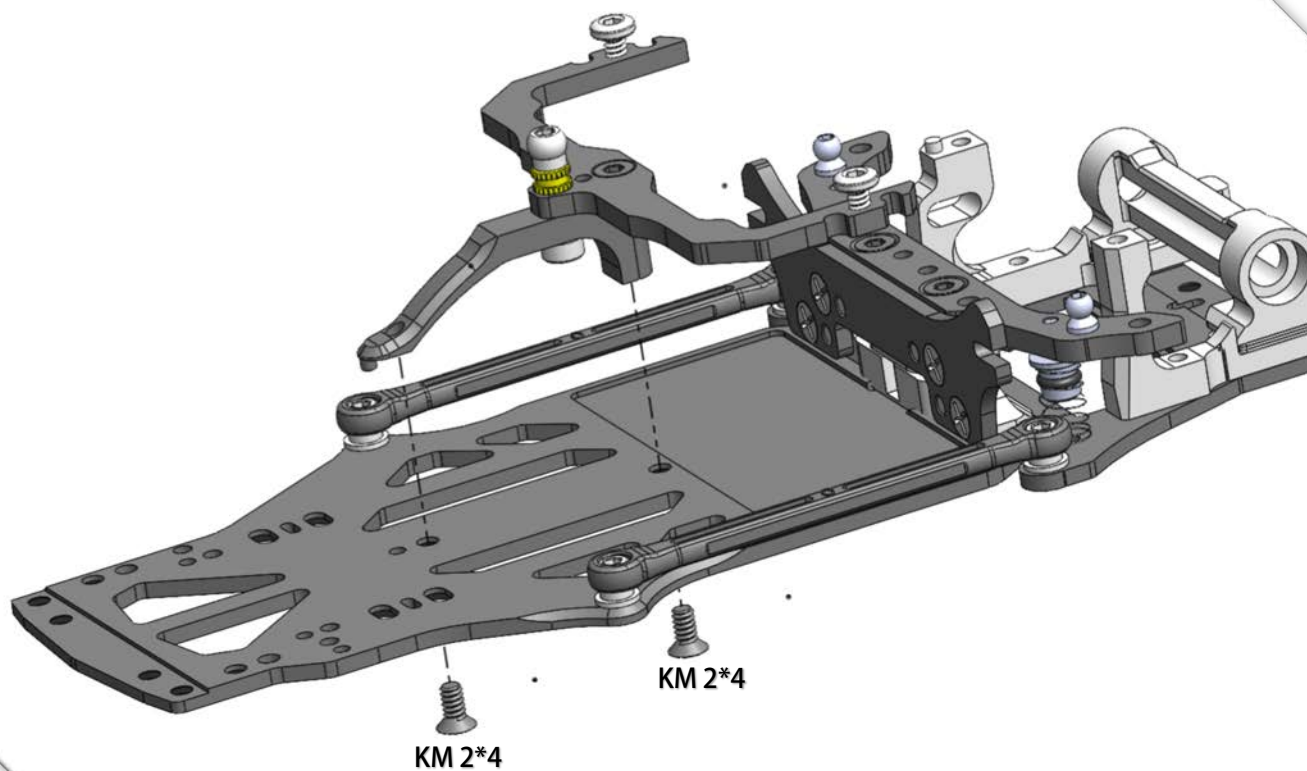

17 Lateral Shock Dampers (Bag 07)

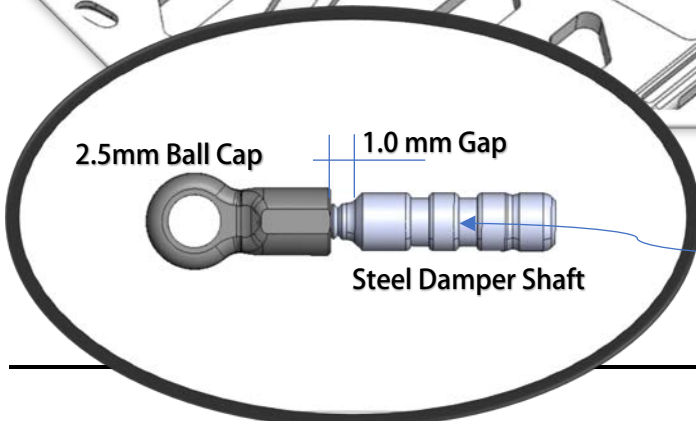
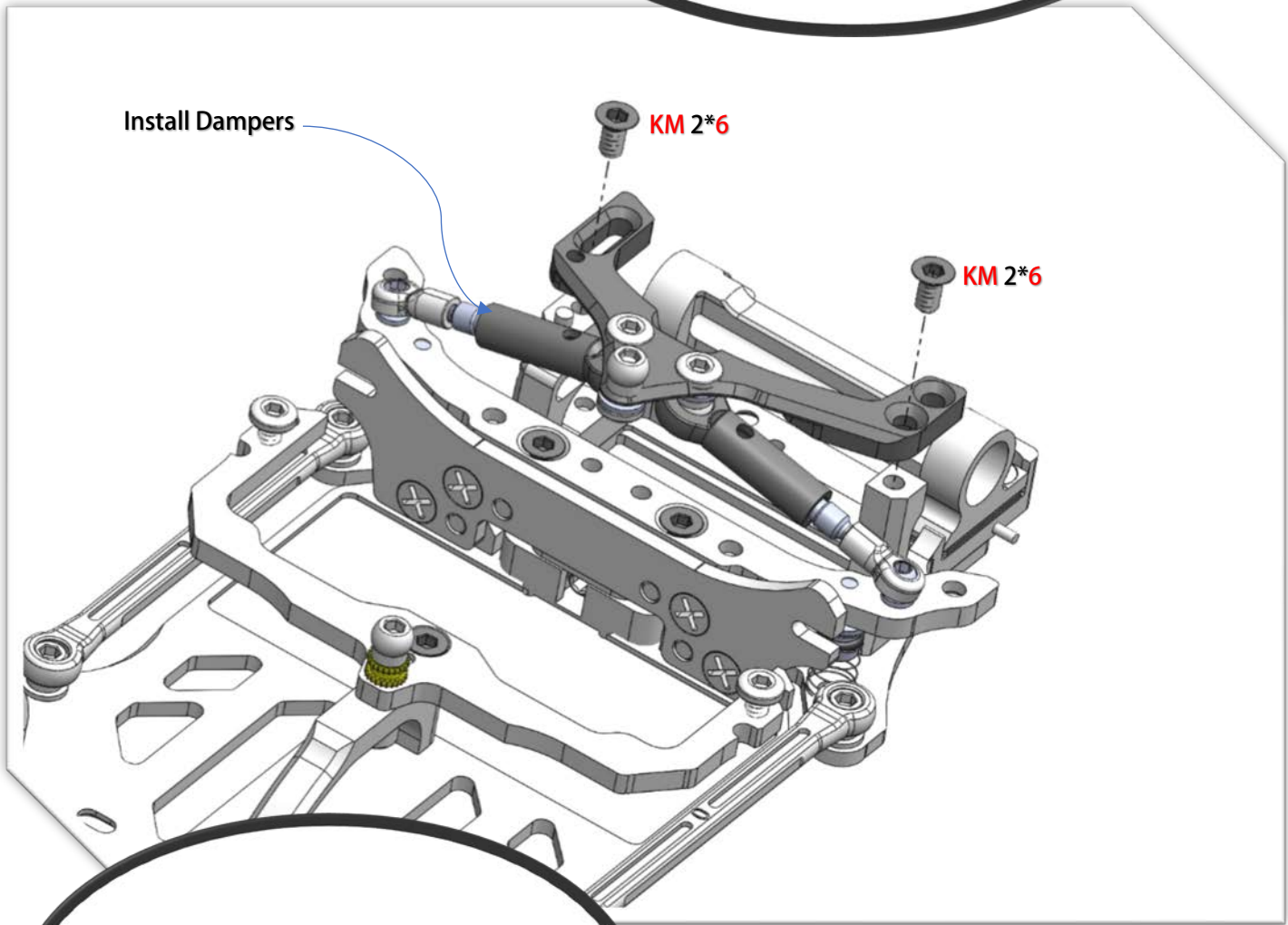
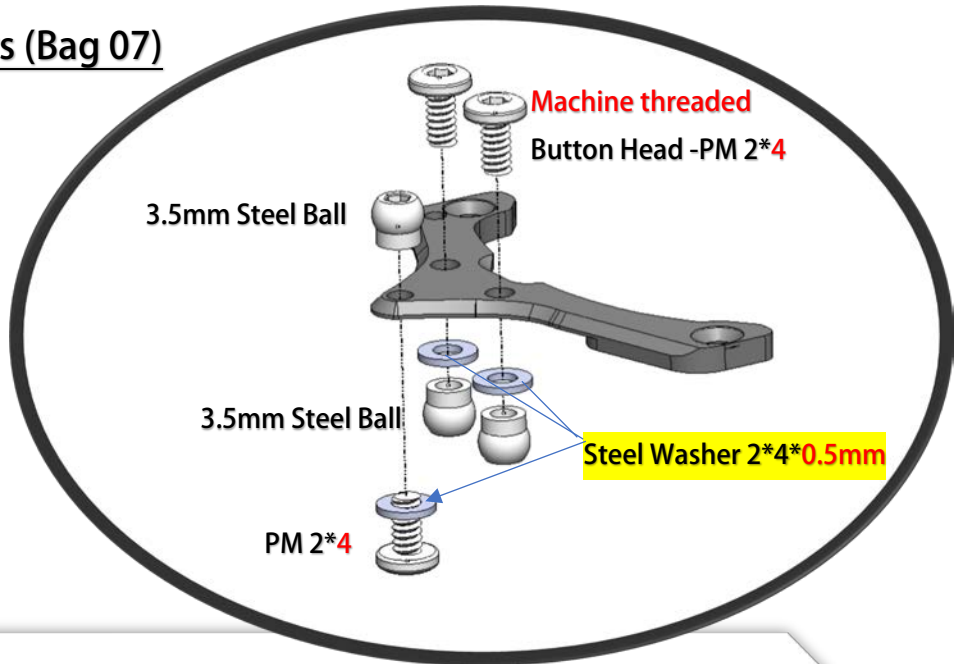

Apply #25000 or 35000 damper grease to the shaft.

18 Center Shock Damper

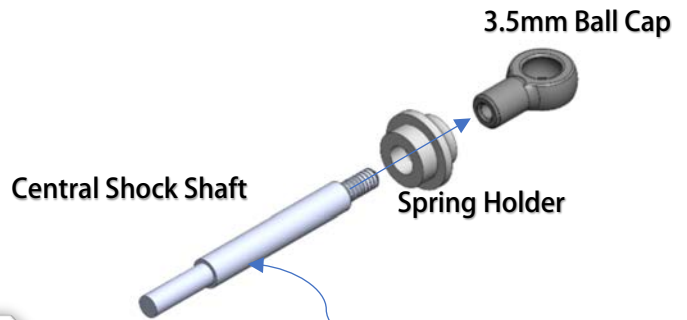
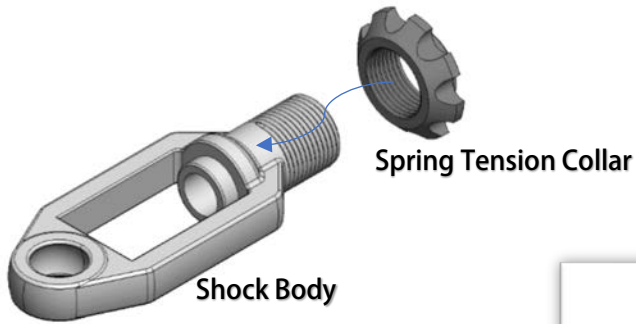

Apply #25000 or 35000 damper grease to the shaft.

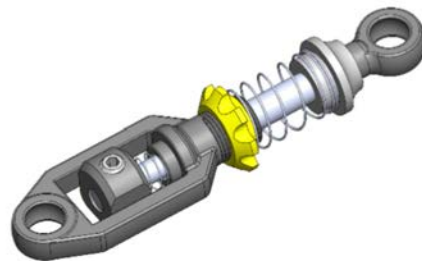
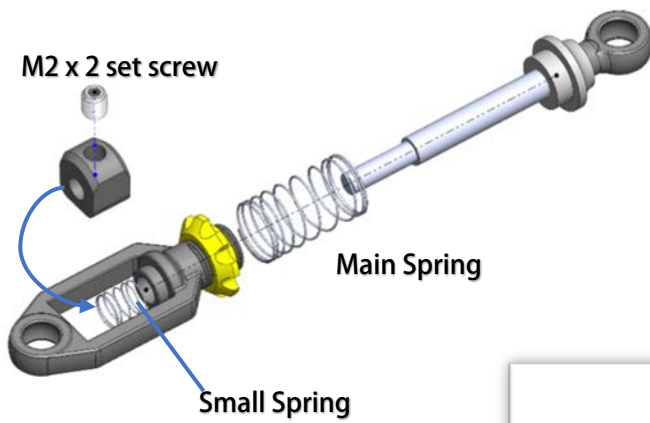

19 Center Shock Damper

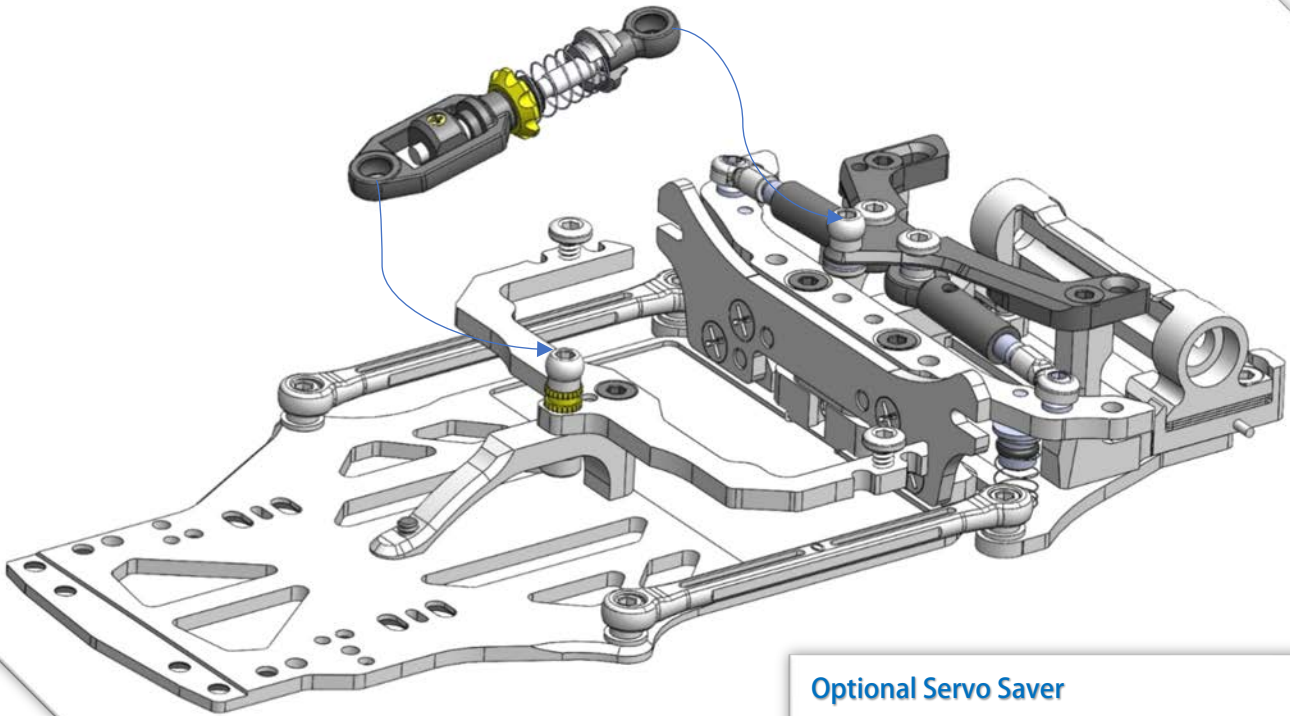

Optional Servo Saver
MRZ-UP01-V2

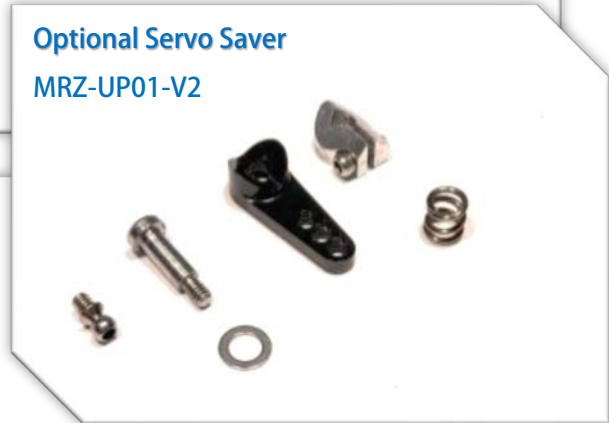

20 Servo Horn

Servo (not included)

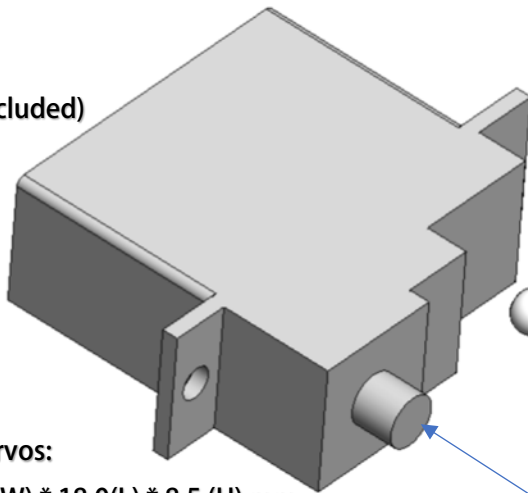

MRZ suitable servos:
size within 20.0(W) * 18.0(L) * 8.5 (H) mm

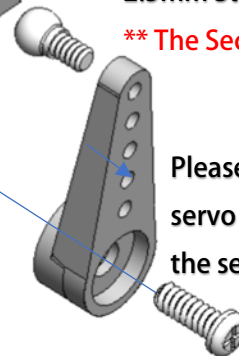

2.5mm Steel Ball Head, M1.4 thread

**** The Second Red Hole is recommended.**

Please use the screw and servo horn that come with the servo.

21 Servo Installation (open Bag 09)

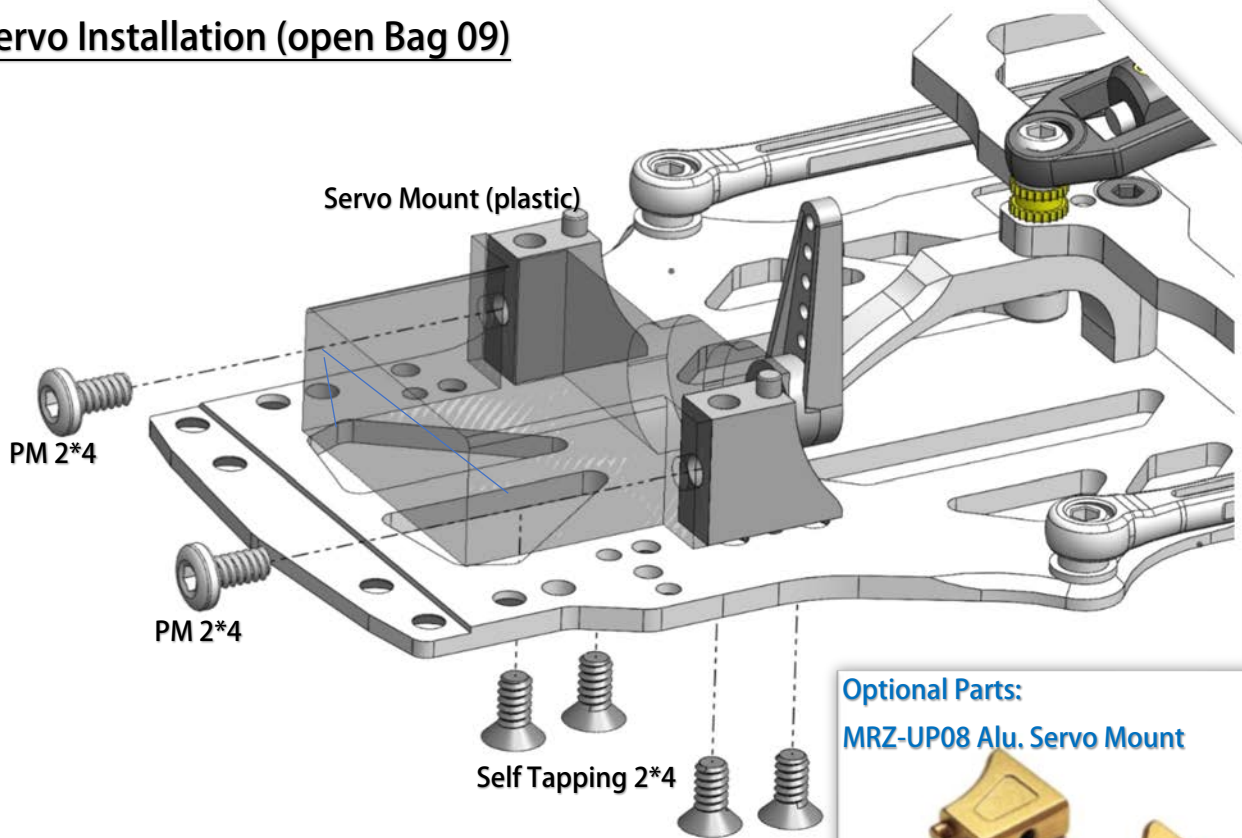

22 Front Bulkhead (open Bag 10)

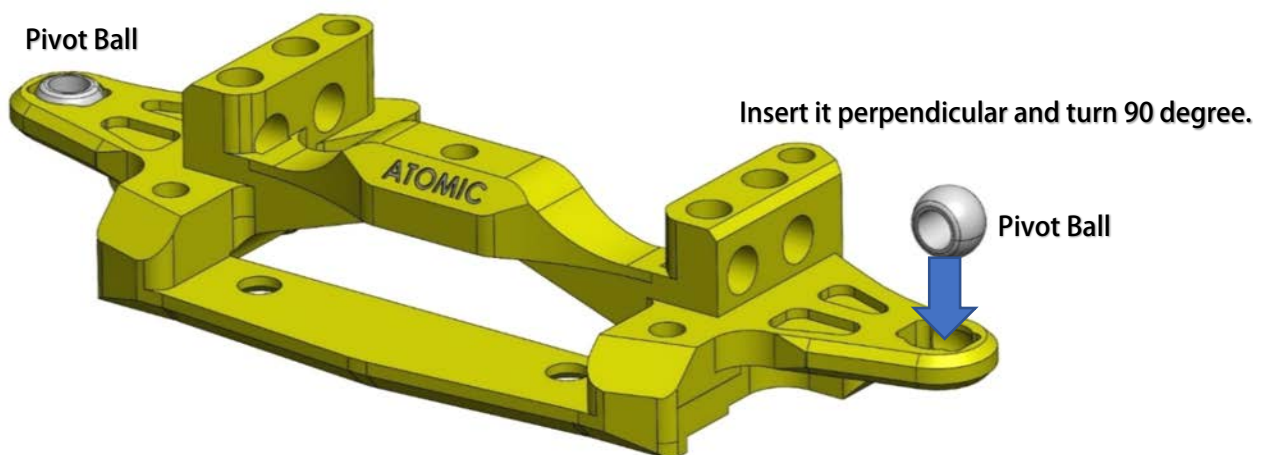

23 Knuckle Holder

Pivot Ball

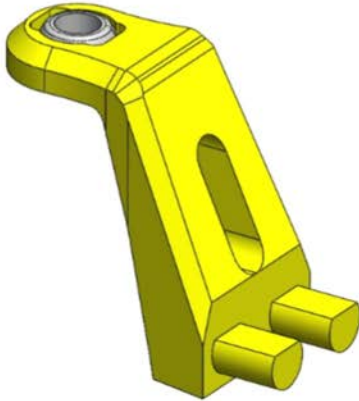

Insert it perpendicular and turn 90 degree.

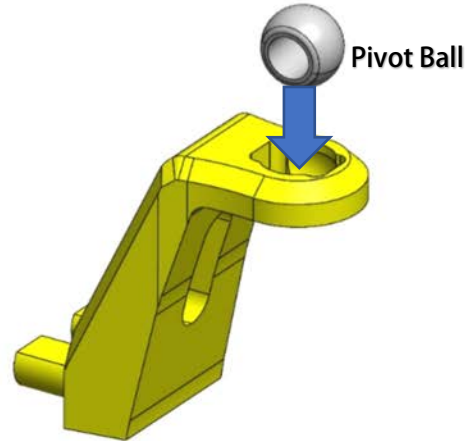

24 King Pin and Knuckle

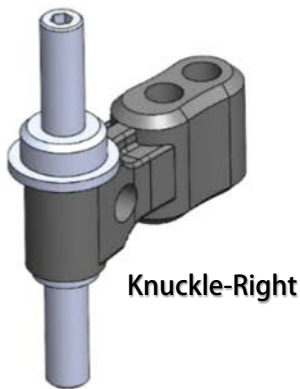

Knuckle-Right

Use 0.9mm Hex Key Tool

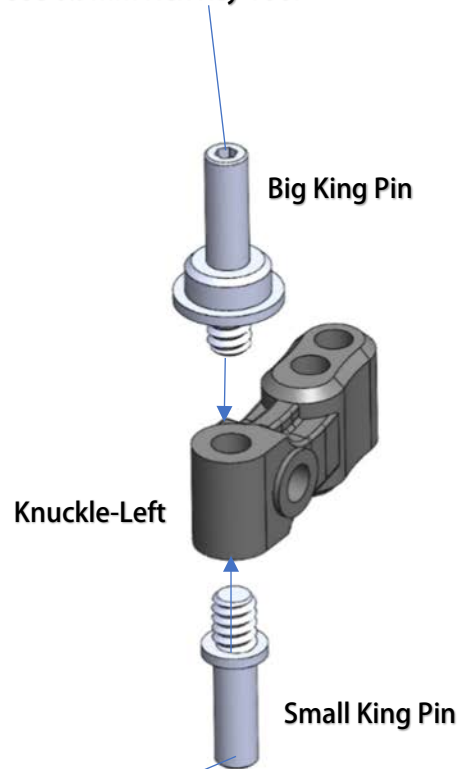

Big King Pin

Knuckle-Left

Small King Pin

Optional Part:
MRZ-UP09 Alu. Knuckle



25 Spring and Spacer

Shims used to setup the ride height and droop:

for front tire around 23mm diameter, 2 pcs 0.3 shim on top and bottom is good starting setup.

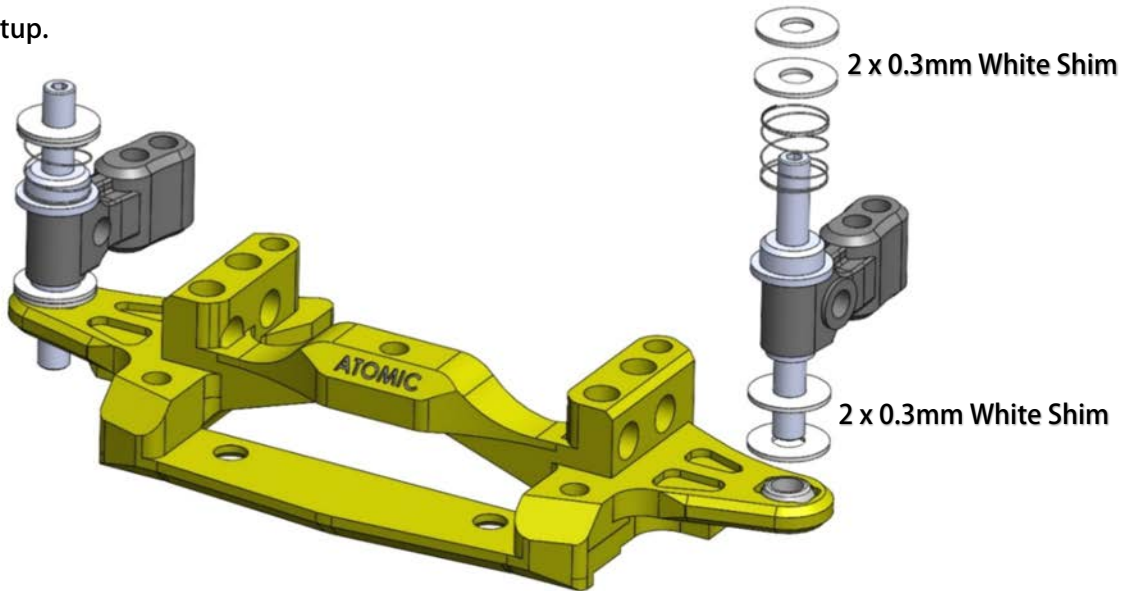

26 Camber Shim

Caution:

If you tighten the set screw down too hard, it may damage the aluminum posts. Some wear is expected as the edge takes hold.

They need to be tight, but excessive tightness is not needed. Please don't "Hulk" out on the set screw.

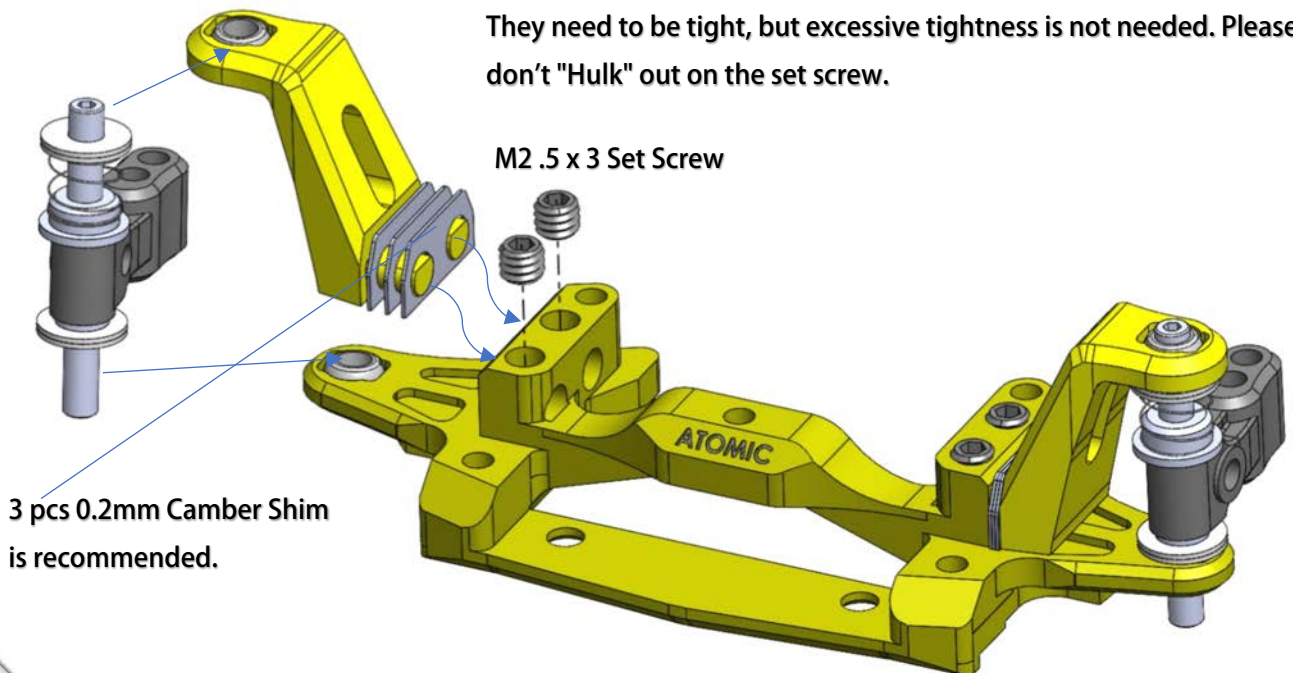

27 Camber Angle Adjustment

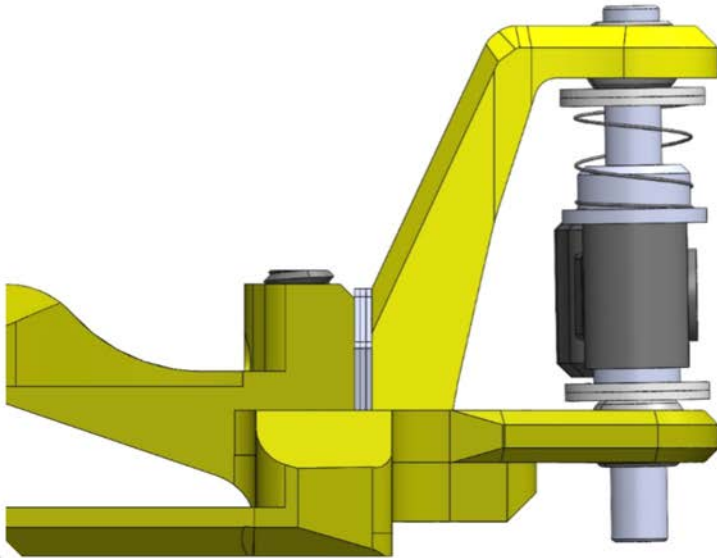

Camber Shims for Camber Angle Adjustment:

- 4 x 0.2mm shim = 0 degree
- 3 x 0.2mm shim = 1 degree
- 2 x 0.2mm shim = 2 degree
- 1 x 0.2mm shim = 3 degree

Generally, more camber will result in more steering, we recommend starting at 3 x 0.2mm shim.

28 Front Wheel Shaft

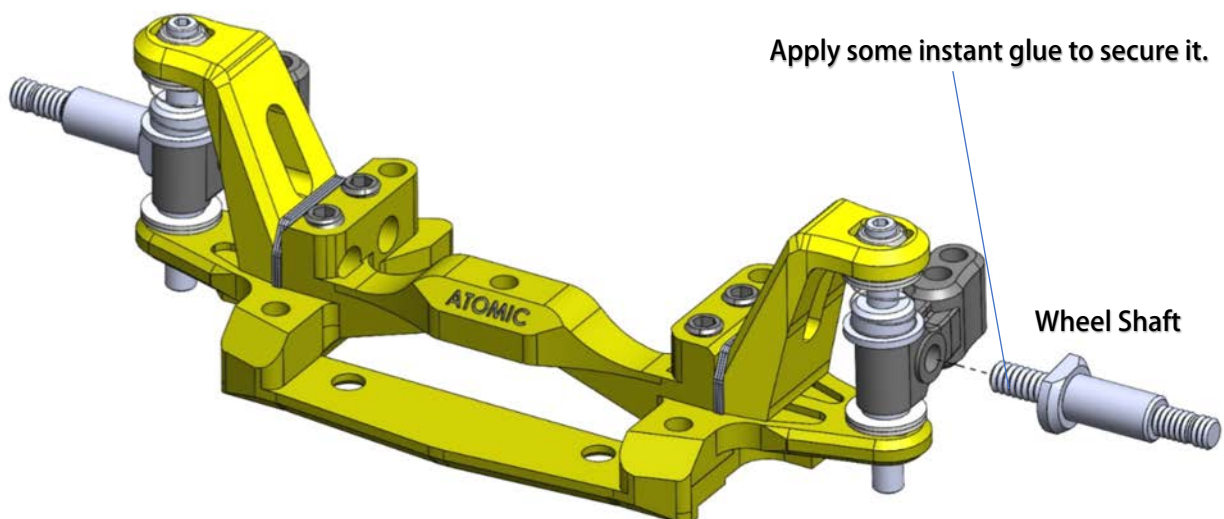

29 Steering Linkage

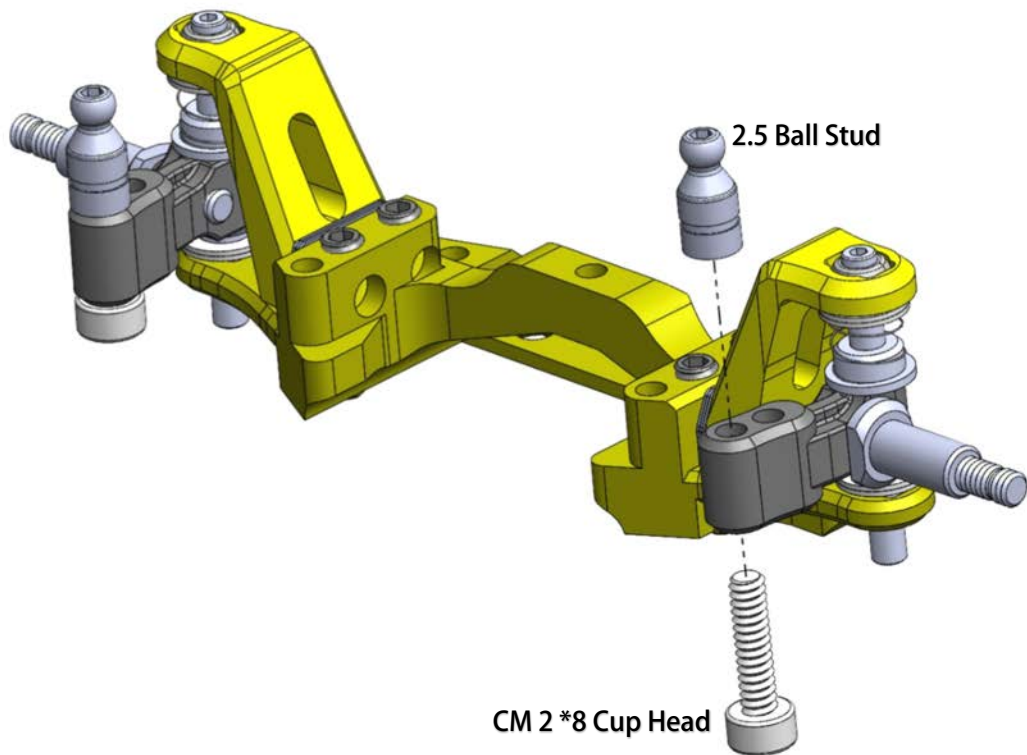

30 Front Bulkhead

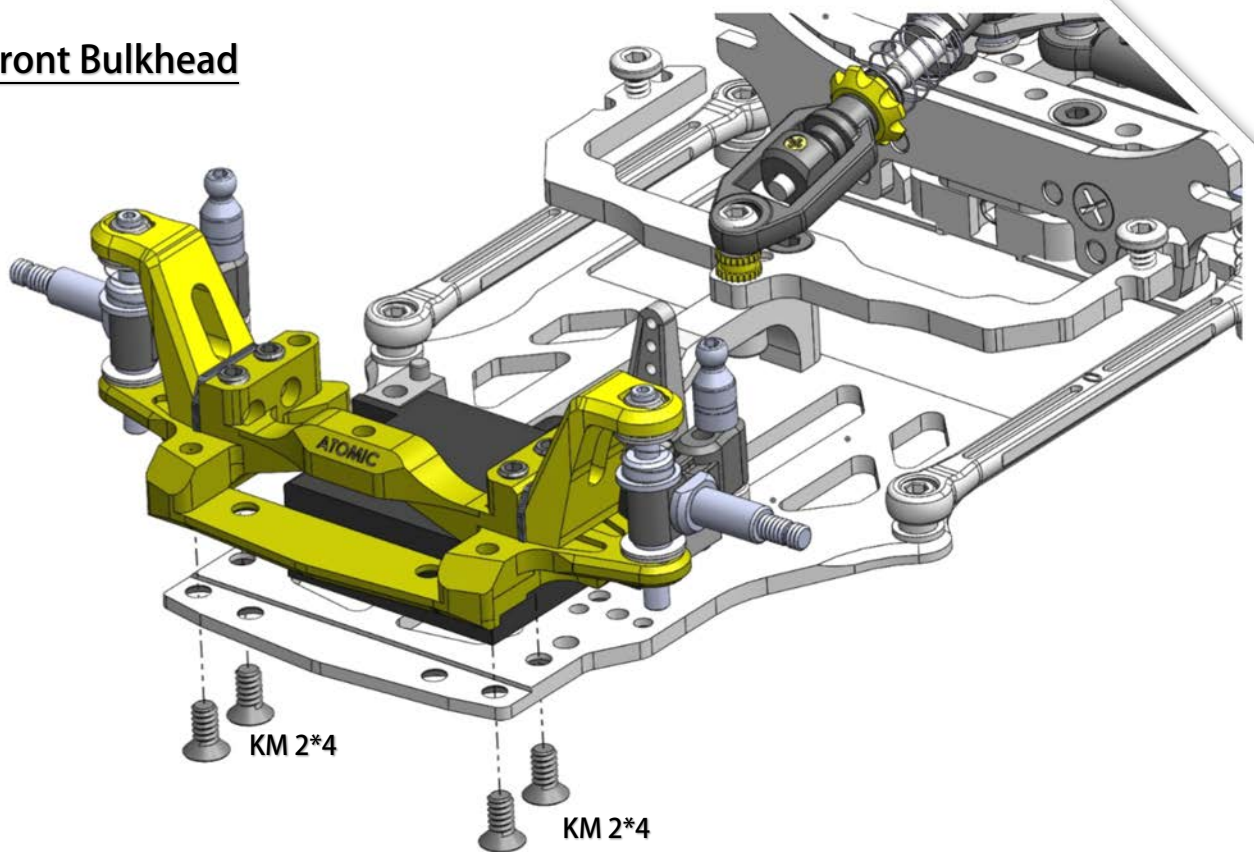

31 Steering System

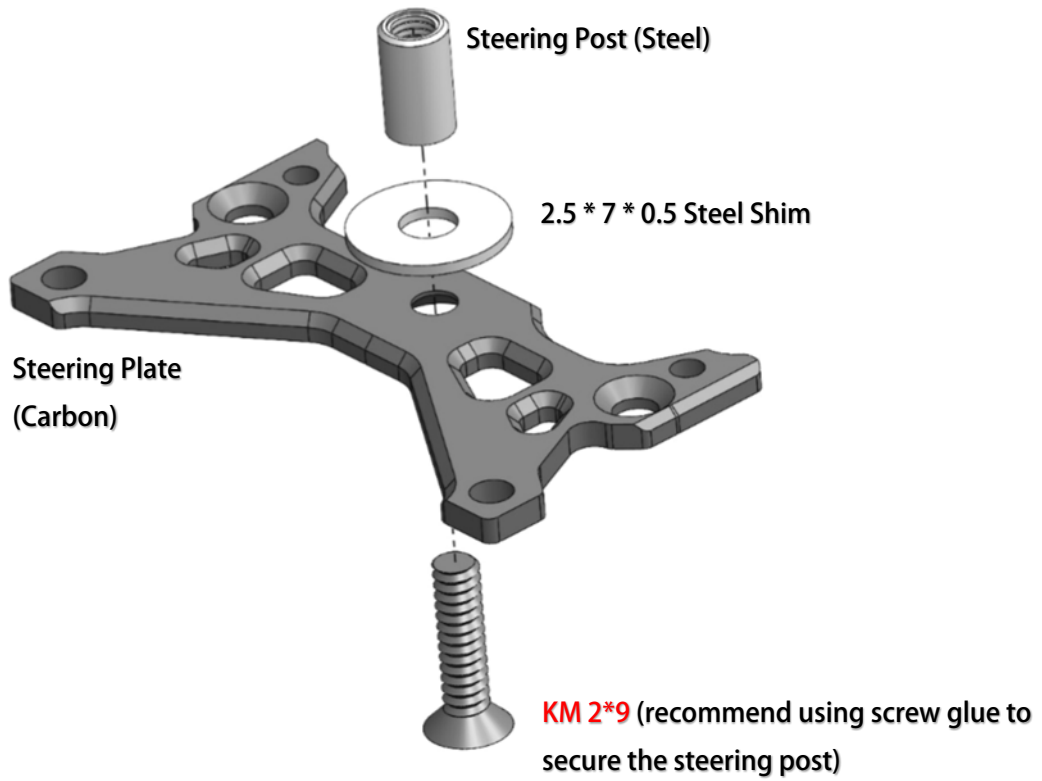

32 Steering Crank

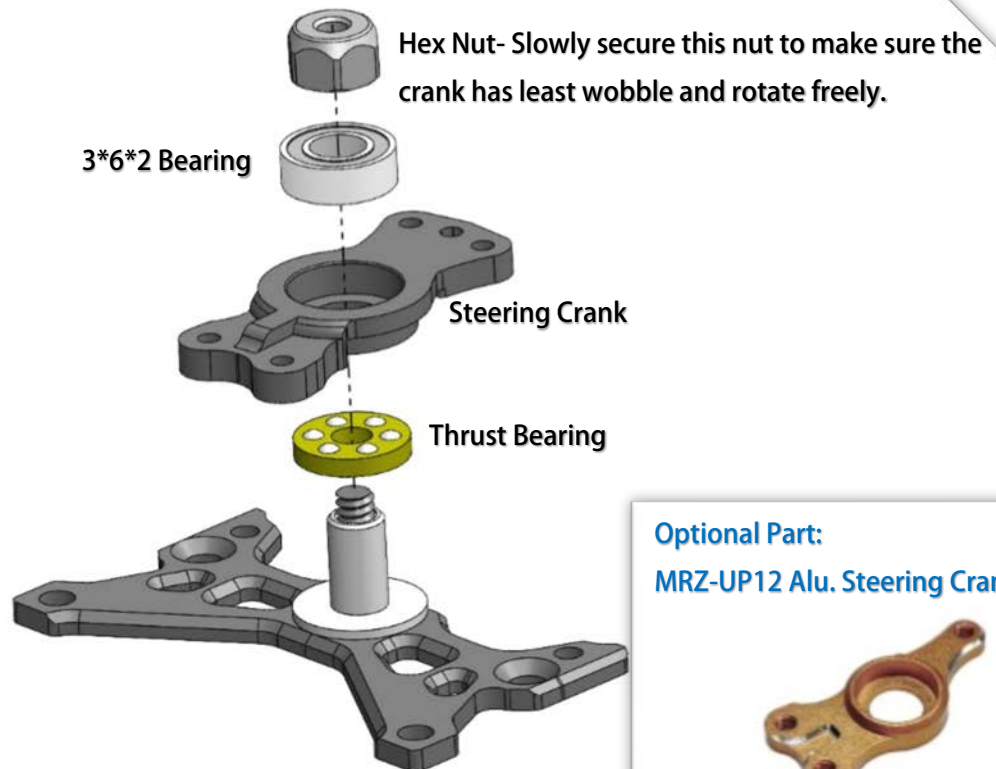

33 Steering Crank

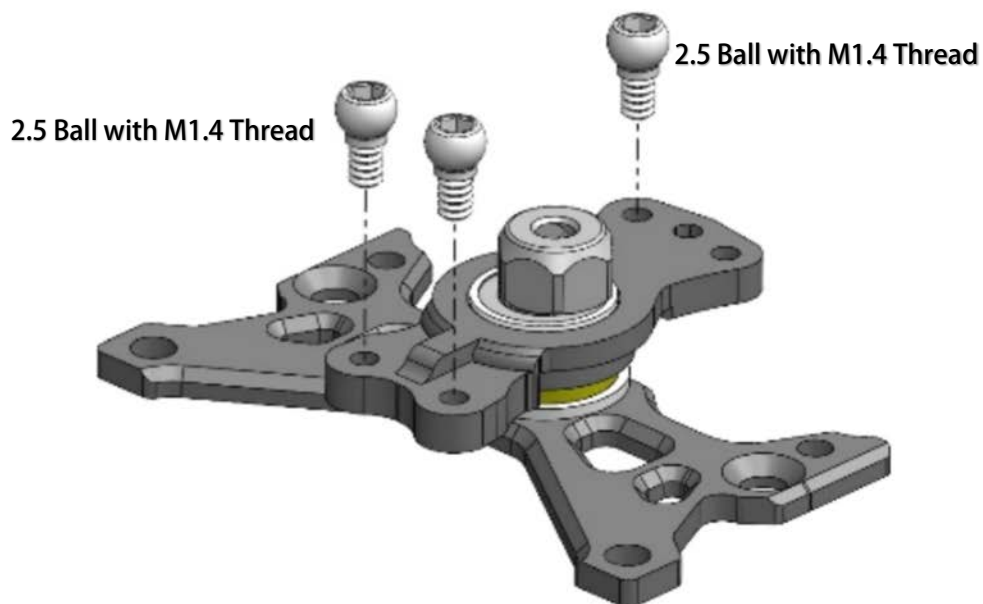

34 Fix Steering System to Chassis

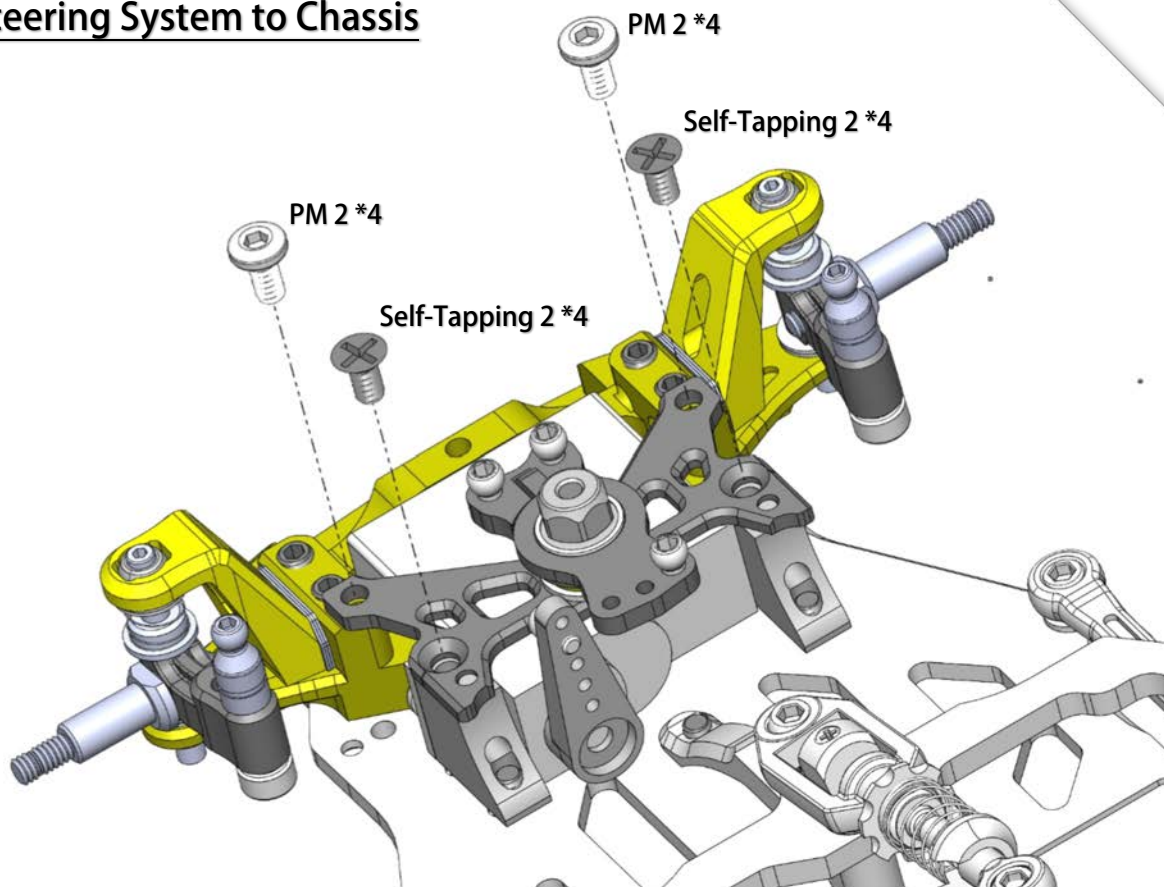

35 Steering Linkages

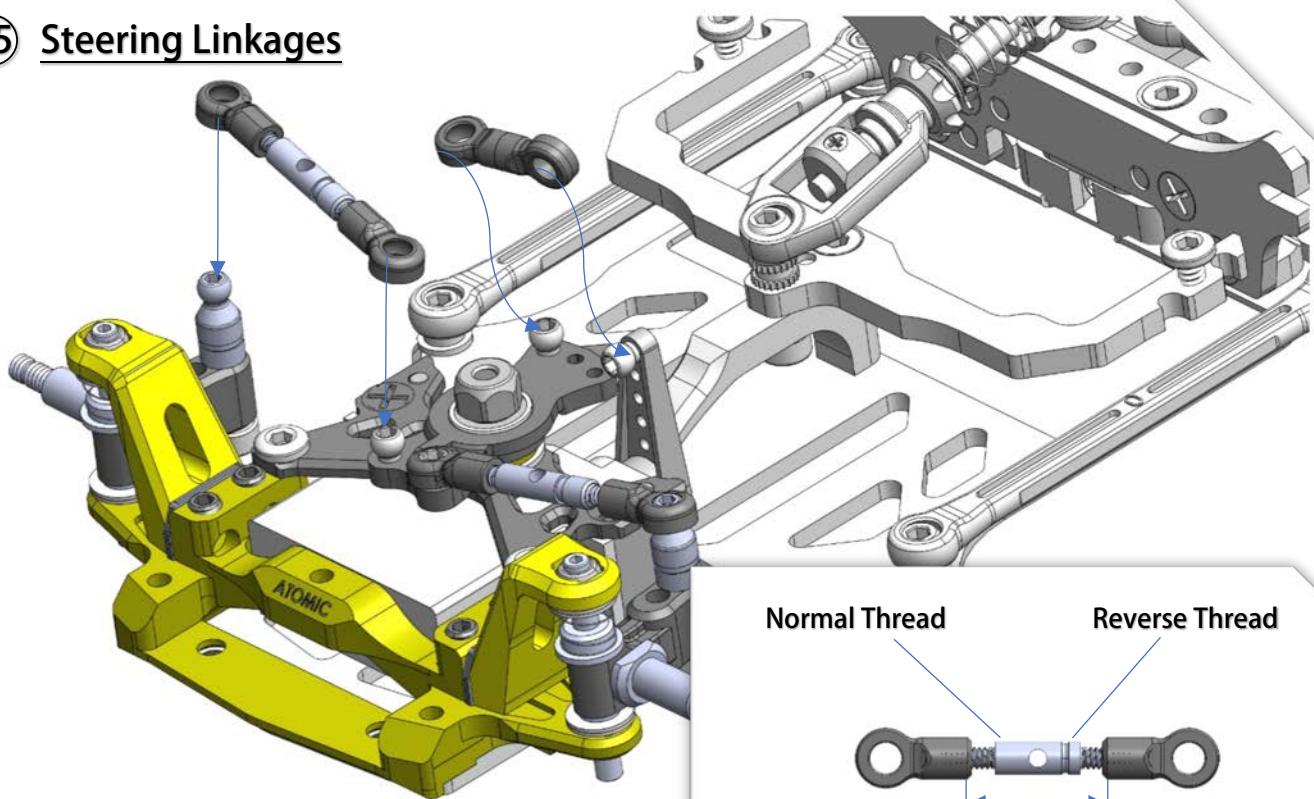

Normal Thread Reverse Thread

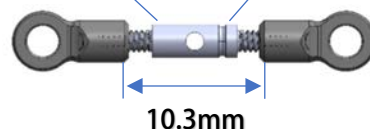

Turnbuckle and 2.5 Ball cap

36 Gear Differential (open Bag 11)

Right Wheel Hub (plastic)

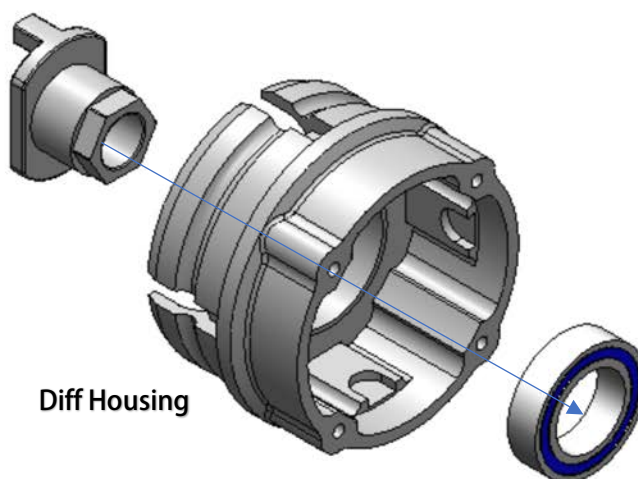

Diff Housing

5 x 8 x 2 Bearing

37 Gear Differential

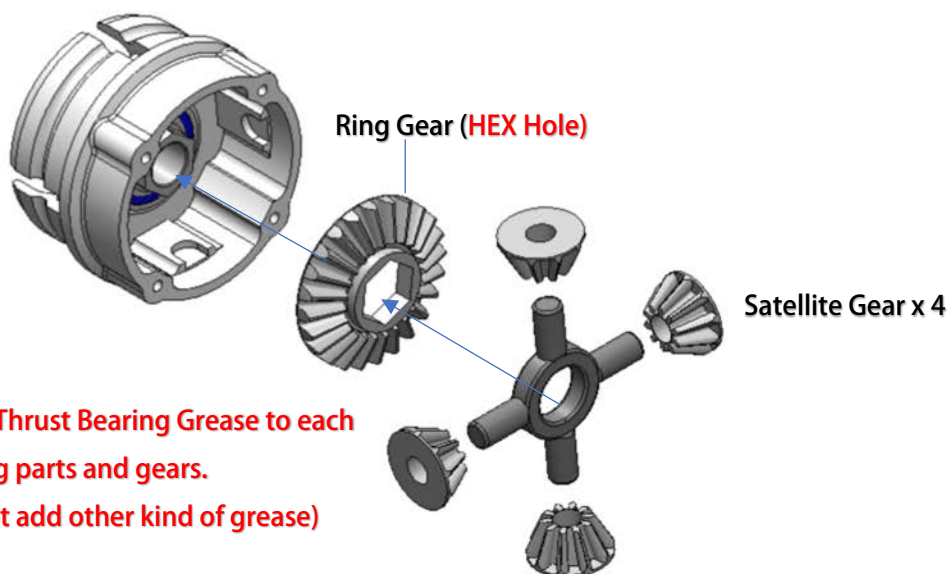

38 Gear Differential

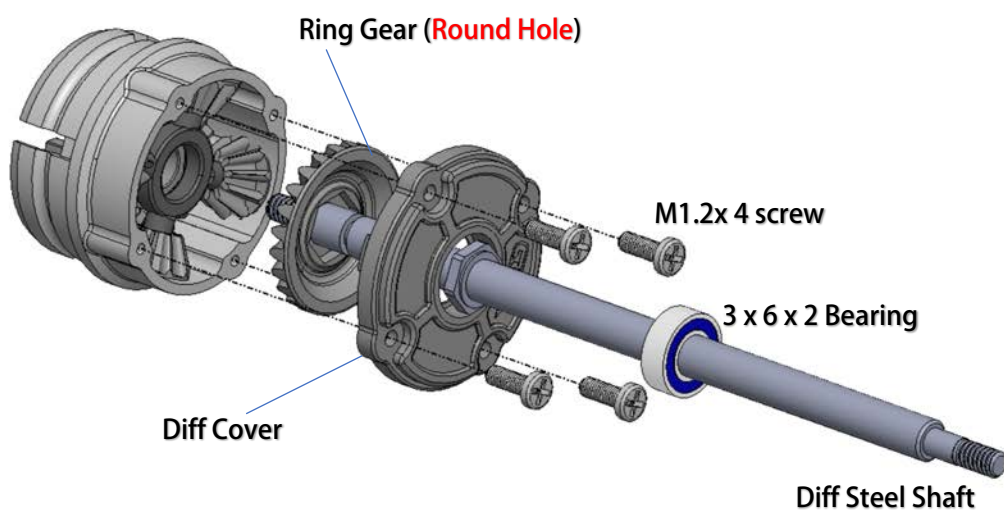

39 LSD Clutch

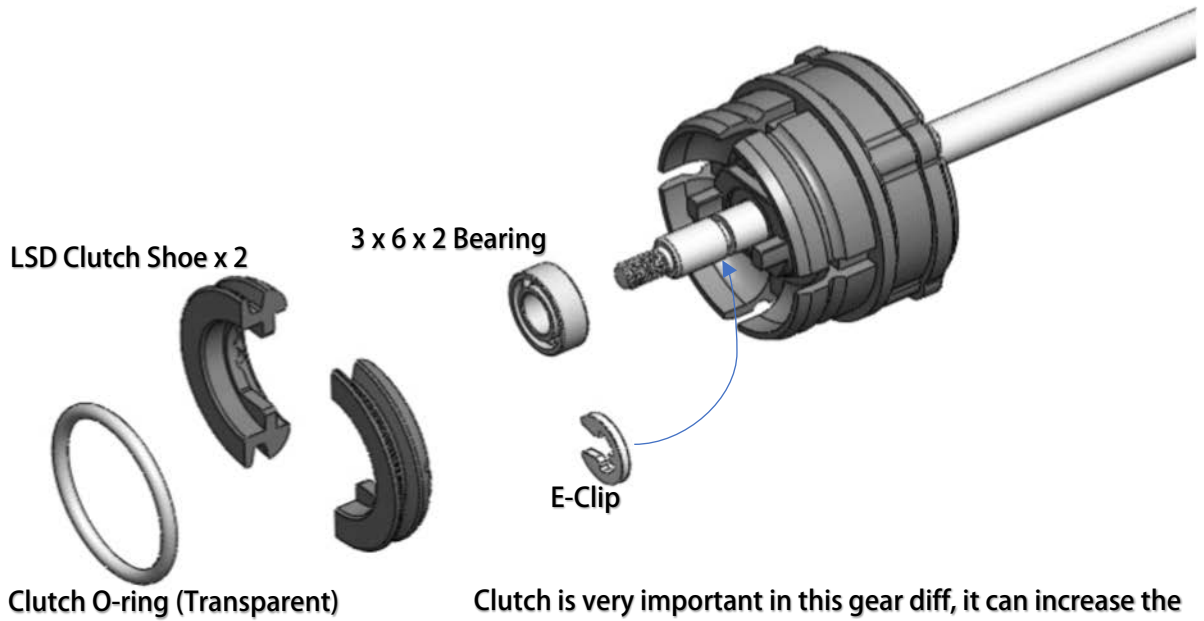

Clutch is very important in this gear diff, it can increase the friction of the diff system when the car accelerate and make the car more stable driving out of the corner.

37 Spur Gear

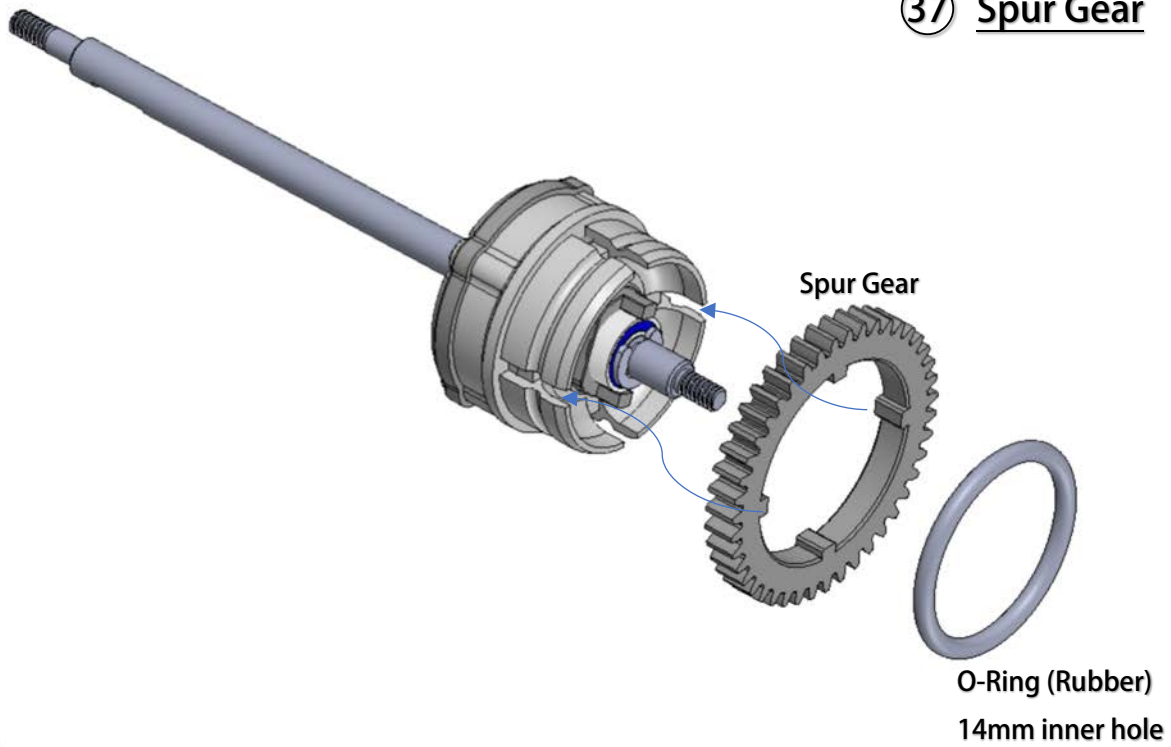

④① Install the Differential

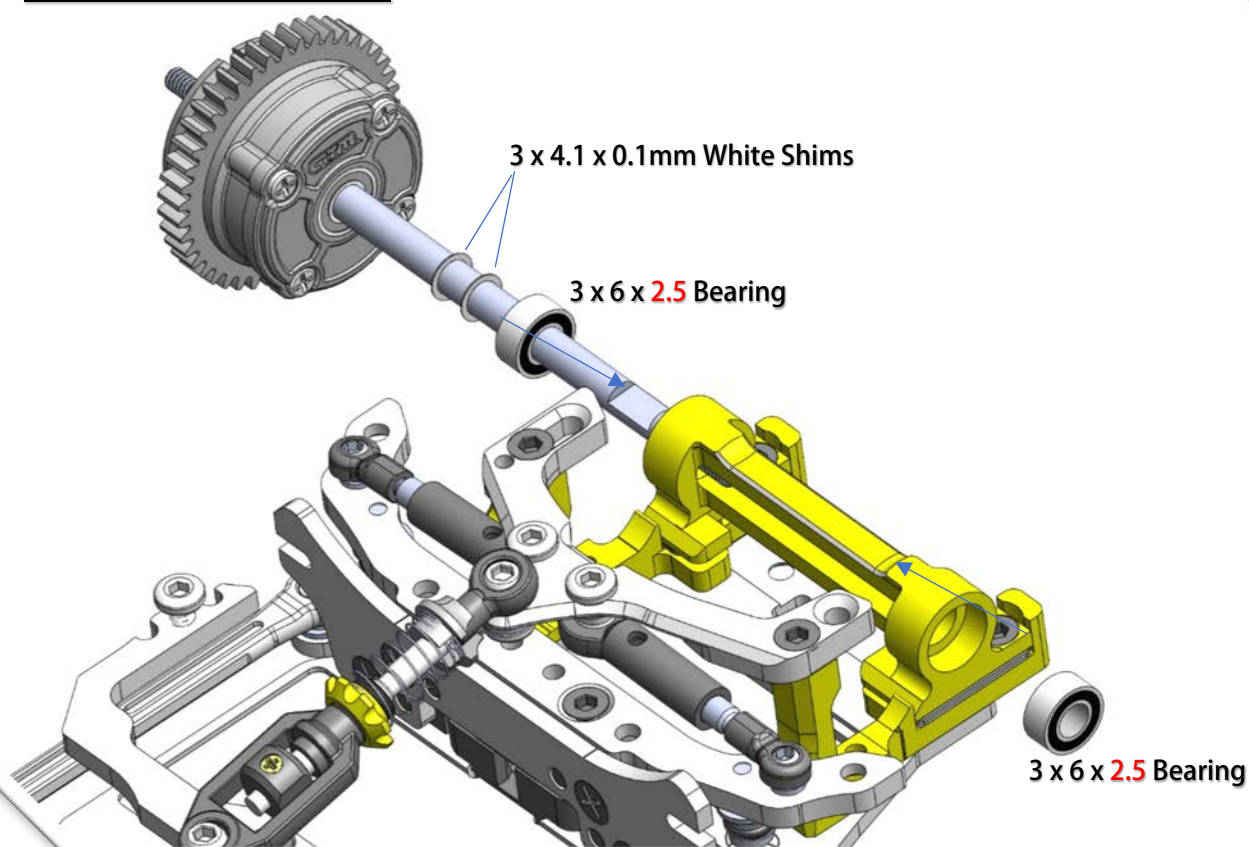

④② Wheel Adaptor

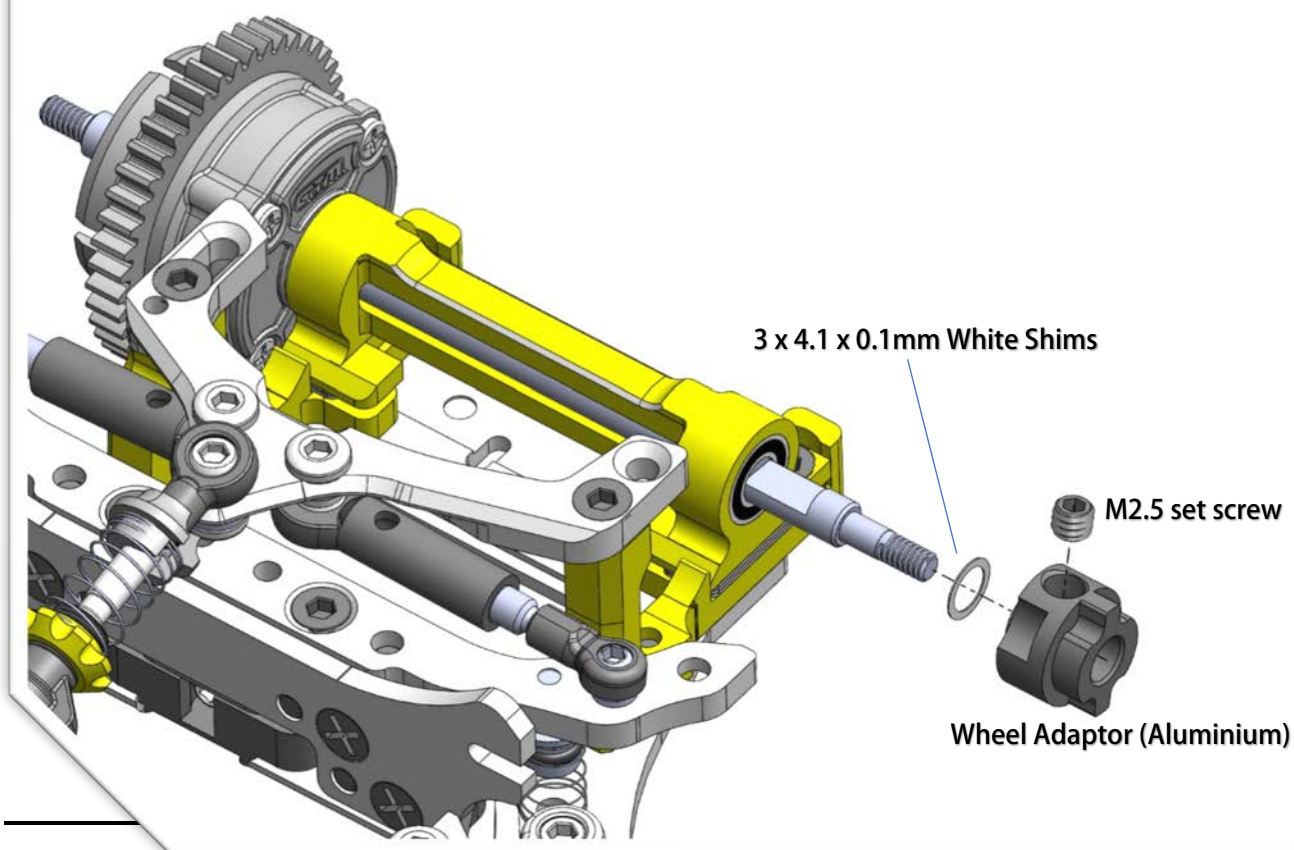

④2 Diffuser

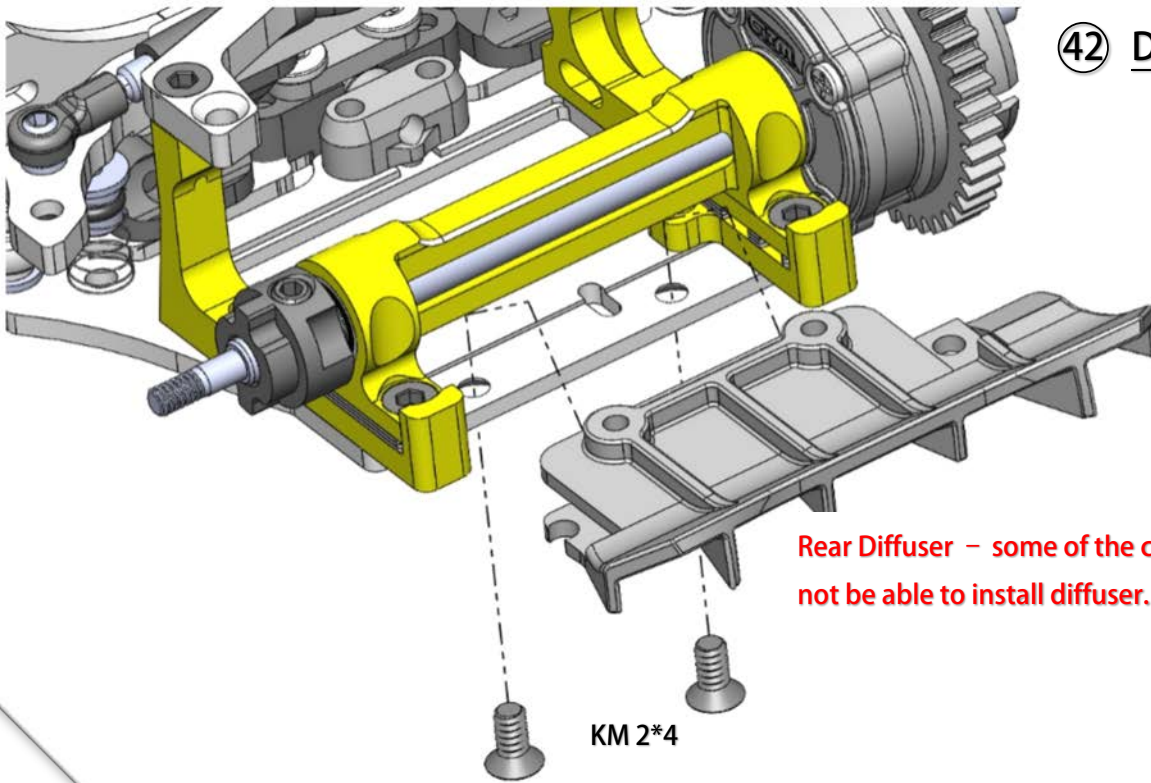

Rear Diffuser – some of the car body might not be able to install diffuser.

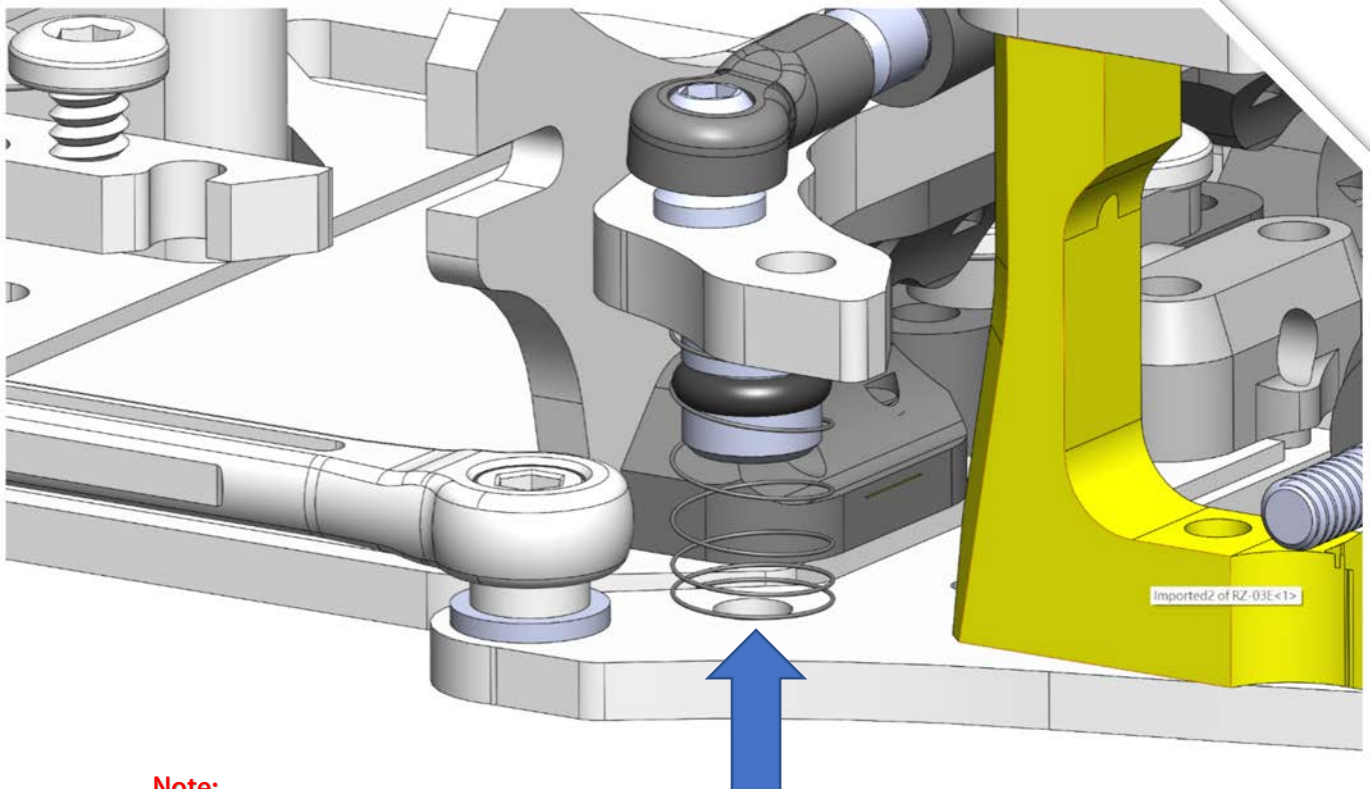

Note:

- Use 1.5 Hex Tool to adjust the side spring pressure thru the bottom hole of motor plate.
- Make sure the bottom of the spring just barely touches the motor plate. Excess spring force will make the rear of car loose grip.

Recommend using wheel:

Front N-0 offset wheel (=74mm width)

Rear W+2 offset wheel (=74mm width)

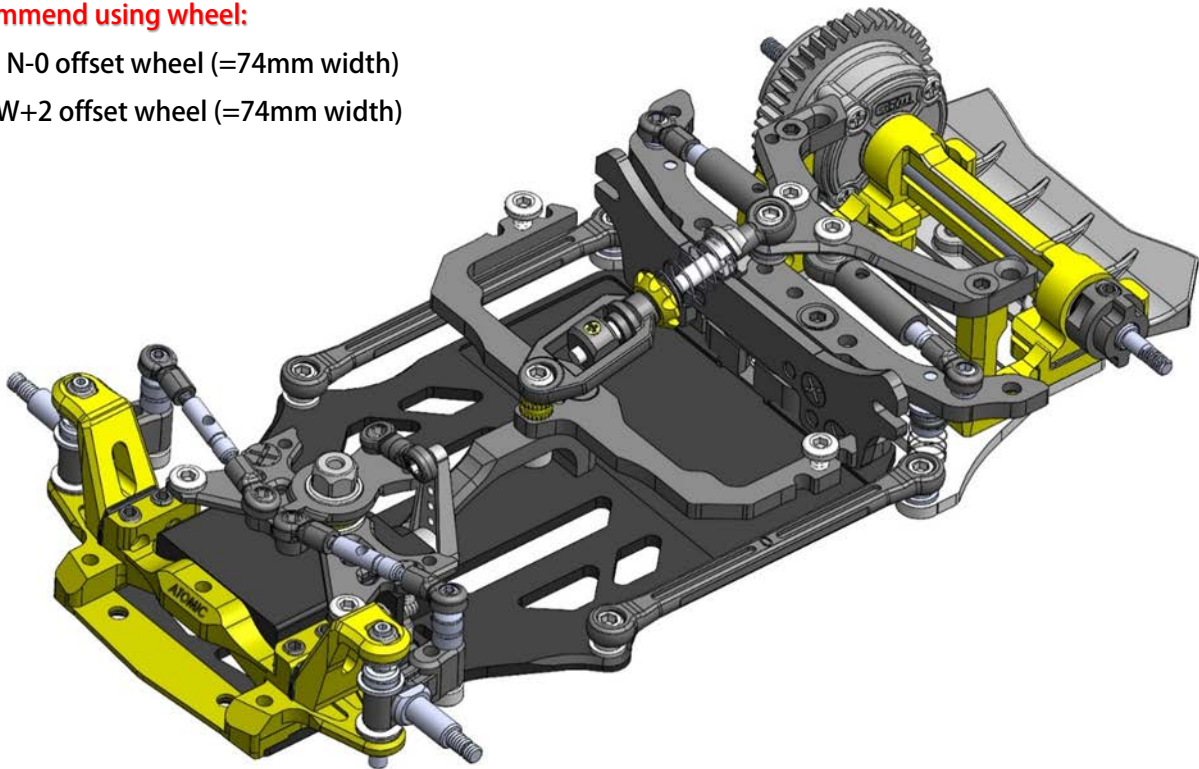

MRZ-UP04S	MRZ Mid Spring Soft (Red)
MRZ-UP04M	MRZ Mid Spring Medium (White)
MRZ-UP04H	MRZ Mid Spring Hard (Yellow)
MRZ-UP05	Spacer for Motor Pod (0.3mm) 6 pcs
MRZ-UP06	Spacer for Front Body Mount (0.5mm) 2 pcs
MRZ-UP07	MRZ Double A-Arm Conversion Kit
MRZ-UP07P1	DWS Spare Lower Arms w/ Pin
MRZ-UP07P2	DWS Optional Spring Set
MRZ-UP07P3	DWS Damper Shock
MRZ-UP08	MRZ Alu. Servo Mount
MRZ-UP09	MRZ Alu. Knuckle
MRZ-UP11	MRZ Alu. Central Mount
MRZ-UP12G	MRZ Alu. Steering Crank (Gold)
MRZ-UP12K	MRZ Alu. Steering Crank (Black)
MRZ-UP16	MRZ Ball Differential
MRZ-UP21	MRZ Light weight Mid Damper Shaft
MRZ-UP22	MRZ Rear Body Post
MRZ-UP24-10	Hard Coated 64DP Pinion 10T (MRZ)
MRZ-UP24-11	Hard Coated 64DP Pinion 11T (MRZ)

MRZ SF Instruction Manual

MRZ-UP24-12	Hard Coated 64DP Pinion 12T (MRZ)
MRZ-UP24-13	Hard Coated 64DP Pinion 13T (MRZ)
MRZ-UP24-14	Hard Coated 64DP Pinion 14T (MRZ)
MRZ-UP24-CB	Hard Coated 64DP Pinion Set 10-14T (MRZ)
MRZ-UP29	MRZ Aluminium Chassis Set
MRZSF-02S	MRZ SF Side Spring (Soft-Red)
MRZSF-02M	MRZ SF Side Spring (Medium-Black)
MRZSF-02H	MRZ SF Side Spring (Hard-Silver)
MRZSF-02-01	MRZ SF Side Spring O-ring (4 pcs)
MRZSF-02-02	MRZ SF Side Spring Hub (2pcs)
MRZSF-02-03	MRZ SF Long Side Damper Base Plate
MRZSF-03	MRZ SF Front Pivot Ball (2 pcs)
MRZSF-04	MRZ SF Knuckle King Pin (1 set)
MRZSF-05	MRZ SF Knuckle Teflon Shim 2*5*0.30 mm (10 pcs)
MRZSF-06	MRZ SF Knuckle Teflon Shim 2*5*0.15 mm (10 pcs)
MRZSF-07	MRZ SF Camber Shim 0.2mm (10 Pcs)
MRZSF-08S	MRZ SF Front Spring (Soft-Red)
MRZSF-08M	MRZ SF Front Spring (Medium-Black)
MRZSF-08H	MRZ SF Front Spring (Hard-Silver)